



07743-0379

**CLICK SYSTEM**

# 2024 MUSTANG GT (2 in 1)

Beiliegenden Sicherheitstext beachten / Please note the enclosed safety advice

- Ⓔ Beiliegenden Sicherheitstext beachten und nachschlagbereit halten.
- Ⓕ Please note the enclosed safety advice and keep safe for later reference.
- Ⓕ Respecter les consignes de sécurité ci-jointes et les conserver à portée de main.
- Ⓝ Houdt u aan de bijgaande veiligheidsinstructies en hou deze steeds bij de hand.
- Ⓣ Seguire le avvertenze di sicurezza allegate e tenerle a portata di mano.
- Ⓔ Observar y siempre tener a disposición este texto de seguridad adjunto.
- Ⓣ Ter em atenção o texto de segurança anexo e guardá-lo para consulta.

- Ⓝ Overhold vedlagte sikkerhedsanvisninger og hav dem liggende i nærheden.
- Ⓝ Ha alltid vedlagt sikkerhetstekst klar til bruk.
- Ⓔ Beakta bifogad säkerhetstext och håll den i beredskap.
- Ⓕ Huomioi ja säilytä oheiset varoitukset.
- Ⓝ Соблюдать технику безопасности, сохранить инструкцию для дальнейших обращений.
- Ⓕ Przestrzegać załączonego tekstu dotyczącego bezpieczeństwa i mieć go zawsze pod ręką.
- Ⓔ Dodržujte tento příložený bezpečnostní text a mějte ho po ruce.
- Ⓕ A mellékelt biztonsági szöveget vegye figyelembe és tartsa fellelőzásra készen.

- Ⓝ Respektujte priložený bezpečnostný text a uchovajte ho pre budúce použitie.
- Ⓕ Respectați textul de siguranță atașat și păstrați-l la îndemână.
- Ⓕ Спазвайте приложения текст за безопасност и го дръжте под ръка за справки.
- Ⓕ Prilolena varnostna navodila izvajajte in jih hranite na vsem dostopnem mestu.
- Ⓕ Λάβετε υπόψη σας το συννημένο κείμενο ασφαλείας και φυλάξτε το ώστε να ανατρέχετε σε αυτό όποτε χρειάζεται.
- Ⓕ Ektekigüvenlik talimatlarını dikkate alıp, bakabileceğiniz bir şekilde muafaza ediniz.

© 2025 Carrera Revell Europe GmbH, Henschelstr. 20-30, D-32257 Bünde.

REVELL IS THE REGISTERED TRADEMARK OF REVELL GMBH, GERMANY. [www.revell.de](http://www.revell.de)



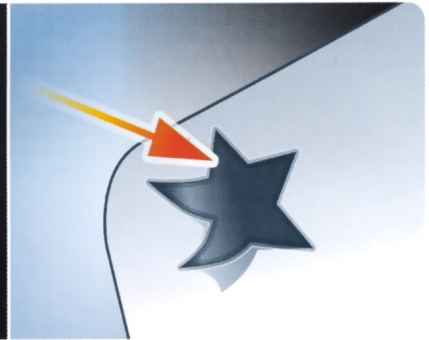
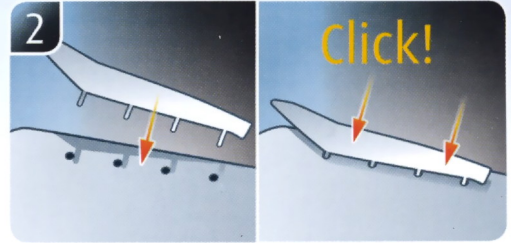
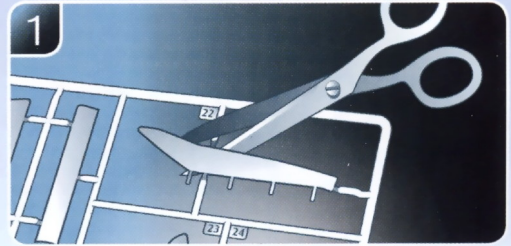
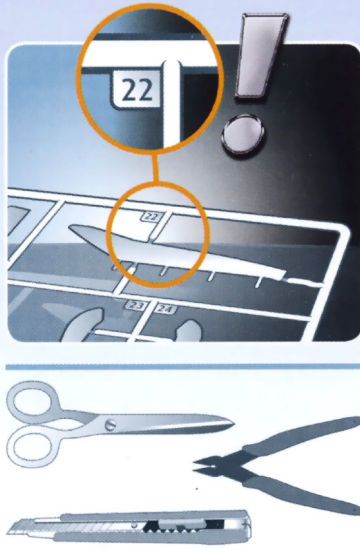

OPTIONAL · OPTIONAL · EN OPTION  
OPTIONEEL · OPCIONAL · OPTIONAL \*

## Decals

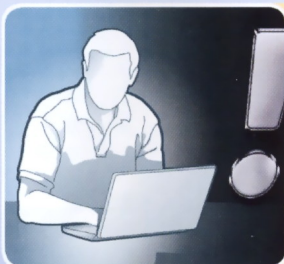
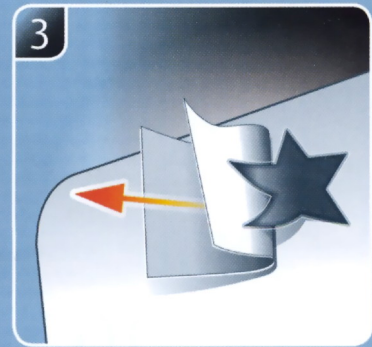
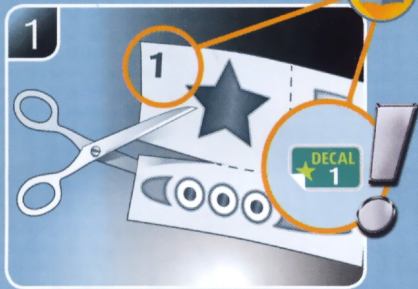

DE Weitere Tipps und Tricks.  
 DE Additional tips and tricks.  
 FR Conseils et astuces supplémentaires.  
 NL Andere tips en trucs.  
 IT Ulteriori consigli e suggerimenti.  
 ES Consejos y sugerencias adicionales.  
 PT Mais dicas e truques.  
 DK Flere tips og tricks.  
 NO Flere tips og tricks.  
 SE Ytterligare tips och tricks.  
 FI Lisää vinkkejä ja niksejä.  
 RU Другие советы и хитрости.

PL Dalsze wskazówki i sugestie.  
 CZ Další tipy a rady.  
 HU További ötletek és fogások.  
 SK Ďalšie tipy a triky.  
 RO Alte sfaturi și trucuri.  
 BG Други полезни съвети и трикове.  
 SI Nadaljnji nasveti in zvijače.  
 GR Πρόσθετες συμβουλές και κόλπα.  
 TR Diğer öneriler ve ipuçları.

[www.revell.de](http://www.revell.de)

\* PT Opcional  
 DK Valgfrit  
 NO Valgfritt  
 SE Övrigt  
 FI Valinnainen  
 RU Дополнительно  
 PL Opcja  
 CZ Volitelný krok

HU Opcióként  
 SK Voliteľné  
 RO Opțional  
 BG Опция  
 SI Dodatno  
 GR Προαιρετικά  
 TR Opsiyonel



- DE Anzahl der Arbeitsgänge.
- EN Number of working steps.
- FR Nombre d'étapes de travail.
- NL Het aantal bouwstappen.
- IT Numero di fasi di lavoro.
- ES Número de pasos de trabajo.
- PT Número de passos de trabalho.
- DK Antal arbejds-gange.
- NO Antall arbeidstrinn.
- SE Antal operationer.
- F Työvaiheiden määrä.
- RU Количество операций.
- PL Liczba cykli roboczych.
- CZ Počet pracovních kroků.
- HU A munkamenetek száma.
- SK Počet pracovných operácií.
- RO Numărul etapelor de lucru.
- GR Брой работни стъпки.
- SI Števílo delovnih postopkov.
- TR Αριθμός βημάτων εργασίας.
- TR Çalışma adımları sayısı.



- DE Wahlweise
- EN Optional
- FR Facultatif
- NL Naar keuze
- IT Facoltativamente
- ES Opcional
- PT Opcional
- DK Valgfri
- NO Valgfritt
- SE Valfri
- F Valinnaisesti
- RU На выбор
- PL Opcjonalnie
- CZ Volitelně
- HU Választás szerint
- SK Alternativne
- RO Opțional
- GR По избор
- SI Izbirno
- TR Προαιρετικά
- TR Opsiyonel



- DE Achtung
- EN Attention
- FR Attention
- NL Obgelet
- IT Attenzione
- ES Atención
- PT Atenção
- DK Obs!
- NO OBS
- SE OBS
- F Huomio
- RU Внимание
- PL Uwaga
- CZ Pozor!
- HU Figyelem!
- SK Pozor
- RO Atenție
- GR Внимание
- SI Pozor
- TR Προσοχή
- TR Dikkat



- DE Gleichen Vorgang auf der gegenüberliegenden Seite wiederholen.
- EN Repeat same procedure on opposite side.
- FR Opérer de la même façon sur l'autre face.
- NL Dezelfde handeling herhalen aan de tegenoverliggende kant.
- IT Ripetere il procedimento dall'altra parte.
- ES Repetir el mismo procedimiento en el lado contrario.
- PT Repetir alguns procedimentos no lado oposto.
- DK Gentag proceduren på den modstående side.
- NO Gjenta samme forløp på motliggende side.
- SE Upprepa samma process på motsatta sidan.
- F Toista menettely vastakkaisella puolella.
- RU Повторить такие же действия на противоположной стороне.
- PL Powtórzyć te same czynności po przeciwnej stronie.
- CZ Stejný postup opakujte na protilehlé straně.
- HU Ismétélje meg a műveletet az ellentétes oldalon.
- SK Rovnaký postup zopakujte na protilahlej strane.
- RO Repetați același procedeu pe latura opusă.
- GR Повторете същите стъпки на срещуположната страна.
- SI Enak postopek ponovite na nasprotni strani.
- TR Epanalafete την ίδια διαδικασία στην αντίθετη πλευρά.
- TR Aynı işlem adımı için diğer tarafta da uygulayın.



- DE Entfernen
- EN Remove
- FR Détacher
- NL Verwijderen
- IT Rimuovere
- ES Eliminar
- PT Remover
- DK Fjern
- NO Fjerne
- SE Ta bort
- F Poista
- RU Удалить
- PL Usunąć
- CZ Odstranit
- HU Eltávolítani
- SK Odstráňte
- RO îndepărtați
- GR Отстранете
- SI Odstranitev
- TR Αφαιρέστε
- TR Çıkar



- DE Bauanleitung sorgfältig lesen.
- EN Read the assembly instructions carefully.
- FR Lisez attentivement les instructions de montage.
- NL Bouwinstructies zorgvuldig doorlezen.
- IT Leggere attentamente le istruzioni per il montaggio.
- ES Lea cuidadosamente las instrucciones de montaje.
- PT Ler atentamente as instruções de montagem.
- DK Læs byggevejledningen omhyggeligt.
- NO Les byggeanvisningen nøye.
- SE Monteringsinstruktionerna skall läsas noggrant.
- F Lue kokoamisohje huolellisesti.
- RU Внимательно прочитайте инструкцию по сборке.
- PL Dokładnie przeczytać instrukcję montażu.
- CZ Přečtěte si pečlivě návod k obsluze.
- HU Figyelmesen olvassa el a szerelési útmutatót.
- SK Návod na montáž starostlivo prečítajte.
- RO Citiți cu atenție instrucțiunile de montare.
- GR Прочетете внимателно утъваното за монтаж.
- SI Skrbno preberite navodila za sestavo.
- TR Διαβάστε προσεκτικά τις οδηγίες κατασκευής.
- TR Yapı kılavuzunu dikkatle okuyun.



- DE Zusammenbau Reihenfolge.
- EN Sequence of assembly.
- FR Ordre d'assemblage.
- NL Volgorde van montage.
- IT Sequenza di assemblaggio.
- ES Secuencia de montaje.
- PT Sequência de montagem.
- DK Samlerækkefølge.
- NO Monteringsrekkefølge.
- SE Monteringsordningsföljd.
- F Kokoamisjärjestys.
- RU Последовательность сборки.
- PL Kolejność montażu.
- CZ Pořadí složení.
- HU Összerakási sorrend.
- SK Poradie zostavenia.
- RO Ordinea asamblării.
- GR Последовательност на сглобяване.
- SI Vrstni red sestavljanja.
- TR Sıra topaştırma.
- TR Parçaları birleştirme sırası.



- DE Pinzette benutzen.
- EN Use tweezers.
- FR Utiliser une pince à épiler.
- NL Pincet gebruiken.
- IT Utilizzare una pinzetta.
- ES Usar pinzas.
- PT Utilizar uma pinça.
- DK Brug pincet.
- NO Bruke pinsetter.
- SE Använd pincett.
- F Käytä pinsettejä.
- RU Пользуйтесь пинцетом.
- PL Użyć pesety.
- CZ Použijte pinzetu.
- HU Használjon csipeszt.
- SK Použite pinzetu.
- RO Utilizați penseta.
- GR Използвайте пинцета.
- SI Uporabite pinceto.
- TR Χρησιμοποιήστε τσιμπίδα.
- TR Cimbr kullanın.



- DE Abbildung zusammengesetzter Teile.
- EN Illustration of assembled parts.
- FR Figure représentant les pièces assemblées.
- NL Afbeelding van samengevoegde onderdelen.
- IT Foto delle parti assemblate.
- ES Figura de las piezas montadas.
- PT Ilustração das peças montadas.
- DK Illustration af samlede dele.
- NO Figur av sammensatte deler.
- F Bild på sammansatta detaljer.
- RU Изображение смонтированных деталей.
- PL Rysunek połączonych części.
- CZ Zobrazení spojených dílů.
- HU Összerakott alkatrészek ábrája.
- SK Obrázok dielov, ktoré sa majú zmontovať.
- RO Figura reprezentând piesele asamblate.
- GR Изображение на сглобените части.
- SI Slika sestavljenih delov.
- TR Ateklönüşünlerin topaştırılmış halleri.
- TR Birleştirilmiş parçaların resmi.



- DE Klarsichtteile
- EN Clear parts
- FR Pièces transparentes
- NL Transparente onderdelen
- IT Parti trasparenti
- ES Piezas transparentes
- PT Peças transparentes
- DK Klare dele
- NO Klare deler
- F Läpinäkyvät osat
- RU Прозрачные детали
- PL Przejrzyste części
- CZ Průhledné díly
- HU Átlátszó alkatrészek
- SK Číre diely
- RO Piese transparente
- GR Προзрачни части
- SI Prozorni deli
- TR Dişarınqerler
- TR Şeffaf parçalar



- DE Abziehbild in Wasser einweichen und anbringen.
- EN Soak and apply decals.
- FR Mouiller et appliquer les décalcomanies.
- NL Transfer in water even laten weken en aanbrengen.
- IT Immergere la decalcomania nell'acqua e applicarla.
- ES Mojar y aplicar calcomanías.
- PT Amolecer o decalque em água e aplicar.
- DK Gør overførbilledet vådt og sæt det på.
- NO Myk opp avtrekkingsbildet i vann og sett på.
- F Blötlägg dekalen i vatten och sätt på den.
- RU Пehмитя сиirtokuva vedessä ja siirrä paikalleen.
- RU Опустите переводную картинку в воду и нанесите её.
- PL Namoczyć kalkomanie w wodzie i przykleić.
- CZ Nechte obřísk odmočit ve vodě a přilepte.
- HU Merítse vízbe és helyezze fel a matricát.
- SK Obľáčkový obrázok namočte do vody a priložte na plochu.
- RO Potompe te vadenkato във вода и я поставете.
- GR Prelepnicu namakajte v vodi. In namestite.
- TR Mousukéyite se veró kai topothétete τις χάλκομανίες.
- TR Çikartmayı suda yumusatin ve takın.



- DE Chromteile
- EN Chrome parts
- FR Pièces chromées
- NL Chrom onderdelen
- IT Parti cromate
- ES Piezas cromadas
- PT Peças de cromo
- DK Førkromede dele
- NO Kromdeler
- F Kromdetaljer
- RU Хромированные детали
- PL Części chromowane
- CZ Chromované díly
- HU Króm alkatrészek
- SK Chromované diely
- RO Piese cromate
- GR Χρωμινοί μέρη
- SI Kromirani deli
- TR Mērin kromiyo
- TR Krom parçalar



- DE Zur Anbringung der Abziehbilder empfohlen.
- EN Recommended for affixing the decals.
- FR Recommandé pour l'application des décalcomanies.
- NL Aanbevolen voor het aanbrengen van de transfers.
- IT Raccomandato per l'applicazione delle decalcomanie.
- ES Recomendado para fijar bien las calcomanías.
- PT Recomendado para a fixação dos autocolantes.
- DK Anbefales til anbringelse af overførbillederne.
- NO Anbefales til å feste avtrekkbilder.
- SE Rekommenderad för montering av klisterdekalerna.
- F Suositellaan siirtokuvien siirtämiseen.
- RU Рекомендуется для нанесения переводных картинок.
- PL Zalecane do przyklejenia kalkomanii.
- CZ Doporučujeme k umístění obřískových obrázků.
- HU A matrica felhelyezéséhez ajánljható.
- SK Odporúčame sa pre umiestnenie obľáčkových obrázkov.
- RO Recomandat pentru aplicarea abjibildurilor.
- GR Препоръчва се за поставяне на ваденки.
- SI Pri nameštanju nalepnic priporočamo.
- TR Suniştatılır için önerilir.
- TR Çikartmaların takılması için önerilir.

- \* DE Nicht enthalten
- EN Not included
- FR Non fourni
- NL Behoort niet tot de levering
- IT Non incluso
- ES No incluido
- PT Não incluído
- DK Medfølger ikke
- NO Ikke inkludert
- F Ingår ej
- RU Ei sisällä
- RU Не содержится
- PL Nie wchodzi w zakres dostawy
- CZ Nemí obsaženo
- HU Nem tartalmazza
- SK Neobsahuje
- RO Nu este inclus
- GR Не се включва в комплекта
- SI Ni priloženo
- TR Δεν περιλαμβάνεται
- TR İçerilmiyor

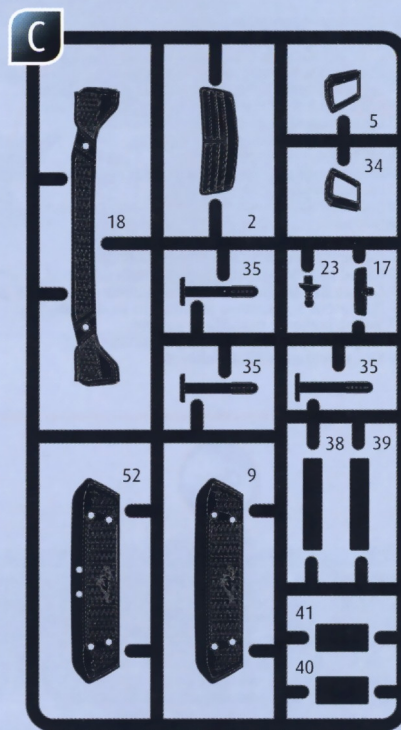
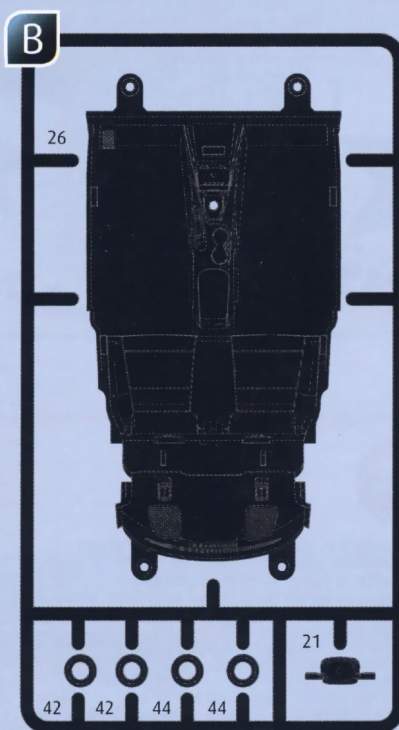
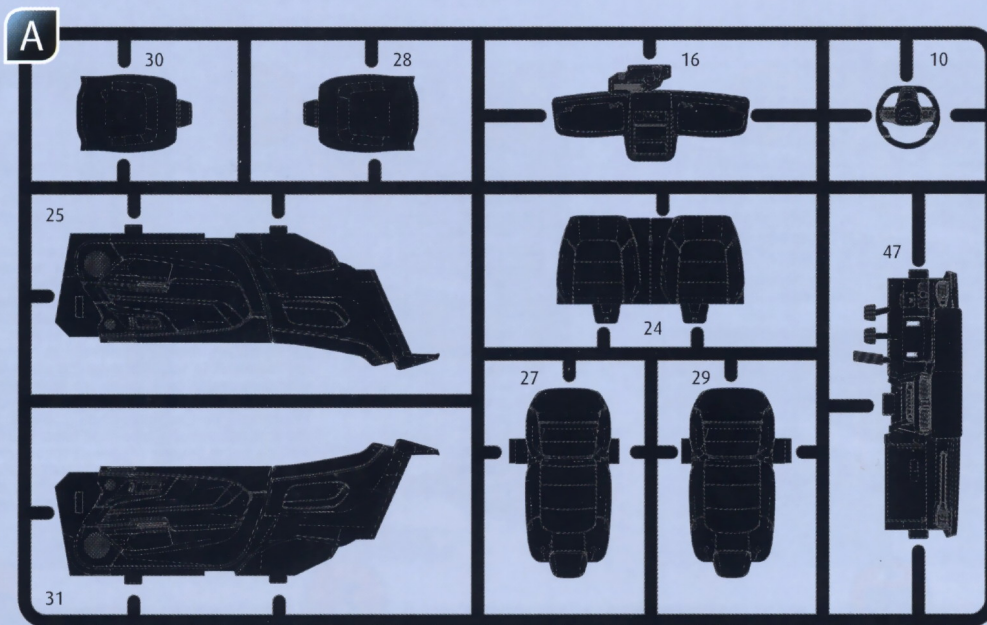

DE Nicht benötigte Teile  
 GB Parts not used.  
 FR Pièces non utilisées.  
 NL Niet benodigde onderdelen.  
 IT Parti non necessarie.  
 ES Piezas no utilizadas.  
 PT Peças não utilizadas.  
 DK Dele der ikke skal bruges.  
 NO Deler som ikke er nødvendige.  
 SE Ej nödvändiga delar.  
 FI Tarpeettomat osat.

RU Неиспользуемые детали.  
 PL Niepotrzebne części.  
 CZ Nepotřebné díly.  
 HU Szükségtelen alkatrészek.  
 SK Nepotrebné diely.  
 RO Pieșe care nu sunt necesare.  
 BG Ненужни детайли.  
 SI Nepotrebni deli.  
 GR Μη χρησιμοποιούμενα μέρη.  
 TR Gereklili olmayan parçalar.

DE Kundenservice: [www.revell-service.de](http://www.revell-service.de)

GB Customer Service: [www.revell-service.de](http://www.revell-service.de)

US Customer Service: [www.revell-service.de](http://www.revell-service.de)

FR Service clientèle: [www.revell-service.de](http://www.revell-service.de)

NL Klantenservice: [www.revell-service.de](http://www.revell-service.de)

ES Servicio al cliente: [www.revell-service.de](http://www.revell-service.de)

IT Servizio clienti: [www.revell-service.de](http://www.revell-service.de)

PT Serviço de apoio ao cliente: [www.revell-service.de](http://www.revell-service.de)

DK Kundeservice: [www.revell-service.de](http://www.revell-service.de)

NO Kundeservice: [www.revell-service.de](http://www.revell-service.de)

SE Kundtjänst: [www.revell-service.de](http://www.revell-service.de)

FI Asiakaspalvelu: [www.revell-service.de](http://www.revell-service.de)

RU Служба поддержки клиентов: [www.revell-service.de](http://www.revell-service.de)

PL Dział obsługi klienta: [www.revell-service.de](http://www.revell-service.de)

CZ Zákaznický servis: [www.revell-service.de](http://www.revell-service.de)

HU Ügyfélszolgálat: [www.revell-service.de](http://www.revell-service.de)

SK Zákaznický servis: [www.revell-service.de](http://www.revell-service.de)

RO Serviciul clienți [www.revell-service.de](http://www.revell-service.de)

BG Отдел за обслужване на клиенти: [www.revell-service.de](http://www.revell-service.de)

SI Služba za pomoč strankam: [www.revell-service.de](http://www.revell-service.de)

GR Τμήμα εξυπηρέτησης πελατών: [www.revell-service.de](http://www.revell-service.de)

TR Müşteri hizmetleri: [www.revell-service.de](http://www.revell-service.de)

D

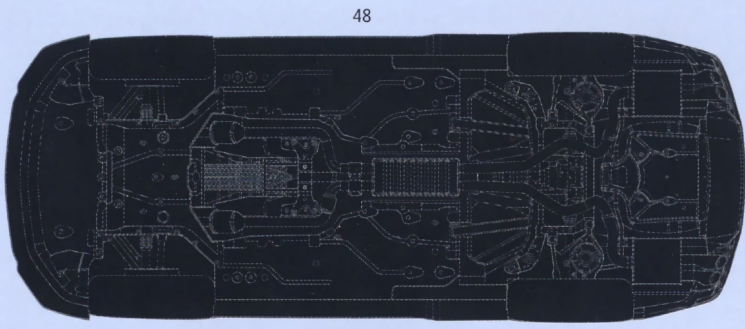

E

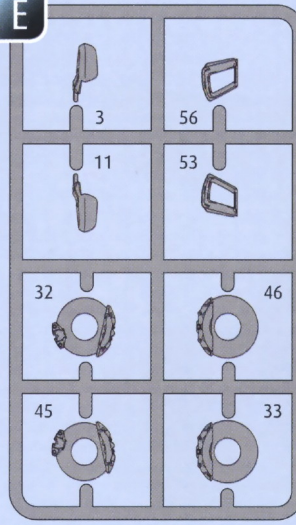

F

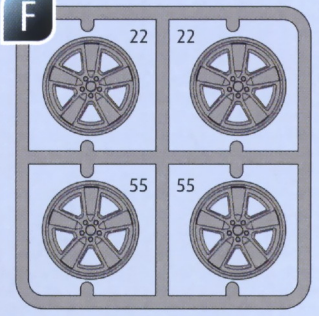

G

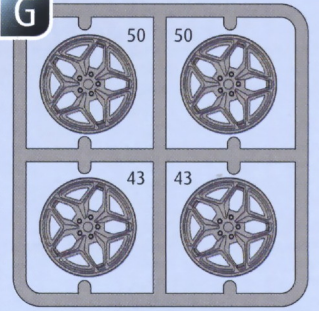

H

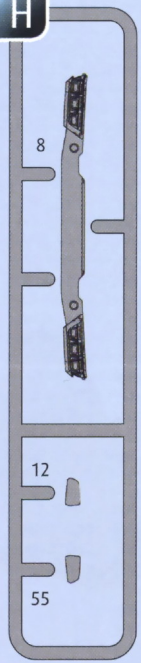

I

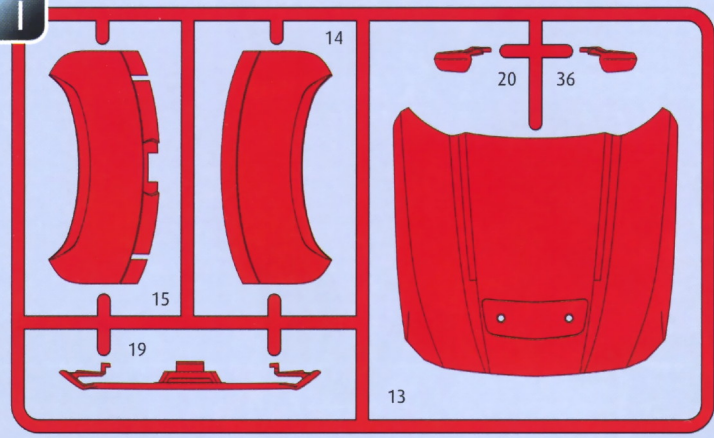

K

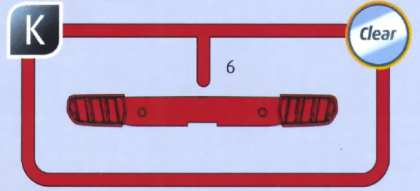

J

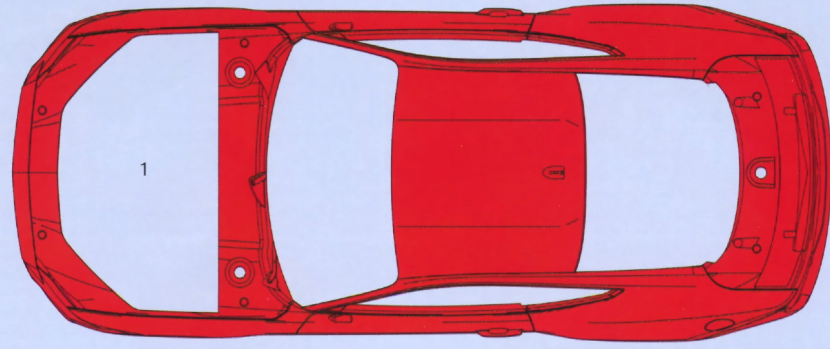

Clear

M

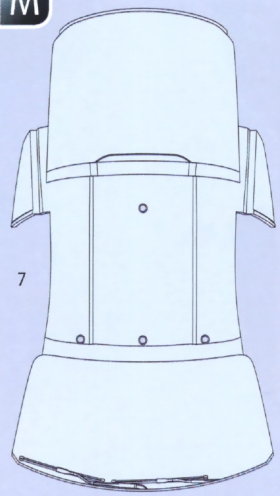

L

Clear

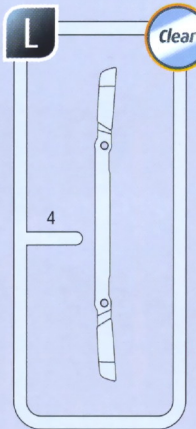

51 FRONT TIRE



N

49 REAR TIRE





1

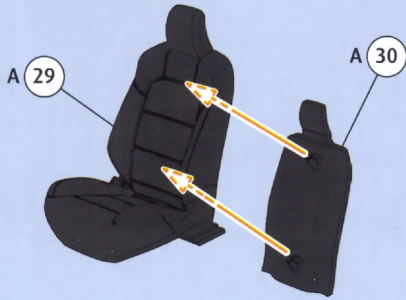

2

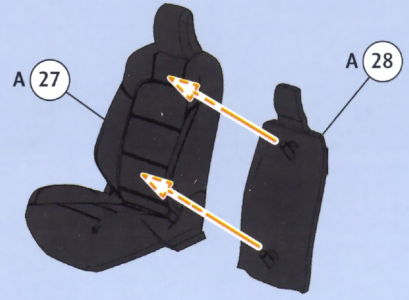

3

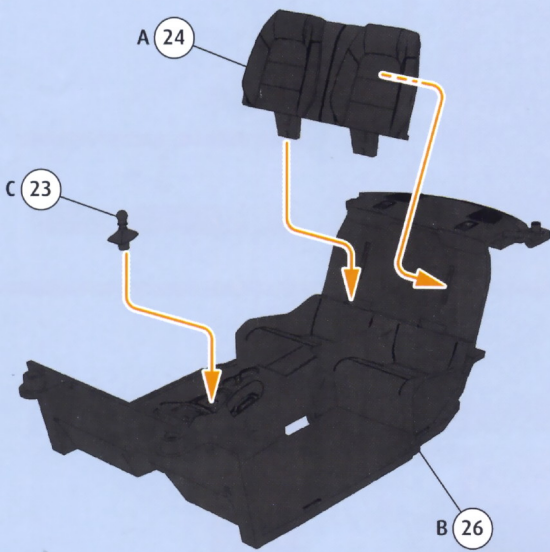

4



5

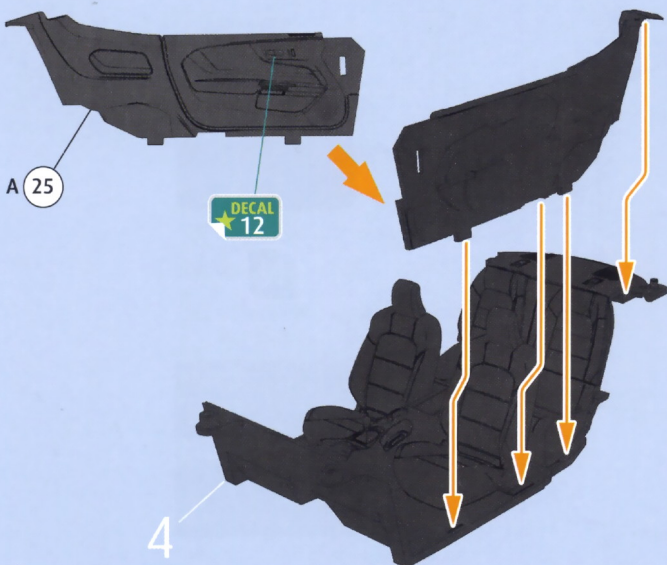

6

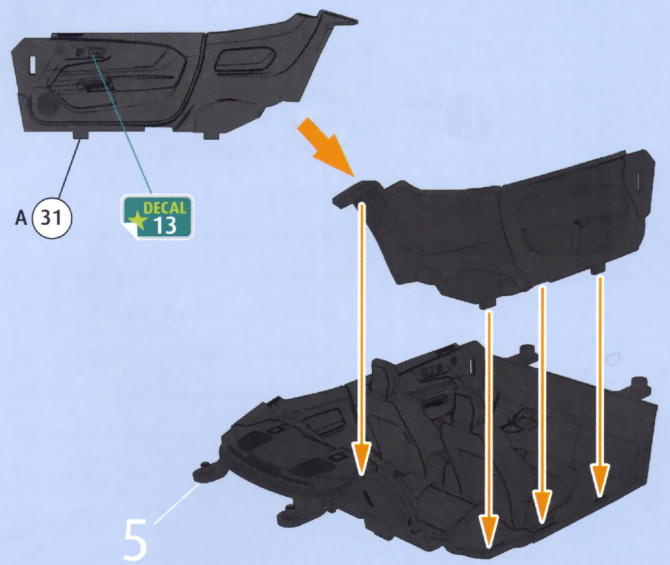

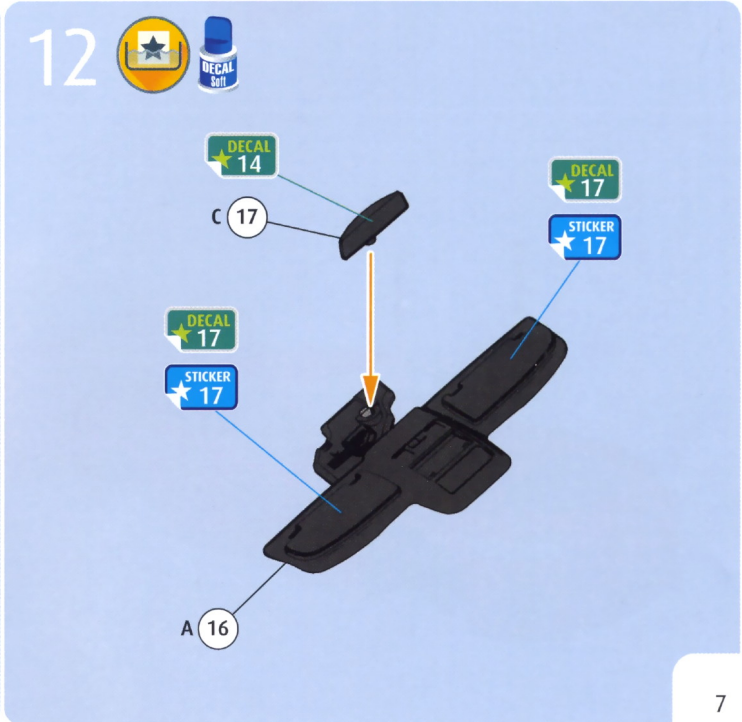
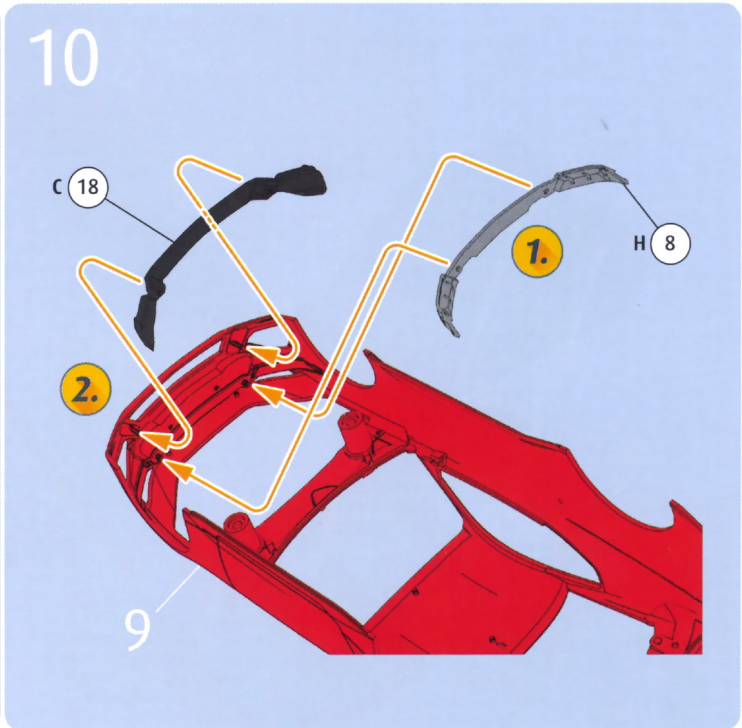
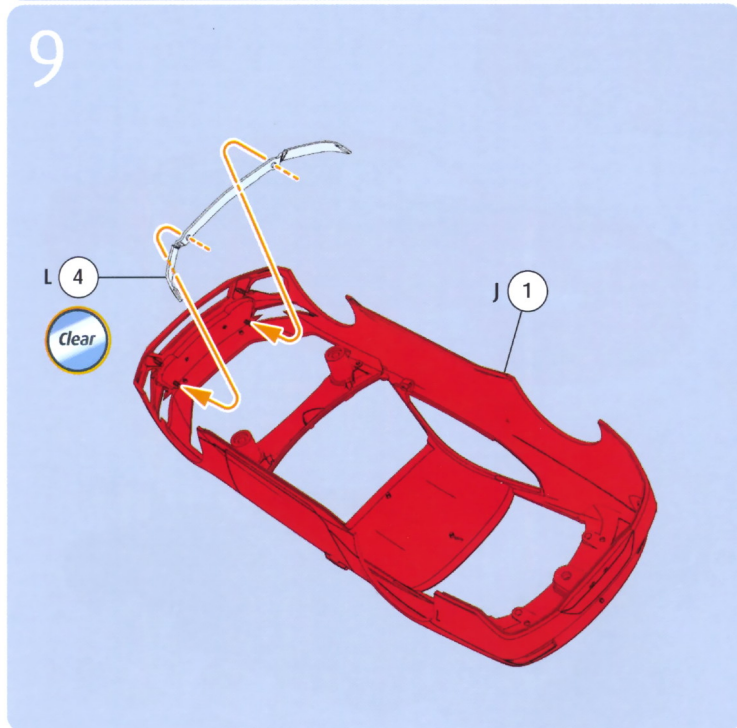
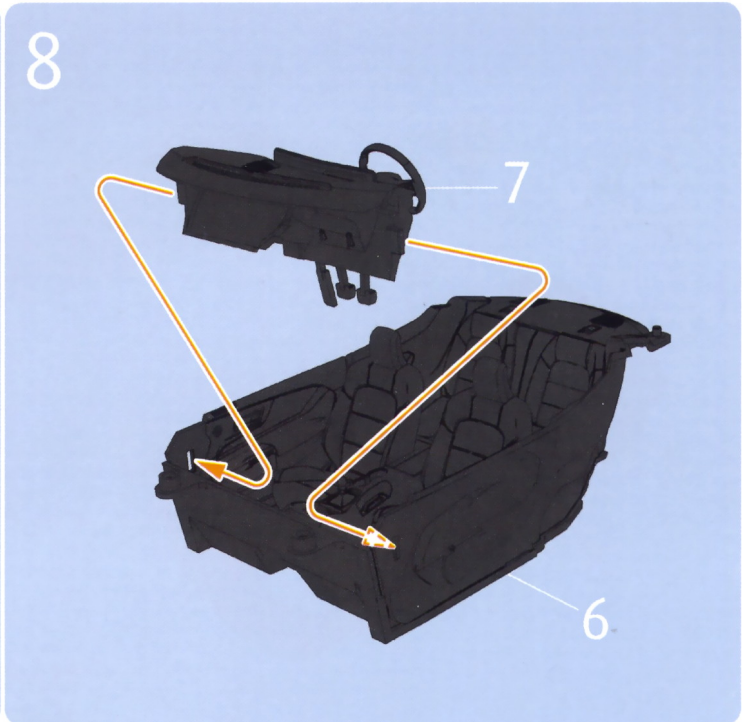
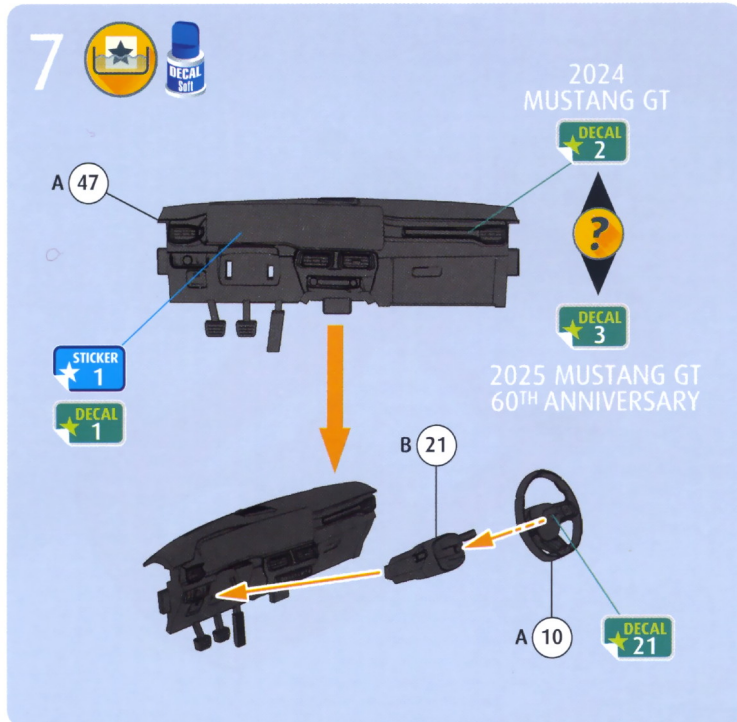

13

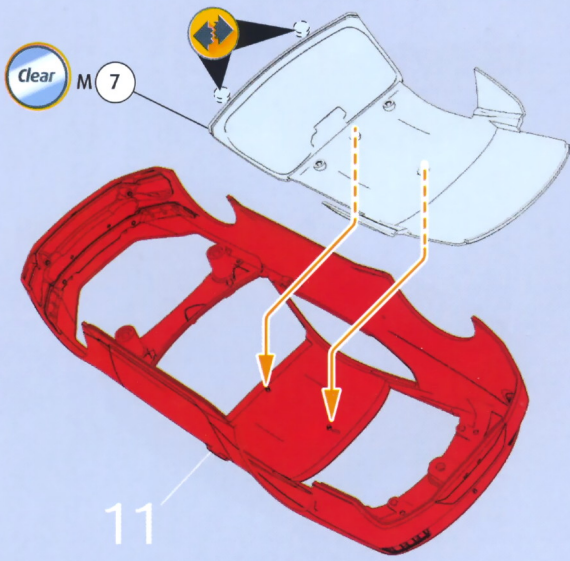

14

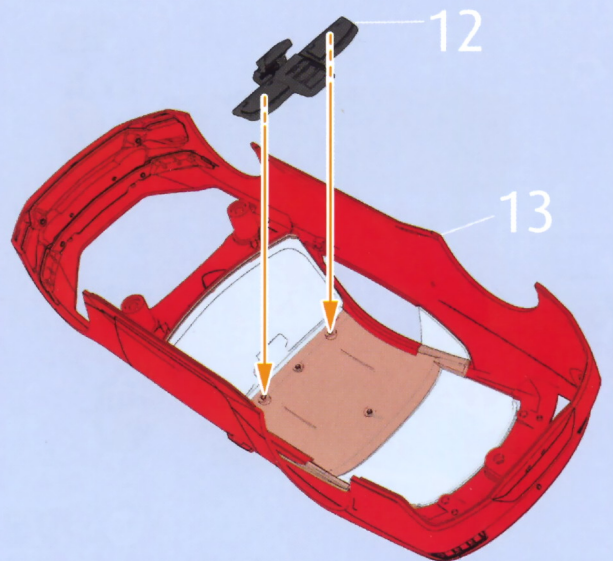

15

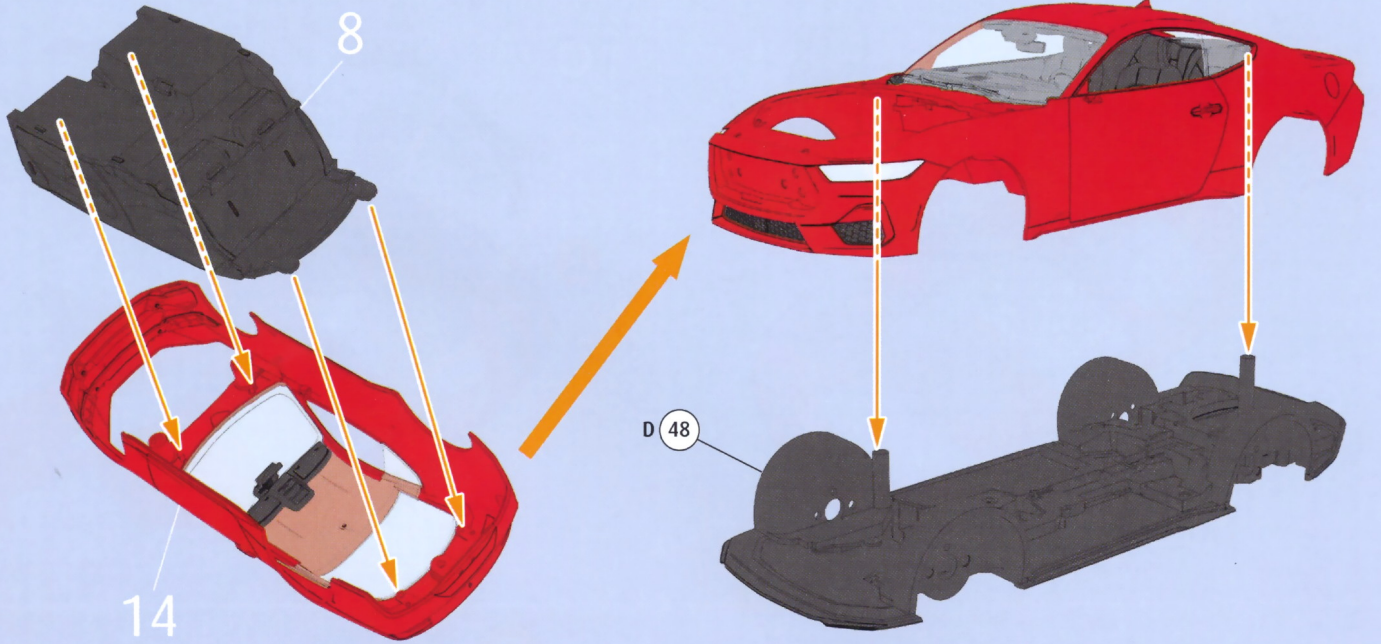

16

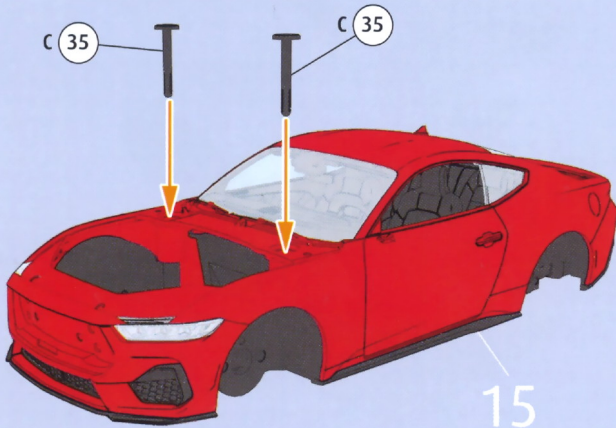

17

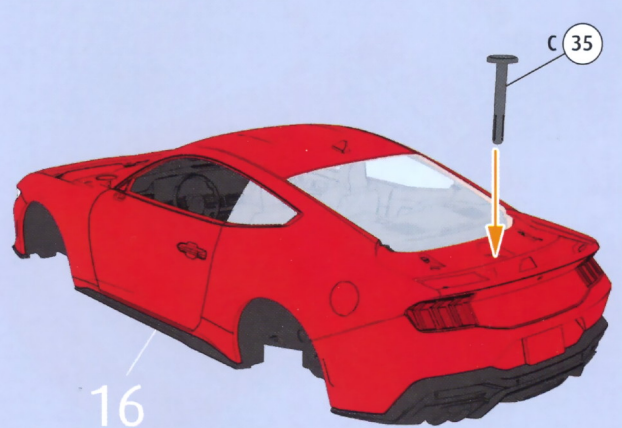

18  

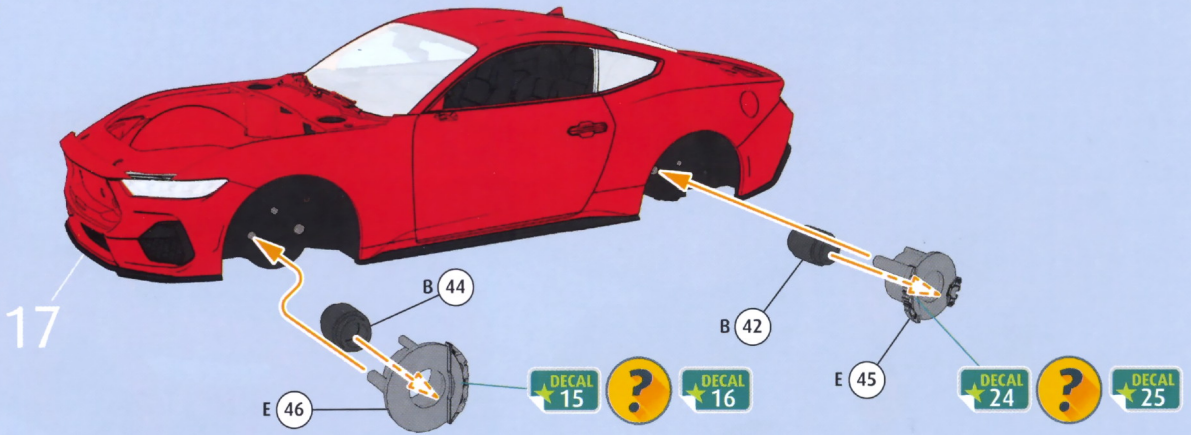

19  

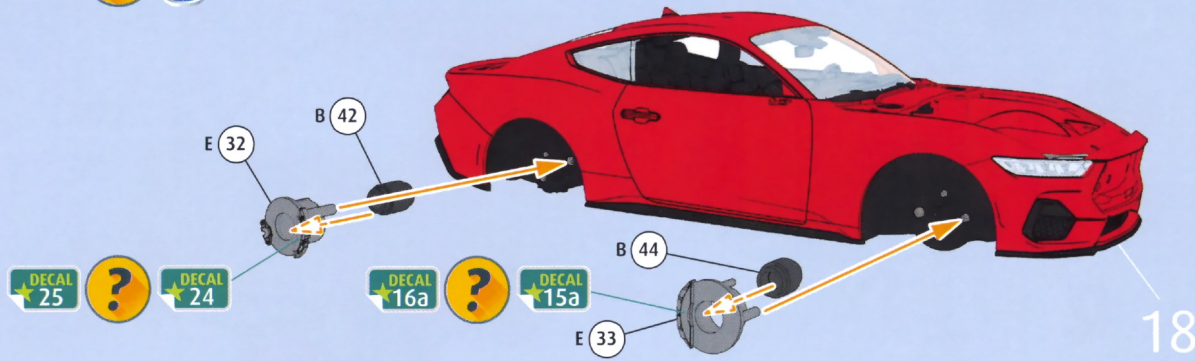

20     FRONT

2024 MUSTANG GT  2025 MUSTANG GT 60<sup>TH</sup> ANNIVERSARY

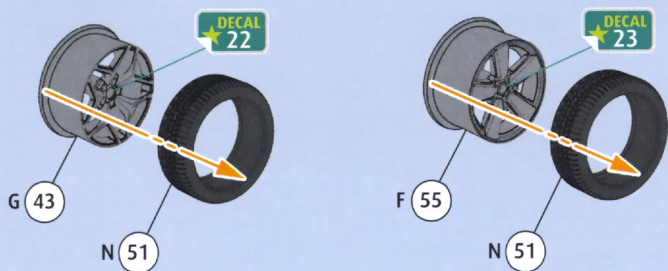

21     REAR

2024 MUSTANG GT  2025 MUSTANG GT 60<sup>TH</sup> ANNIVERSARY

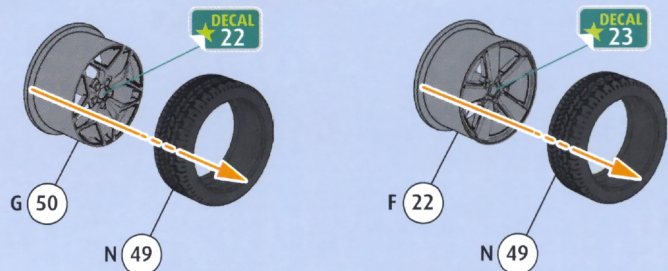

22

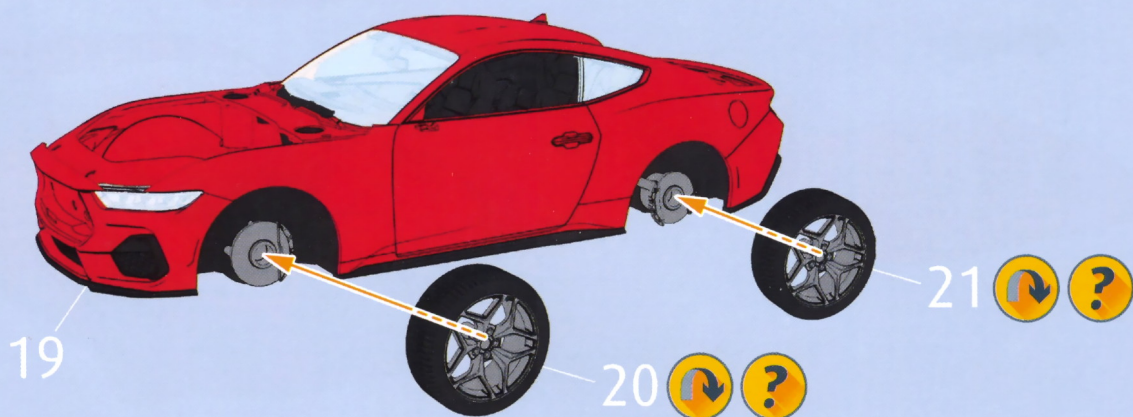

# 23

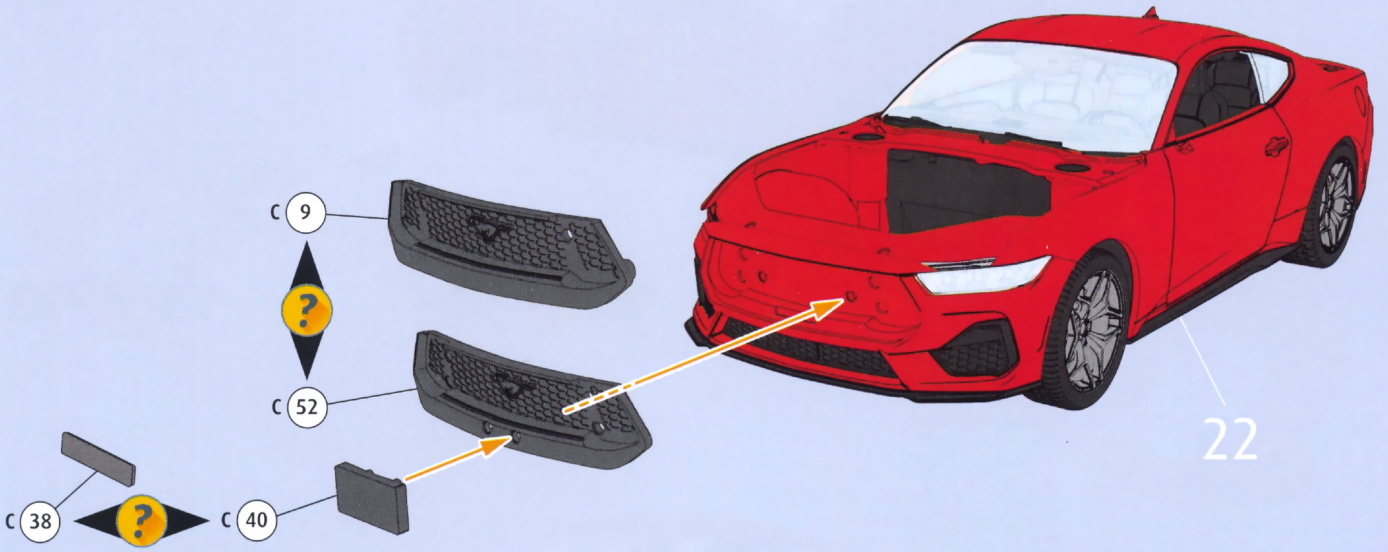

# 24

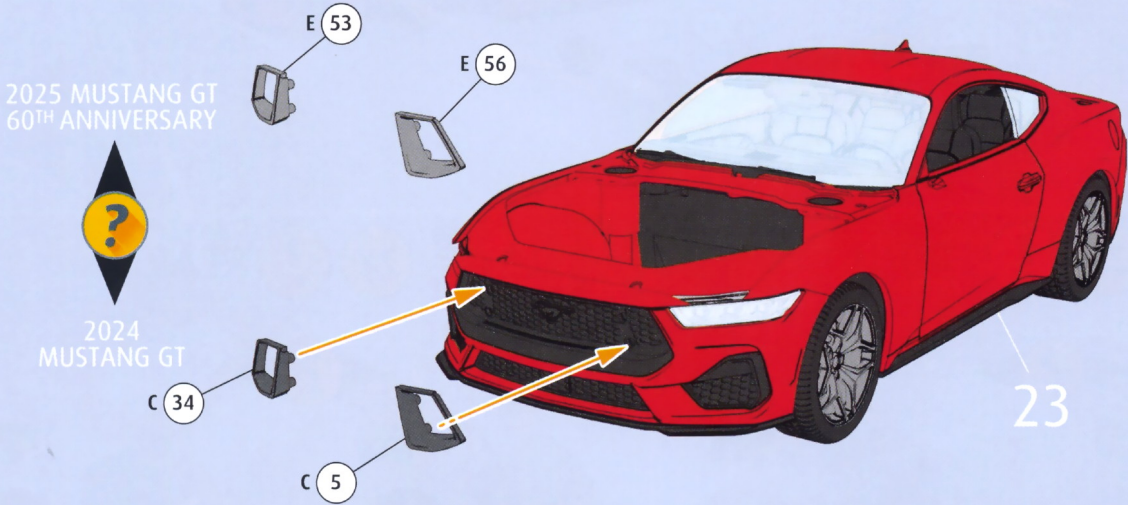

# 25

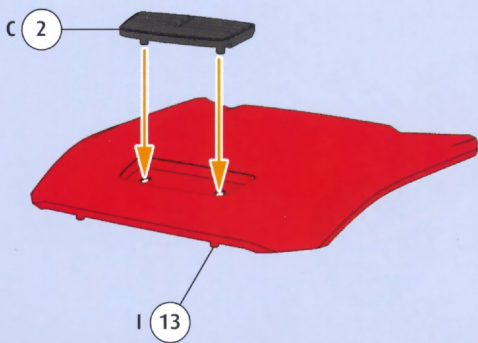

# 26

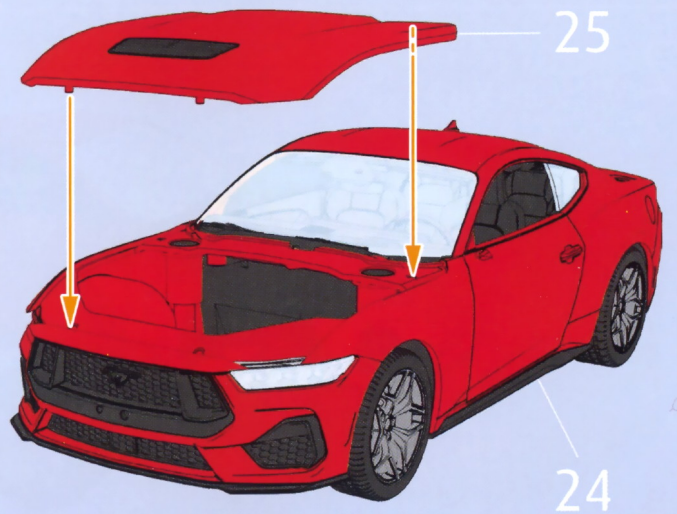

# 27 !

2025 MUSTANG GT  
60TH ANNIVERSARY

E 11



I 20

2024  
MUSTANG GT

H 12

26

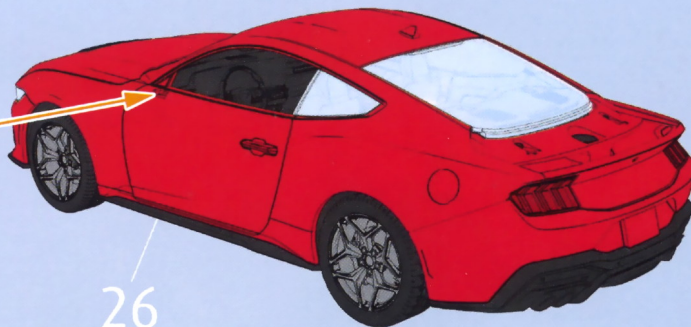

# 28 !

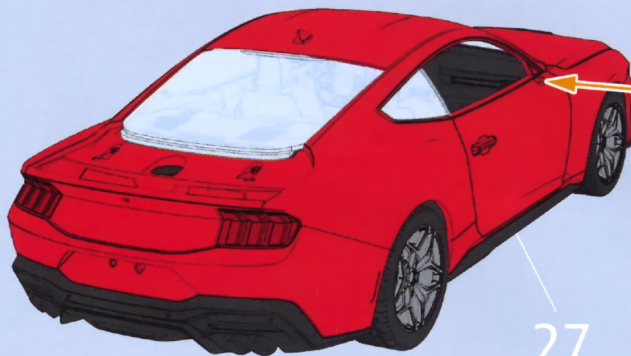

27

2025 MUSTANG GT  
60TH ANNIVERSARY

E 3



2024  
MUSTANG GT

I 36

H 55

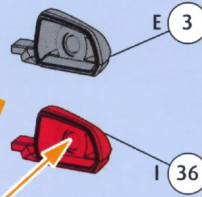

# 29 !

28

2025 MUSTANG GT  
60TH ANNIVERSARY



2024  
MUSTANG GT

28

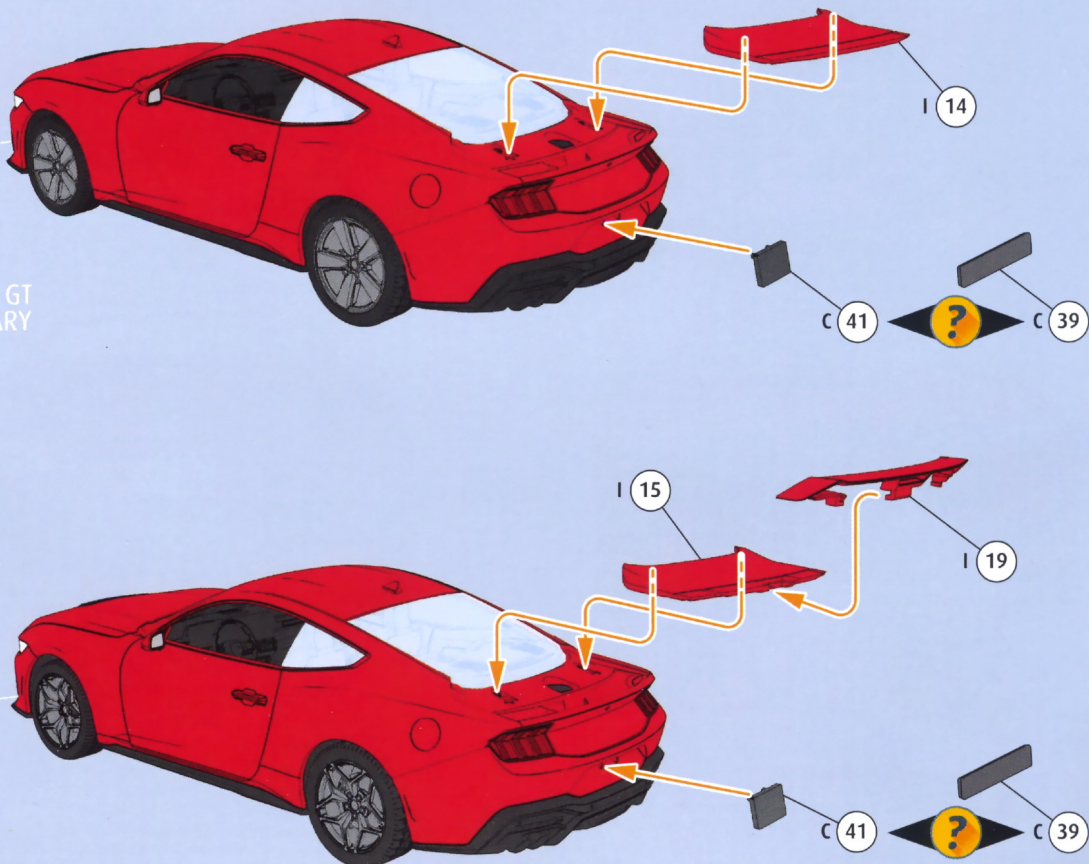



★ DECAL 10  
★ STICKER 10

★ DECAL 11  
★ STICKER 11

★ DECAL 6  
★ STICKER 6

4X ★ DECAL 22

★ DECAL 8  
★ STICKER 8

★ DECAL 9  
★ STICKER 9

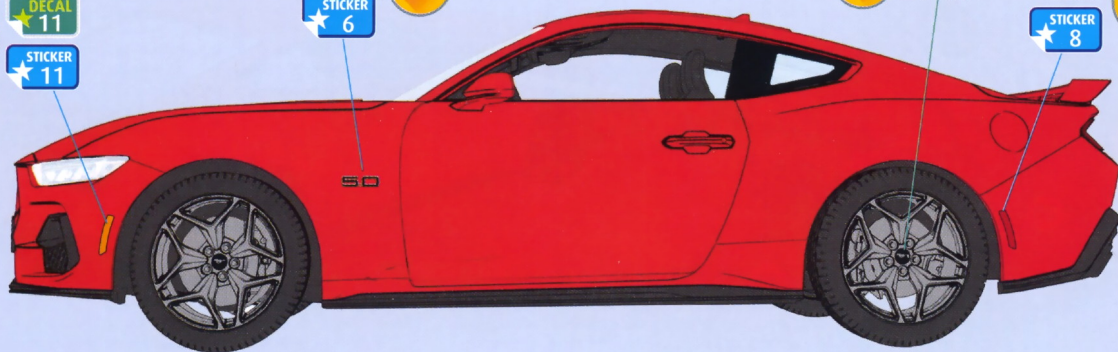

★ DECAL 20

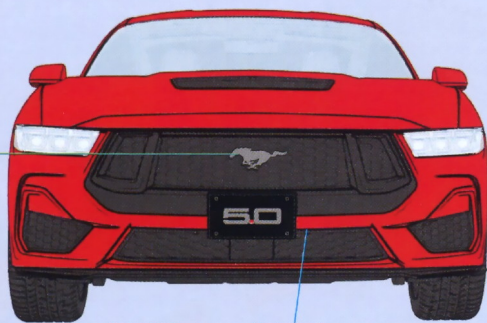

★ DECAL 18



★ DECAL 7  
★ STICKER 7



★ DECAL 32  
★ STICKER 32

★ DECAL 19

2024 MUSTANG GT

★ STICKER 30  
★ DECAL 30

★ STICKER 31  
★ DECAL 31



★ STICKER 31  
★ DECAL 31

★ STICKER 31  
★ DECAL 31



★ STICKER 31  
★ DECAL 31

★ STICKER 31  
★ DECAL 31

2025 MUSTANG GT 60TH ANNIVERSARY

★ DECAL 4  
★ STICKER 4

4X ★ DECAL 23

★ DECAL 8  
★ STICKER 8

★ DECAL 9  
★ STICKER 9

★ DECAL 11  
★ STICKER 11

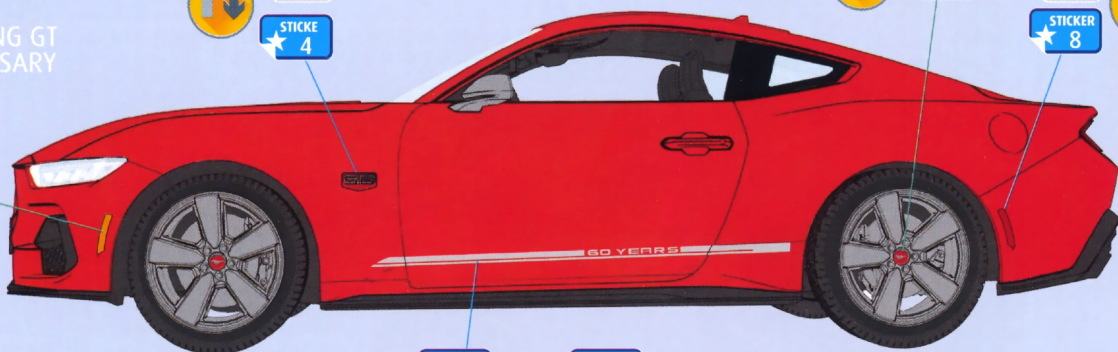

★ DECAL 10  
★ STICKER 10

★ STICKER 26  
★ DECAL 26



★ STICKER 27  
★ DECAL 27



★ DECAL 29

★ DECAL 28



★ DECAL 26



★ DECAL 27



★ DECAL 29

★ DECAL 5  
★ STICKER 5

★ DECAL 20

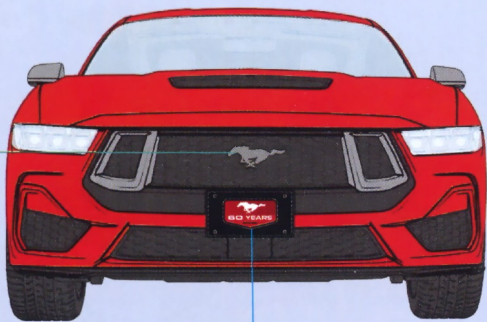

★ DECAL 18



★ DECAL 32  
★ STICKER 32

★ DECAL 19

★ STICKER 30  
★ DECAL 30

★ STICKER 31  
★ DECAL 31

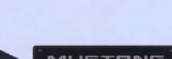

★ STICKER 31  
★ DECAL 31

★ STICKER 31  
★ DECAL 31



★ STICKER 31  
★ DECAL 31

★ STICKER 31  
★ DECAL 31



Ford Motor Company Trademarks and Trade Dress used under license to Carrera Revell Europe GmbH.  
 Les marques de commerce déposées et les présentations de Ford Motor Company sont utilisées sous licence par Carrera Revell Europe GmbH.  
 Las marcas comerciales y la imagen de marca de Ford Motor Company se utilizan conforme a licencia por Carrera Revell Europe GmbH.

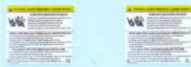

17 17

26

27

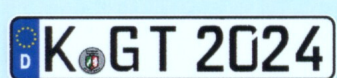

30

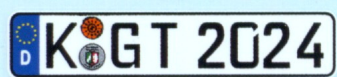

31

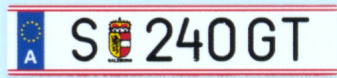

30

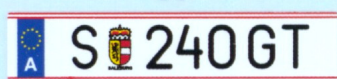

31



31



31



31



31



31



30



31



31

1

2



4



4



5

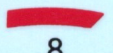

8

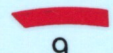

9

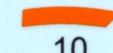

10

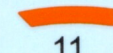

11



12



13

3

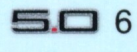

6

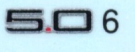

6



7



14

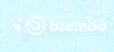

15

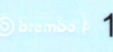

15a

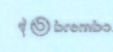

16

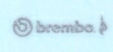

16a

18

19



20



21



22



22



22



22



22



23



23



23



23



24



24



25



25

28

29



30

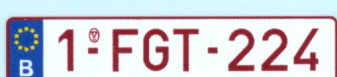

31



30

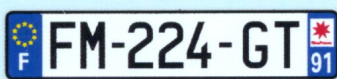

31

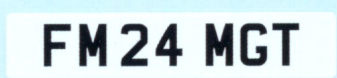

30



31

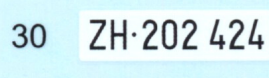

30

ZH-202 424

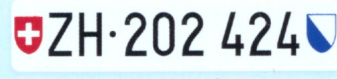

31

07743 - 0240c

2024 Ford Mustang GT (2 in 1)

© 2025 CARRERA REVELL Europe GmbH

V01.01.

Printed in Italy

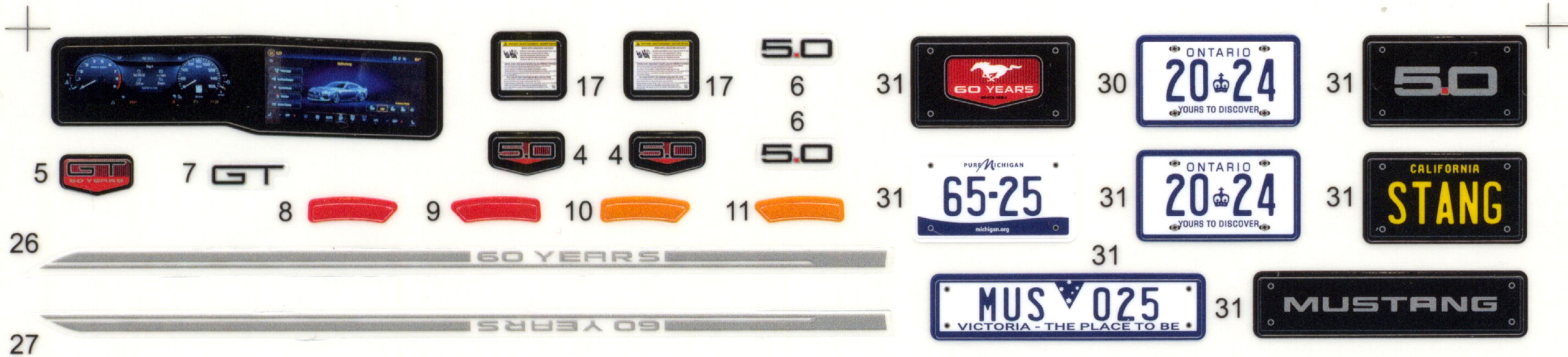

30



31

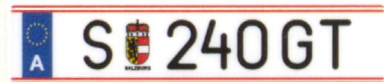

30



31

07743 - 0280

FM 24 MGT

30



31



30



31

2024 Ford Mustang GT (2 in 1)

© 2025 CARRERA REVELL Europe GmbH



30



31



30



31

2024 Ford Mustang GT (2 in 1)

© 2025 CARRERA REVELL Europe GmbH



32



32



32



32



30



31

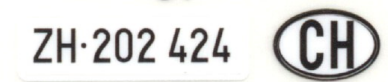

30



31



32



32

V01.01.

Printed in Italy