

QUICKSTART GUIDE

SCX30 1/30th SCALE 4X4 ROCK CRAWLER RTR

1. Remove the Body

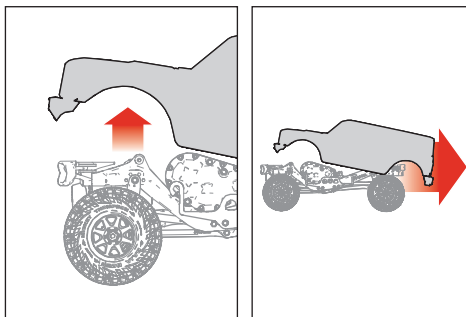

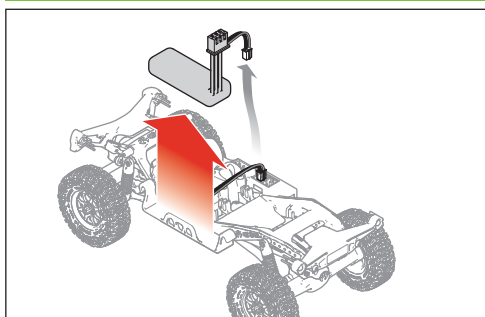

2. Remove the Vehicle Battery

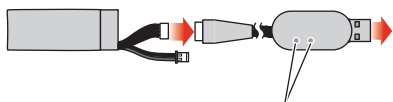

3. Charge the Vehicle Battery



-   The LED glows solid red and blinking green while charging.
-  The LED glows solid green when charging is complete.

4. Reinstall the Vehicle Battery

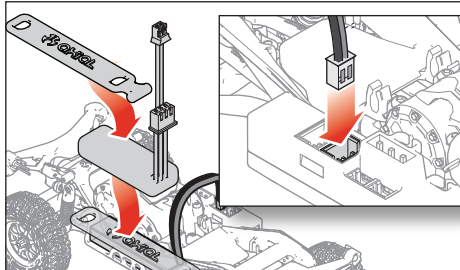

5. Install the Transmitter Batteries

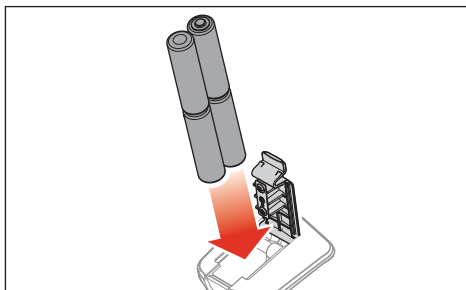

6. Power On the Transmitter

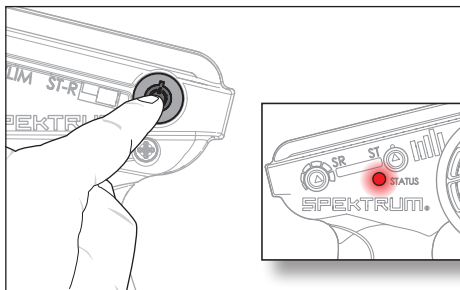

7. Reinstall the body

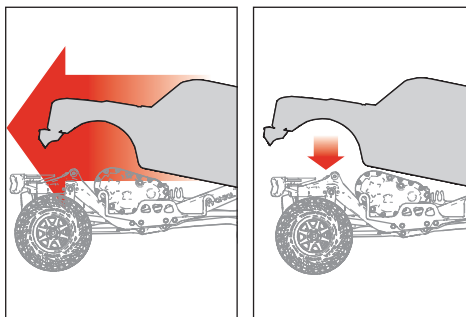

8. Power On the Vehicle

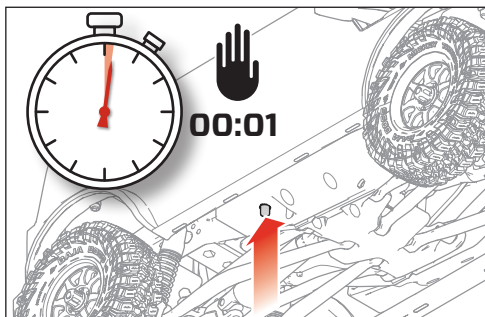

9. Forward/Reverse

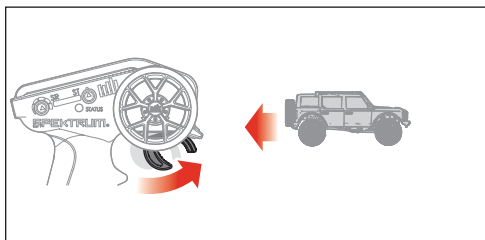
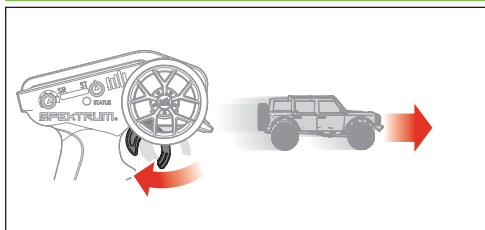

10. Steering

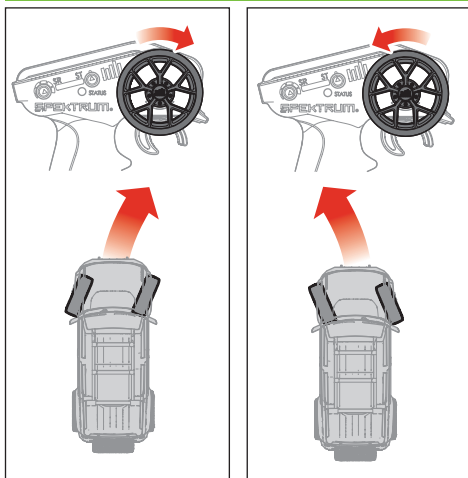

11. Steering Trim

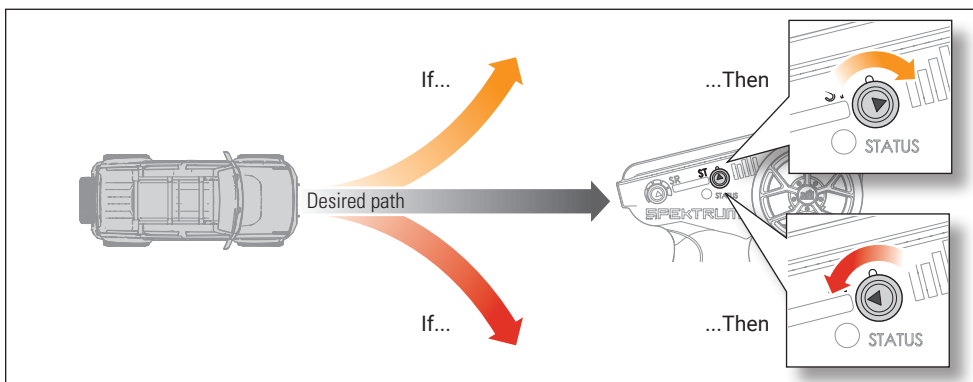

12. Throttle Limiter

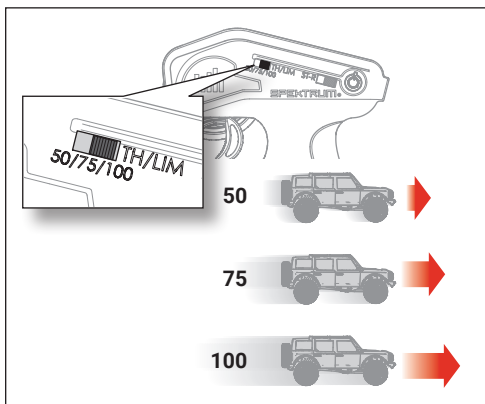

13. Steering Rate

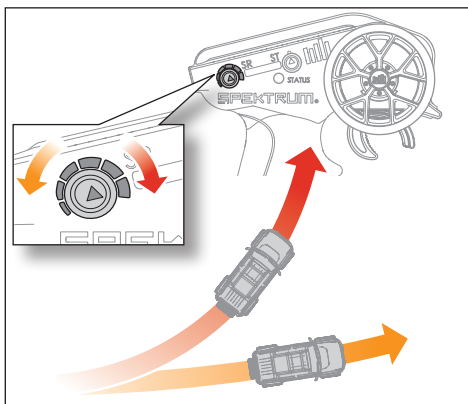

14. Remove the Body

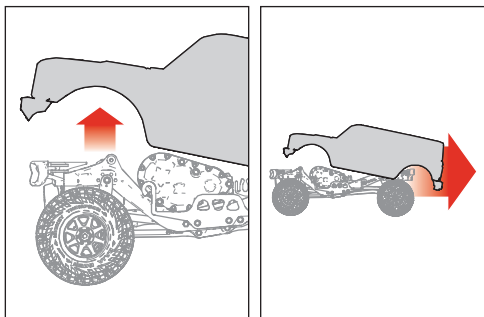

15. Power Off the Vehicle

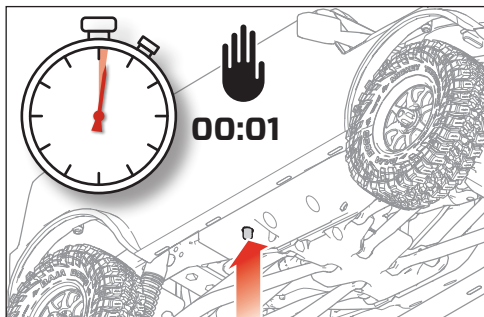

16. Disconnect the Vehicle Battery

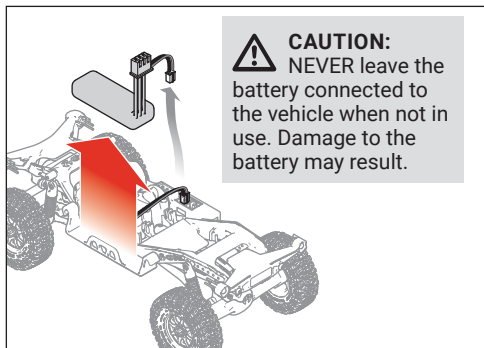

17. Power Off the Transmitter

