

ASSOCIATED 1:10 SCALE ELECTRIC TRUCK MANUAL



INSTRUCTION MANUAL FOR THE TEAM ASSOCIATED RC10T4 TRUCK



T4 Features

- >> New Longer MIP CVD dog bones and axles in kit version.
- >> Lower motor mounting position.
- >> Kimbrough Spur Gear.
- >> Racing compound front and rear tires.
- >> Plenty of chassis room to hold most electronics.
- >> All-new molded composite low-CG chassis.
- >> Adjustable battery position.
- >> New design battery hold-down strap.
- >> Rugged steel turnbuckles.
- >> Fully adjustable caster, camber, and toe-in.
- >> Angled bellcrank "co-planar" steering.
- >> Built-in servo saver.
- >> Vertical ball end adjustment, front & rear.

T4 Factory Team Truck Kit #7022

Threaded shock bodies.
CVD rear axles.
Unpainted body.

Also includes:
Bearing Associated Transmission.
Pro-Line racing compound tires.
Factory Team carbon.
Factory Team blue aluminum.
Factory Team titanium turnbuckles.
Factory Team Unobtainium shock shafts.

T4 Truck Kit #7020

Hard anodized shock bodies.
CVD rear axles.
Unpainted body.

Also includes:
Bearing Associated Transmission.
Racing compound tires

T4 RTR RS #7024

Blue aluminum shock bodies.
Associated dogbone rear axles.
Painted body.

Also includes:
Associated Transmission.
Radio, speed control and receiver.
Electric motor and pinion gear.
Racing tires.
Already assembled!

TOOLS

KIT TOOLS SUPPLIED

- 1 Allen wrenches #6950 (.050", 1/16", 3/32", 5/64")
- 2 Molded tools #6956
- 3 Camber gauge #1719
- 4 Shock building tool #6429

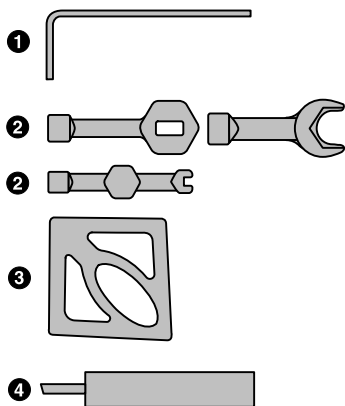

HELPFUL ITEMS (NOT REQUIRED)

- 1 Allen drivers (straight Allen wrenches with hex shaped handles) such as the following made by Associated:
 - #1542 .050" driver
 - #1543 1/16" driver
 - #1545 5/64" driver
 - #1546 3/32" driver
 - #1547 2.5mm driver
- 2 Vernier calipers
- 3 Body Scissors (#1737)
- 4 Green Slime shock lube (#1105)
- 5 Nut drivers (screwdriver-handled hex socket tools)
 - 3/16" nut driver
 - 1/4" nut driver
 - 11/32" nut driver

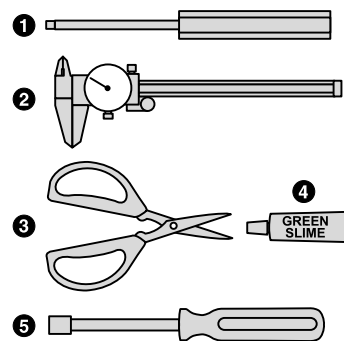

EXTRA TOOLS NEEDED

- 1 Phillips screwdriver
- 2 Needlenose pliers
- 3 Soldering iron (40-50 watts) and a small amount of Rosin core solder. Pencil-type soldering iron is better than the gun type. **DANGER! Tip will be HOT!**
- 4 Thread locking compound (#1596 Locking Adhesive or equivalent)
- 5 Super glue (cyanoacrylic glue or #1597 Tire Adhesive).
- 6 Hobby knife **WARNING! This knife cuts plastic and fingers with equal ease, so be careful.**
- 7 Precision ruler

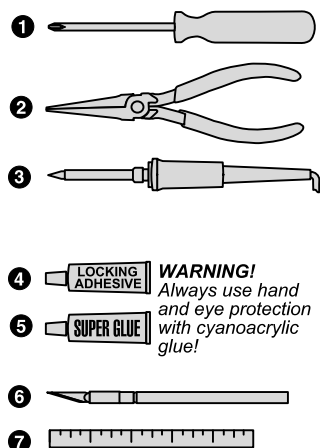

WARNING!
Always use hand and eye protection with cyanoacrylic glue!

WARNING!

Do not use a power screwdriver to install screws into nylon, plastic, or composite materials. The fast rotation speed can heat up the screws being installed. They can then break the molded parts or strip the threads during installation.

EXTRA ITEMS NEEDED

	7022	7020	7024
1 R/C two channel surface frequency radio system.	need	need	
2 Battery pack (6 cell).	need	need	need
3 Battery charger (we recommend a peak detection charger).	need	need	need
4 Electronic speed control.	need	need	
5 R/C electric motor.	need	need	
6 Pinion gear, size to be determined by type and wind of motor you will be using.	need	need	

CONTACTING US

CUSTOMER SUPPORT

(714) 850-9342
 Fax (714) 850-1744
<http://www.rc10.com/help>



©2006 Associated Electrics, Inc.

ASSOCIATED ELECTRICS, INC.

3585 Cadillac Ave.
 Costa Mesa, CA 92626
 USA
<http://www.TeamAssociated.com/>

BEFORE BUILDING

OPEN THE BAGS IN ORDER

The assembly is arranged so that you will open and finish that bag before you go on to the next bag. **Sometimes you will have parts remaining at the end of a bag. These will become part of the next bag.**

LEFT AND RIGHT

When we refer to left and right sides of the truck, we are referring to the driver's point of view while sitting in the truck.

SUPPLEMENTAL SHEETS

Improvements to our kits, if any, will be noted in supplementary sheets located in a parts bag or inside the kit box. Check the kit box before you start and each bag as it is opened. When a supplement is found, attach it to the appropriate section of the manual.

◀1:1▶ = Actual size part. x2 = Quantity for step.
Rear x2 = Do entire step twice. ! = Pay attention to this detail.
RTR: 7826 = Part included in RTR trucks.

BAG A

ASTERISK (*) BY BOLD PART NUMBER INDICATES PART USED IN FACTORY TEAM KIT.

1

9659 x1 Servo Saver, lower
 9659 x1 Servo Saver, upper

BLACK GREASE 6588

2

◀1:1▶ 9610 x2 Servo Saver washer, lower
 ▶1:1▶ 9610, 9657* x1 Servo Saver spring

3

◀1:1▶ 9610 x1 Servo Saver washer, upper
 ▶1:1▶ 9610, 9610B x1 Servo Saver bolt

With supplied wrench, tighten servo saver bolt completely, but take care not to overtighten.

4

◀1:1▶ 6271 x1 Ball End, short, silver
 ▶1:1▶ 6272 x1 Dust Cover, foam

silver

5

9659 x1 Steering Rack
 9659 x2 Block Carrier Bushing
 6271 x2 Ball End, short, silver
 6272 x2 Dust Cover, foam

NOTE





Install ball ends here only when using **OPTIONAL** inline axles #9577, 7459

6

◀1:1▶ 2221 x2 B. H. Screw 4-40 x 7/16
 9659 x1 Bellcrank

3

BAG A

-  x1
-  x4
-  x1
-  x1
-  x1

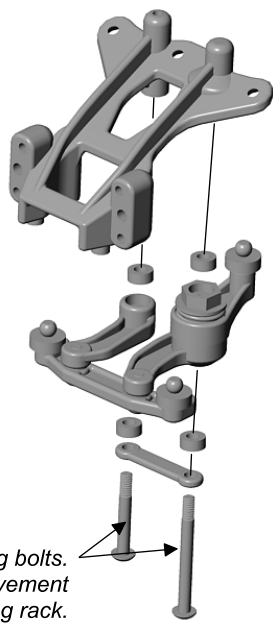

Do not overtighten steering bolts. Make sure there is free movement in the steering rack.

7

-  x1





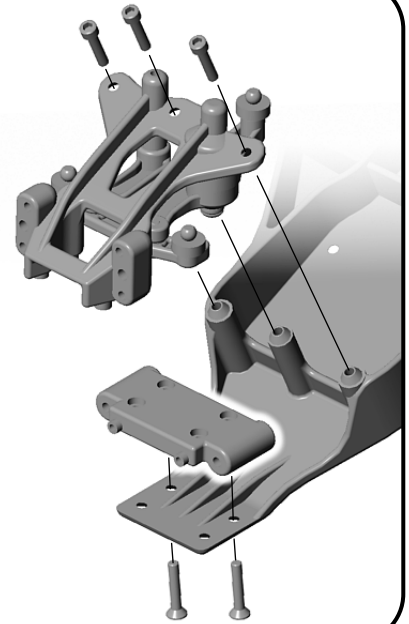

-  x3

-  x2

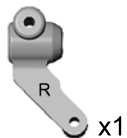



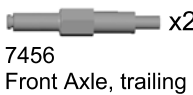

8 7440, 7441* T4 Chassis

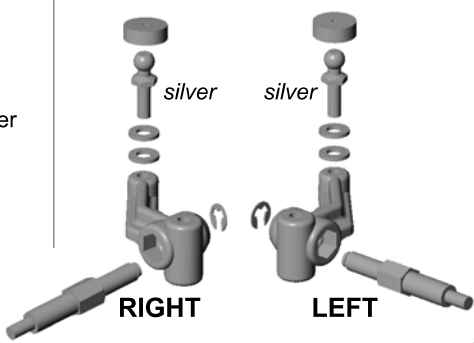
BAG B

-  x1
-  x1
-  x2
-  x2
-  x2
-  x4
-  x2



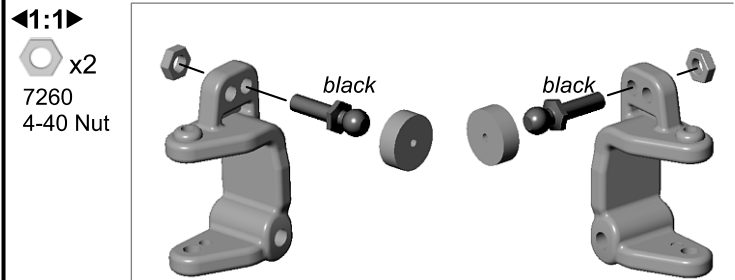

1

-  x1
-  x1
-  x2
-  x2



2

-  x2
-  x4
-  x2

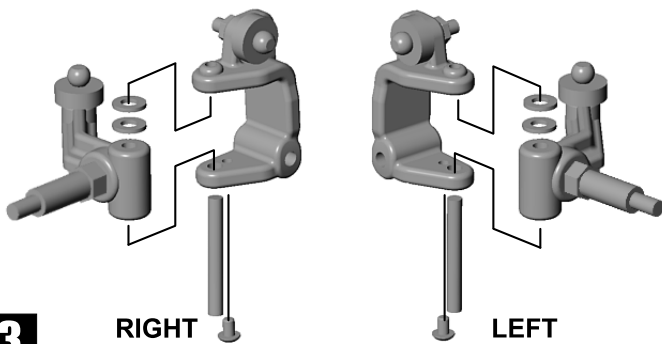

4

3

STEPS 1-3 ASSEMBLED RIGHT

STEPS 1-3 ASSEMBLED LEFT

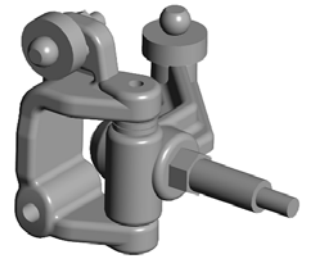
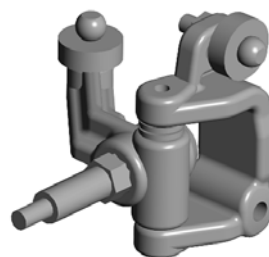

BAG B

- x2 7446, 7447* A-arms, front
- x2 9580 Spacer
- x2 9645 B. H. Screw 2-56 x 1/8
- x2 9622 Hinge Pin, front outer

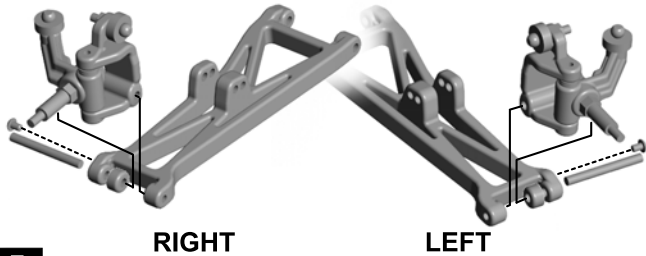

RIGHT

LEFT

4

- x1 9564, 9665* Front Hinge Pin Brace
- x2 9621 Hinge Pin, front inner
- x2 9645 B. H. Screw 2-56 x 1/8
- x2 4334 B. H. Screw 2-56 x 5/16

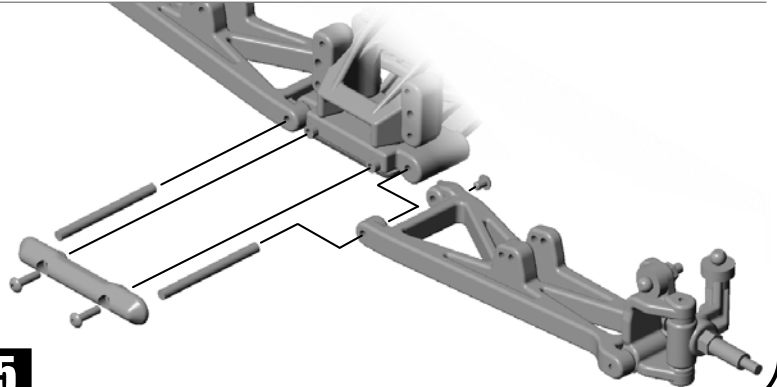

5

- x2 6272 Dust Cover, foam
- x2 6273 Ball End, long, silver
- x2 9630 washer
- x2 6295 4-40 nut
- x1 7442, 7443* Front Shock Tower
- x2 6924 S. H. Screw 4-40 x 3/8

- x2 7413 B.H. Screw 4-40 x 3/4

- x2 7439 Front Body Mount

Pre-tap holes with a #6924 screw for easier ball end installation

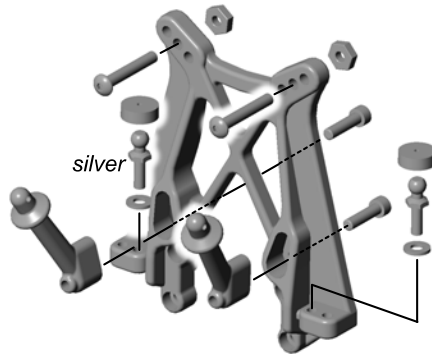
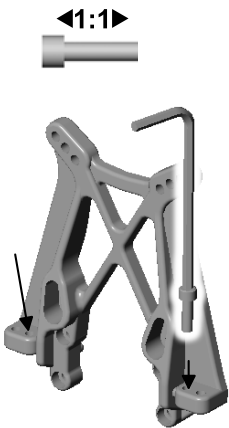

silver

6

- x1 9562 Front Bumper
- x4 6924 S. H. Screw 4-40 x 3/8
- x2 6915 F. H. Screw 4-40 x 5/8

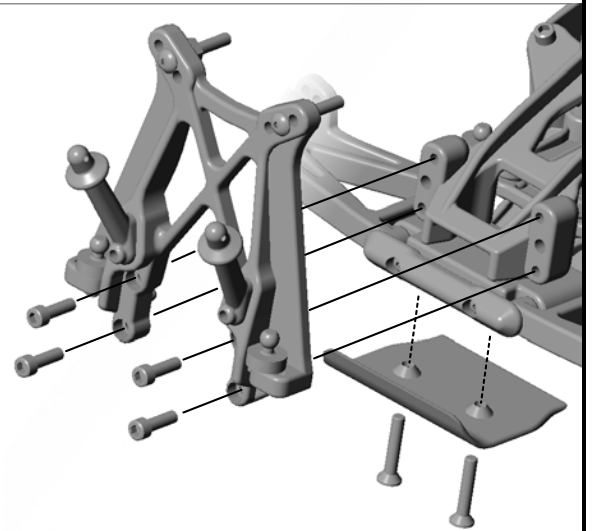

7

- x2 7253, 1408* 2.62" Turnbuckle
- x8 7230 Ball Cup, large
- x2 7101, 1417* 2.80" Turnbuckle

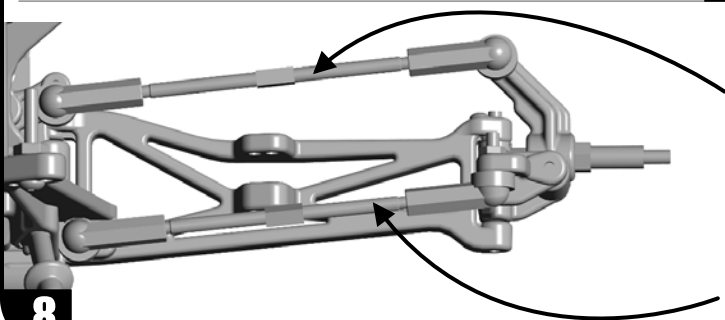

8

x2

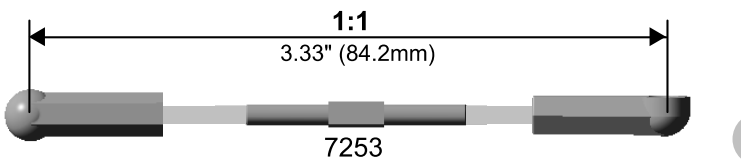
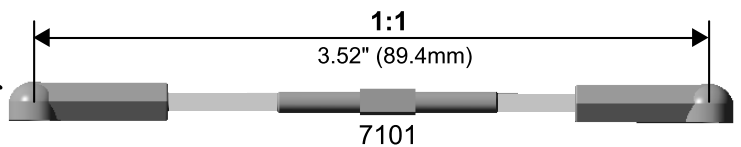

5

BAG C



◀1:1▶
● x12

6581
Carbide Diff Balls
3/32

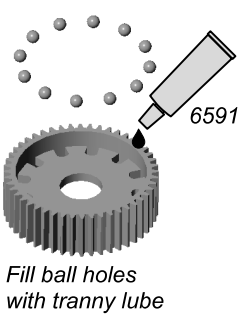

1

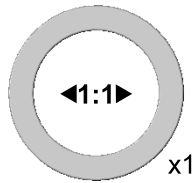

7666
Diff Ring



Apply tranny lube
to rim

2

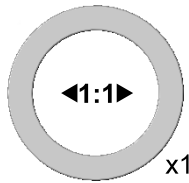

7666
Diff Ring

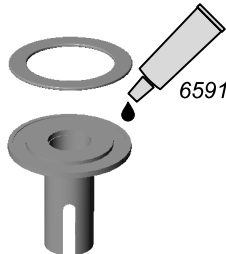

Apply tranny lube
to rim

3

◀1:1▶

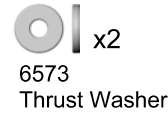

◀1:1▶
● x6

6574
Diff Thrust Ball,
5/64



6575
Diff Thrust Bolt

Apply Black Grease
to washer to hold balls
in place



4

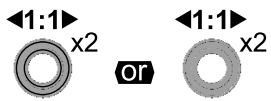

OR

◀1:1▶ x2

RTR 6597
Bushing,
5/32 x 5/16

6589
Ball Bearing,
5/32 x 5/16

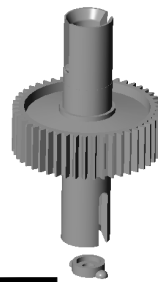
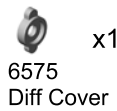
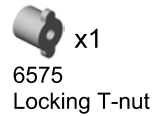

8

SETTING THE DIFFERENTIAL

As you tighten the diff bolt, you will notice the T-nut ears moving closer to the bottom of the outdrive slot. This compresses the spring behind the T-nut. The spring should be completely compressed at the same time the T-nut reaches the end of the slot.

Caution: Pay close attention to the feeling when the spring is completely compressed. Do not overtighten the bolt. When you feel the spring completely compressed, loosen the diff bolt 1/8 of a turn. Your diff should now operate smoothly with resistance as the outdrives move in opposite directions. **After you have driven the car once, recheck the diff setting.**

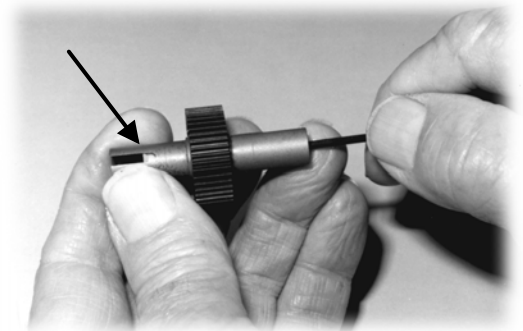

9



5

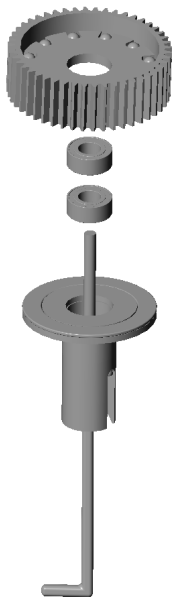

6



7



6

BAG C

10

11

12

13

14

Diff adjustment screw is on this end

15

right wing mount left wing mount

solid on one side hollow on both sides

locking adhesive

solid side here right wing mount

Racer's Tip:
Apply a small amount of locking adhesive to these holes to prevent screws from loosening.

Do not tighten this screw until page 9 step D8.

16

Press pads into spur gear.

BAG C

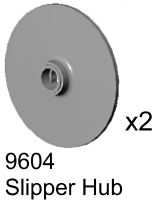

Install locknut until even with end of shaft. Then tighten 3 turns for kit slipper setting. Recheck after initial run.

Compress spring first.

17

18

BAG D

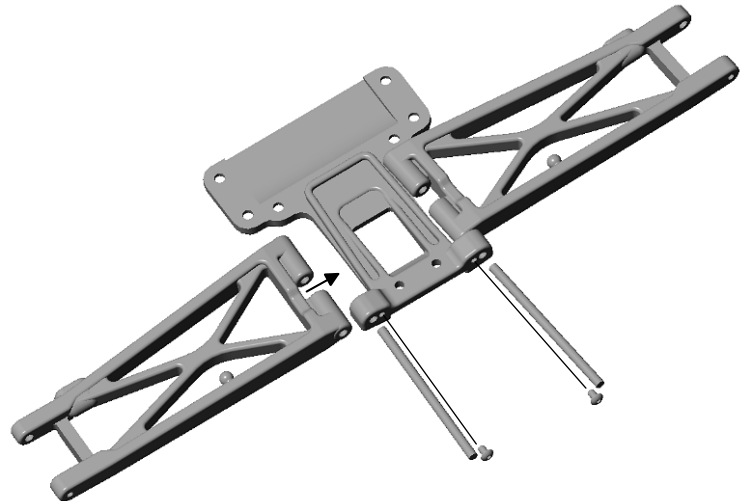
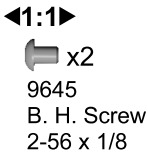
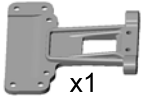

1

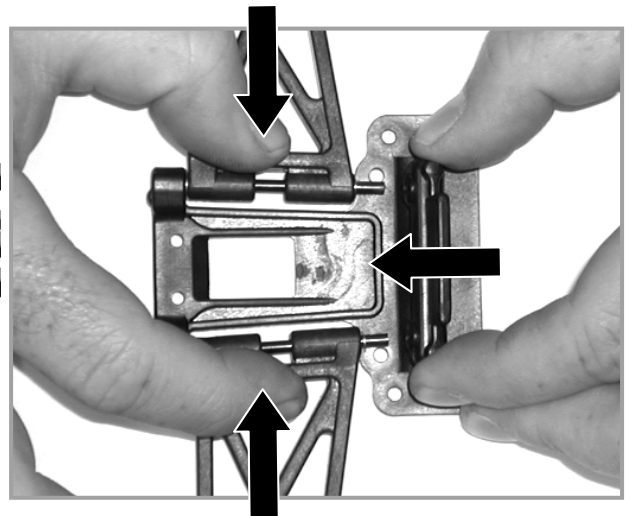
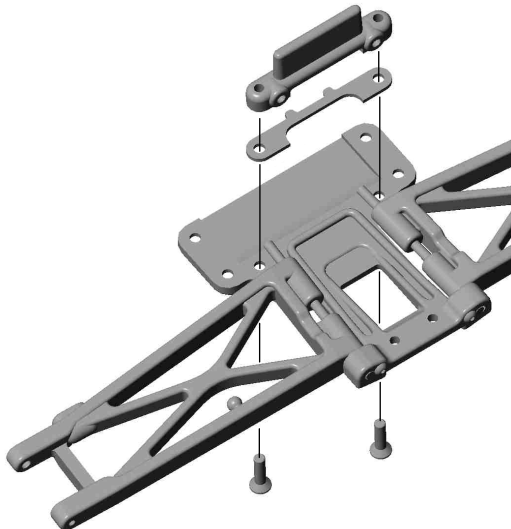
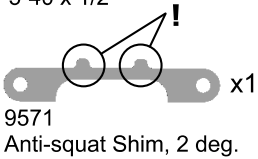
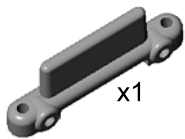

8

2

BAG D

◀1:1▶
9269
S. H. screw,
5-40 x 1/2

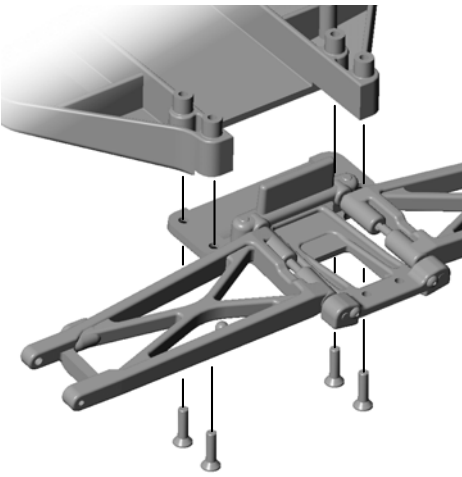

3

◀1:1▶
6272
Dust Cover,
foam

◀1:1▶
9564, 9565*
Brace

◀1:1▶
9630
washer

◀1:1▶
6273
Ball End,
long, silver

*Pre-tap holes with a
#6924 screw for easier
ball end installation*

◀1:1▶

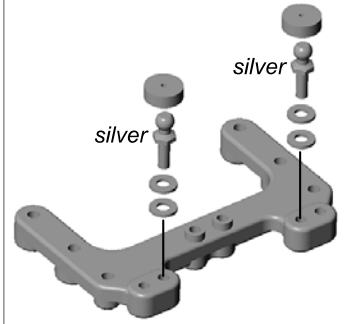
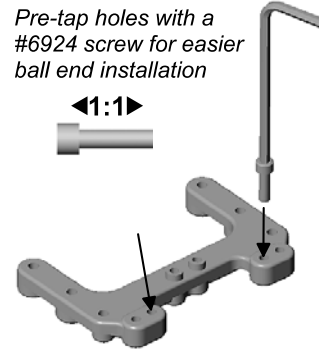

4

◀1:1▶
9643
S. H. Screw
5-40 x 7/16

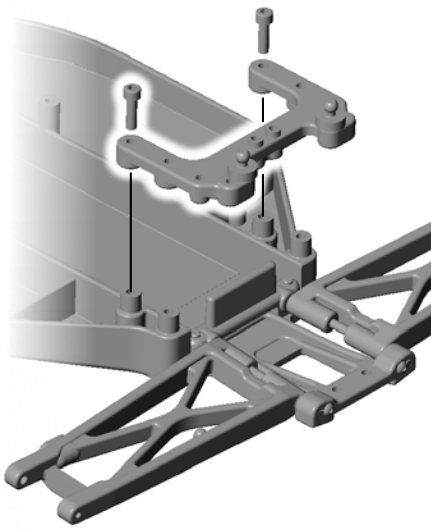

5

◀1:1▶
7413
B. H. screw,
4-40 x 3/4

◀1:1▶
7260
4-40 nut

◀1:1▶
7444, 7445*
Rear Shock Tower



6

◀1:1▶
9644
S. H. screw,
5-40 x 9/16

◀1:1▶
9643
S. H. screw,
5-40 x 7/16

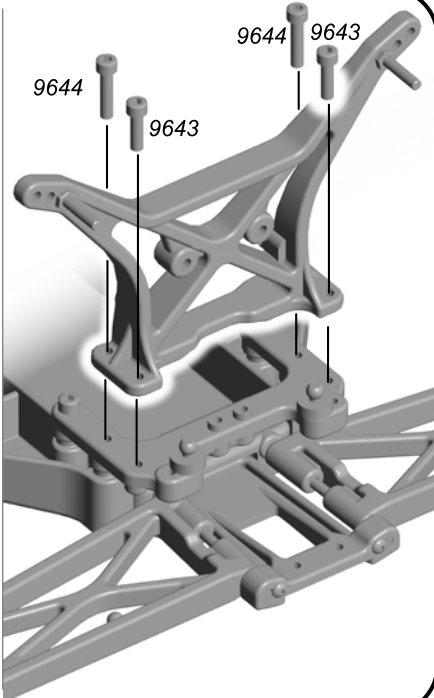

7

◀1:1▶
6925
S. H. screw,
4-40 x 1/2

◀1:1▶
6915
F. H. screw,
4-40 x 5/8

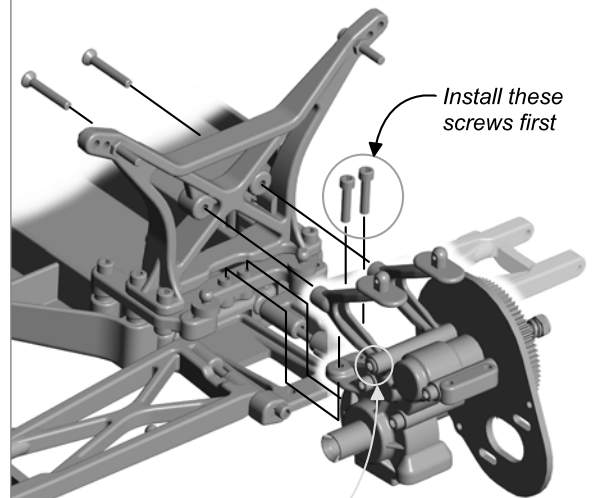

*Install these
screws first*

*Tighten screw
from step C15*

8

9

BAG D

- 1:1** 6919 x2
B. H. screw, 4-40 x 5/16
- 1:1** 6922 x2
F. H. screw, 4-40 x 1/2
- 9575 x1
Motor Guard

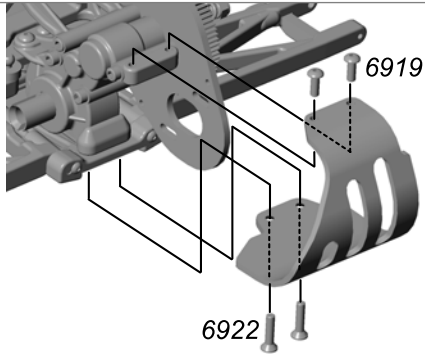

9

BAG E

- 1:1** 6272 x2
Dust Cover, foam
- 1:1** 3858 x2
Ball End, black
- 9584 x1
Rear Hub Carriers, left and right
- 1:1** 7260 x2
Plain Nut

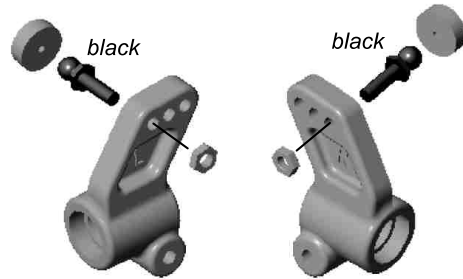

1

RTR only x2

- 1:1** 7377 x2
Bearing Spacer
- 1:1** 3977, 6906* x4
Ball Bearing, 3/16 x 3/8

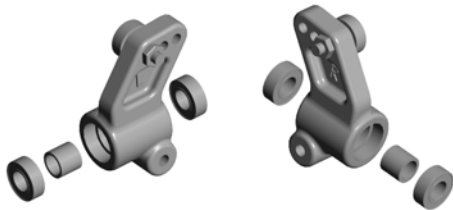

2

- 9670 x1
Rear Axle
- 7462 x1
Dogbone
- 1:1** 7369 x1
Roll Pin
- 1:1** 7368 x2
3/16 Axle Shim
- 1:1** 9608, 9608B* x1
Wheel Spacer
- 1:1** 5407 x1
O-ring



GO TO STEP 6 ON NEXT PAGE

6

3

BAG E

KIT ONLY

- 9598 x2
MIP CVD Axle
- 7381 x2
CVD Coupling

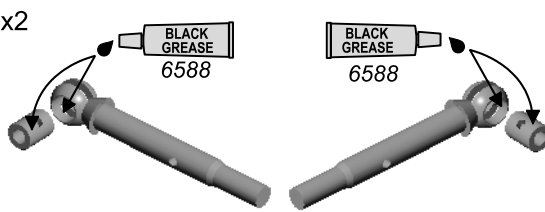

3

- 7453 x2
CVD Bone
- 1:1** 7381 x2
CVD Cross Pin
- 1:1** 7381 x2
Set Screw

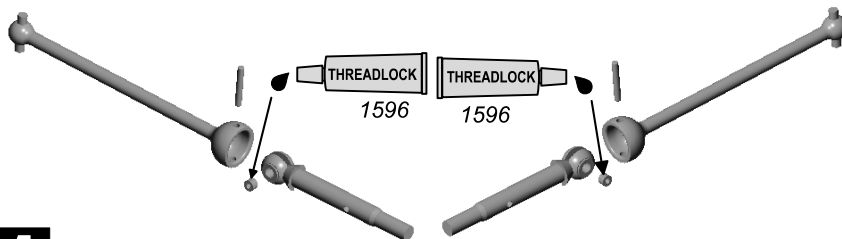

- 1596 x2
THREADLOCK

10

4

KIT ONLY

- 9608, 9608B* x2
Wheel Spacer
- 1:1** 7368 x4
3/16 Axle Shim
- 1:1** 7369 x2
Roll Pin

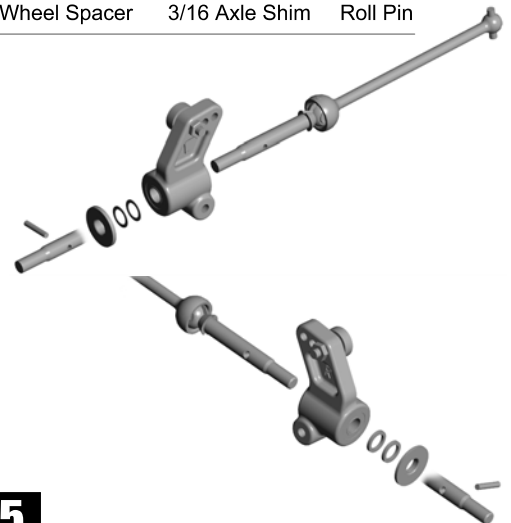

5