

FINAL ASSEMBLIES

stock

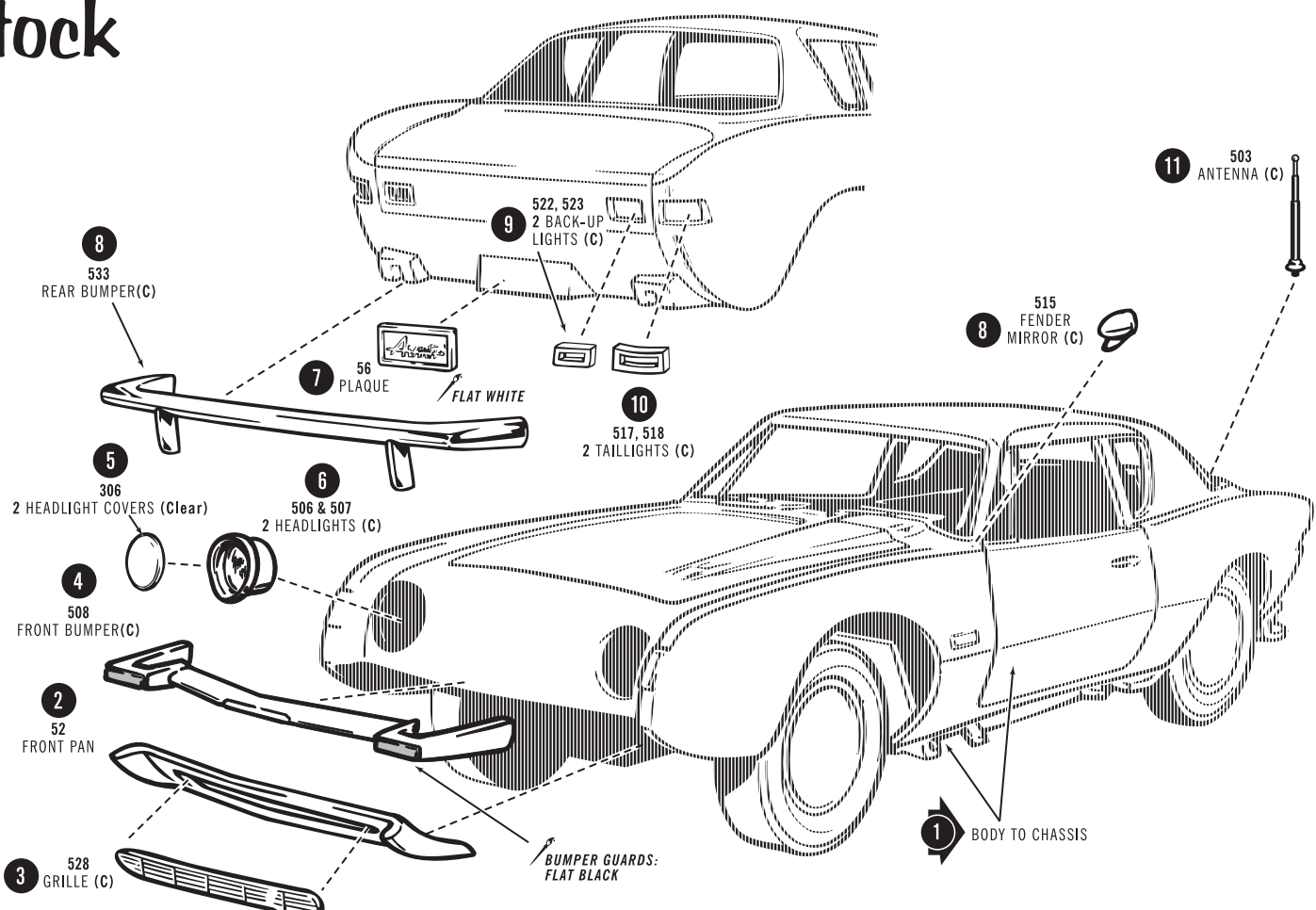

racing

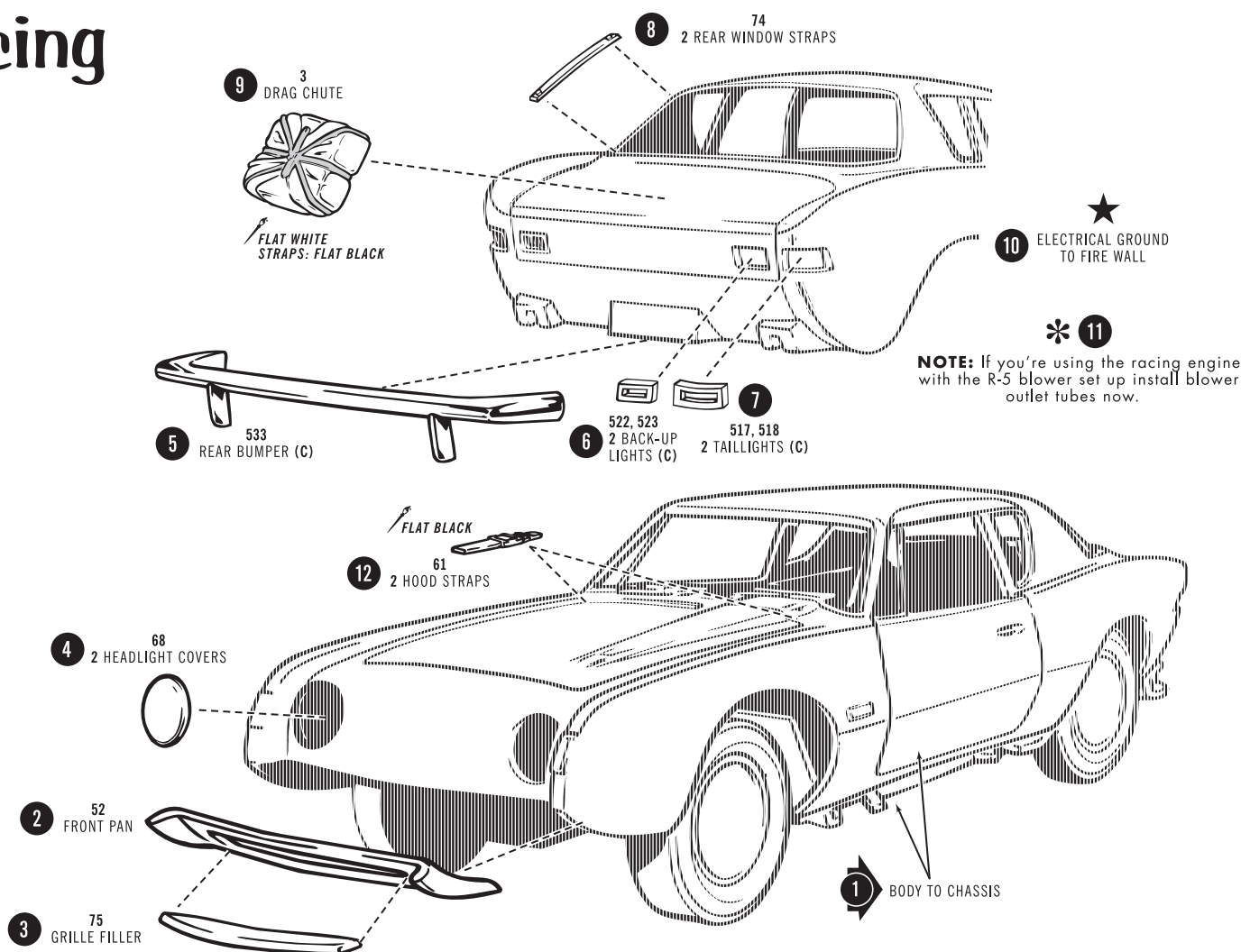

custom

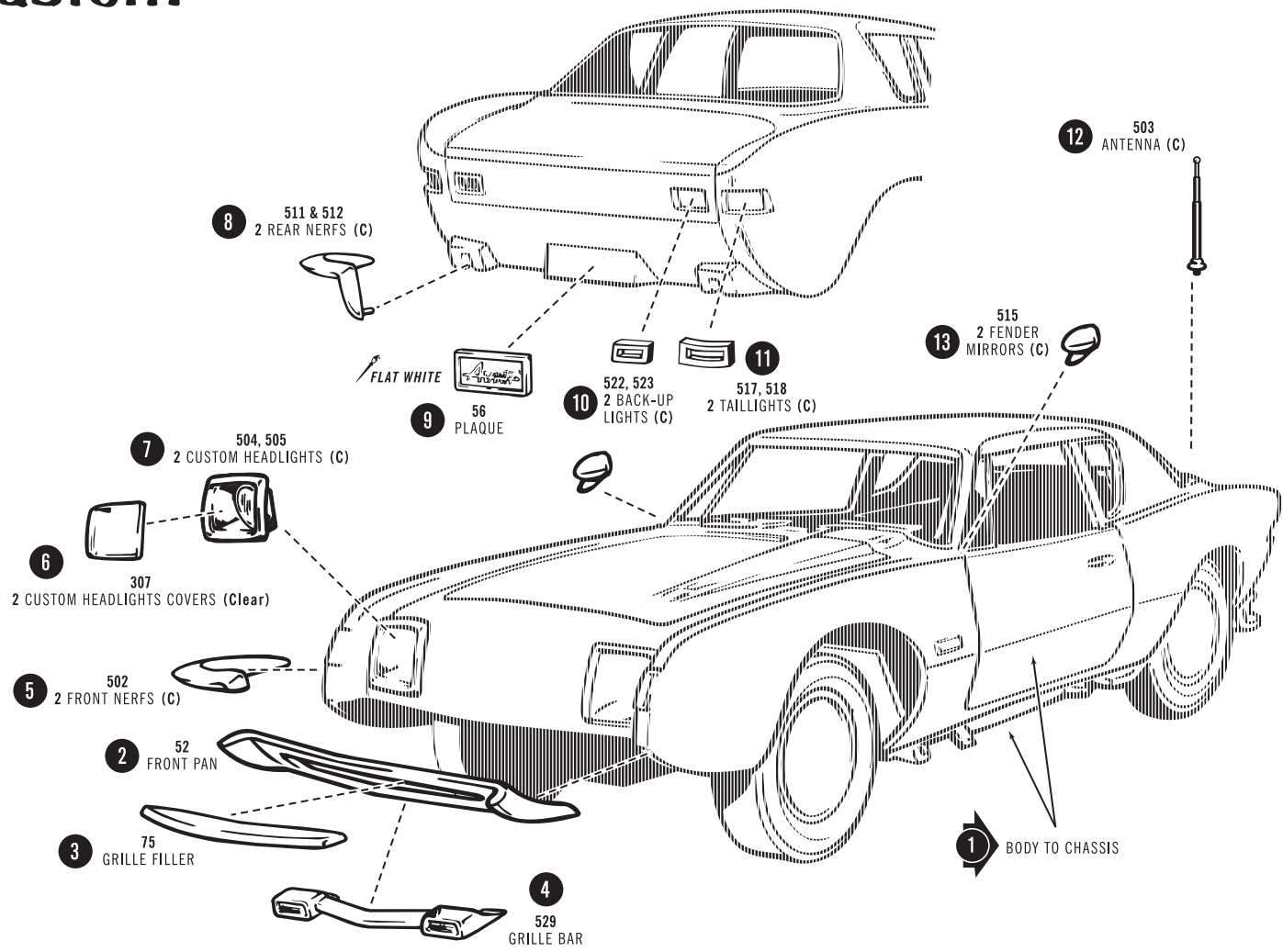

1963 AVANTI EXTERIOR COLORS

- Black
- White
- Iridescent Turquoise
- Iridescent Gold
- Iridescent Red
- Iridescent Gray

INTERIOR COLOR SELECTION

Here are some popular color schemes which were available for the 1962 Avanti. Select one which will complement whatever exterior color you choose to paint your model.

OVERALL: ORANGE	OVERALL: GREEN	OVERALL: LIGHT BLUE
UPPER/DASH: COPPER	UPPER/DASH: GREEN	UPPER/DASH: IVORY
CARPET: DARK ORANGE	CARPET: DARK GREEN	CARPET: MEDIUM BLUE
OVERALL: TOPAZ	OVERALL: TAN	OVERALL: BEIGE
UPPER/DASH: TOPAZ	UPPER/DASH: BEIGE	UPPER/DASH: IVORY
CARPET: BRASS	CARPET: DARK BROWN	CARPET: GOLD



This model produced by permission of the Studebaker National Museum, South Bend, Indiana. Visit our website: www.studebakermuseum.org. Firestone and the F-Shell Logo are registered trademarks of Bridgestone Brands, LLC and are used with permission. AMT and design is a registered trademark of Round 2, LLC. ©2022 Round 2, LLC, South Bend, IN 46628 USA. Product and packaging designed in the USA. Made in China. All rights reserved.



AVANTI



3 in 1

Trophy SERIES

AUTHENTIC 1/25TH SCALE MODEL

READ THIS BEFORE YOU BEGIN

This kit may be built **ONE OF THREE WAYS**. Look over this instruction sheet carefully before you begin building. You may decide to combine parts from the different versions shown, or use parts from other AMT kits for a really personalized model. After you've planned your car, follow the assembly instructions **WITHOUT CEMENTING** the parts together. This will familiarize you with the fit and assembly of parts.

For the neatest job, the various sub-assemblies and components should be painted before any chrome parts are attached for example: in building the customer version, all non-chrome parts such as scoops,

panels, skirts, etc. (except the clear window assembly) should be cemented in place and the body should then be painted as a unit for a smooth, professional-looking finish.

AMT kits are molded from the finest high-impact styrene plastic. Use only paint and cement made for styrene plastic. Trim off any excess plastic before cementing parts together. When attaching **CHROME** parts (indicated by "C" after part names), scrape plating away where cement is to be applied. Use just enough cement to join plastic parts and especially careful not to smear cement on exposed surfaces.



A1312-200

