

FINAL ASSEMBLIES • DECAL/STICKER PLACEMENT

STOCK/RALLY

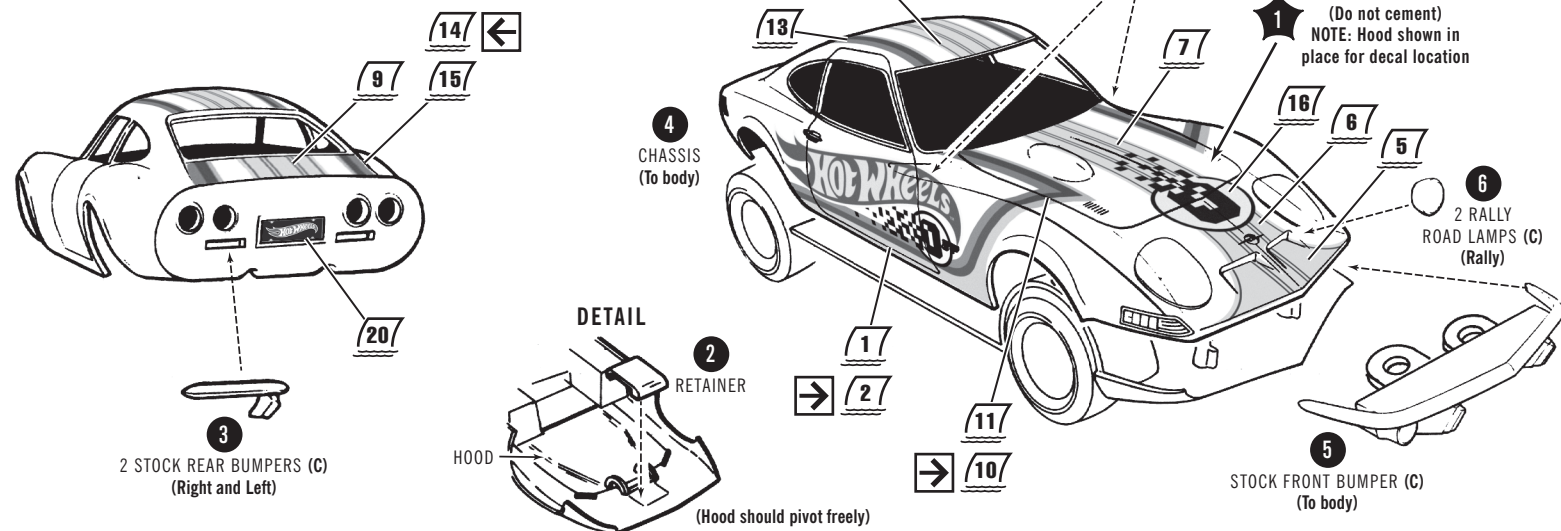

DRAG

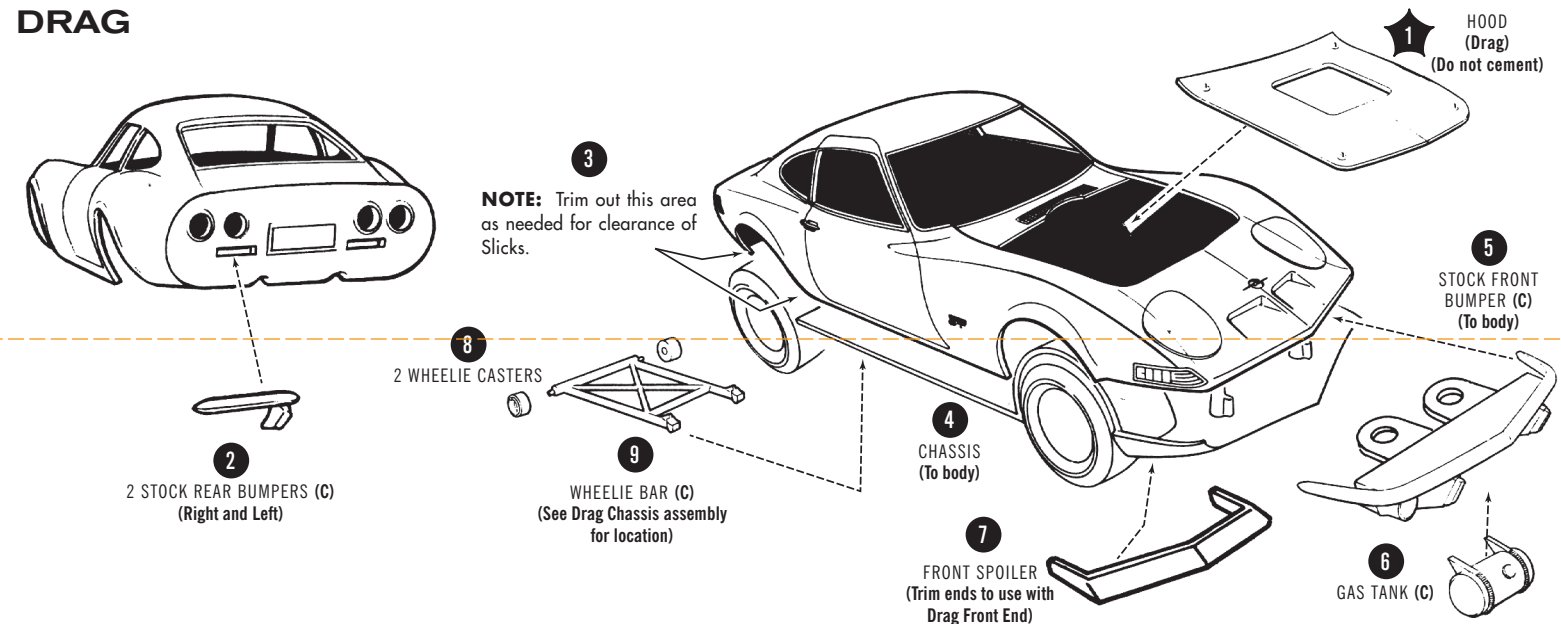

CUSTOM

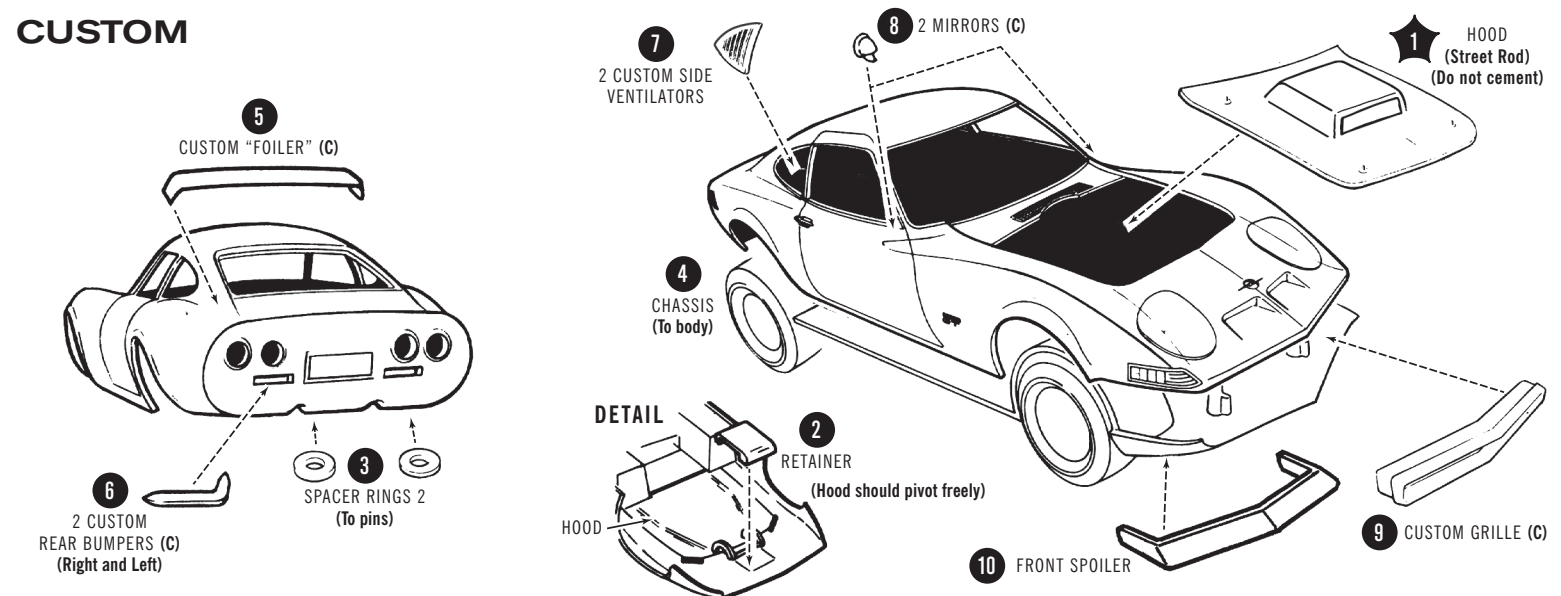

READ THIS BEFORE YOU BEGIN

This kit may be built more than one way. Look over this instruction sheet carefully before you begin building. You may decide to combine parts from the different versions shown, or use parts from other AMT® kits. After you've planned your car, follow the assembly instructions and "TEST FIT" the parts without cementing. This will familiarize you with the location of parts.

For best results, the various sub-assemblies and components should be painted before any chrome parts are attached. For example: When attaching non chrome engine parts, it is best to cement them in place and paint as a unit. AMT® kits are molded from the finest high-impact styrene plastic. Use only paint and cement made for styrene. Trim excess plastic from parts before joining. When attaching "chrome" or painted parts, scrape plating or paint

away where parts are to be joined. Cement all parts unless otherwise indicated by the instructions. Use just enough cement to join parts and be careful not to smear cement on exposed surfaces. Built according to the instructions on this sheet, you should have no trouble assembling your kit. Just FOLLOW THE NUMBERS as the instructions are numbered in order of assembly. NOTE: (C) Indicates "chrome" parts.

STOCK • CUSTOM 1.9 LITER 4-CYL. OPEL ENGINE

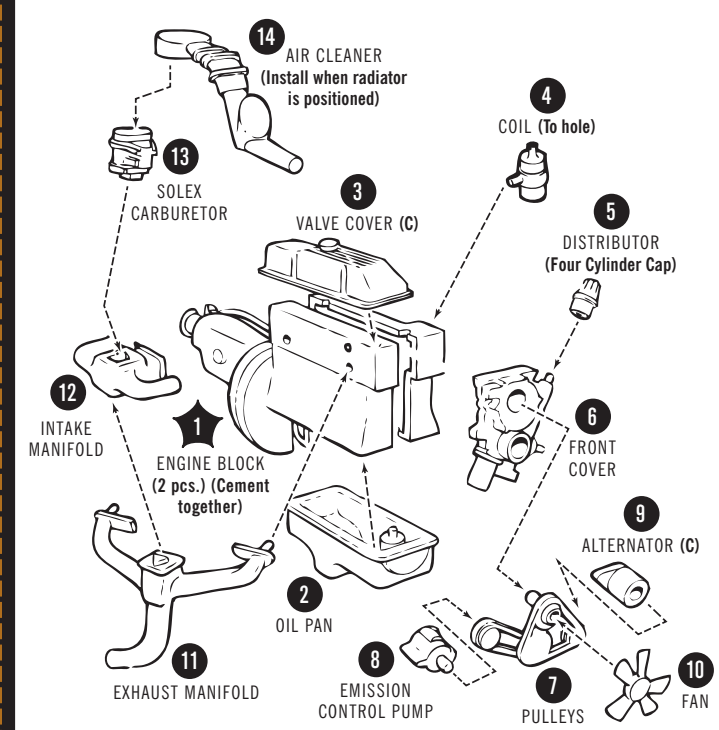

STREET ROD • DRAG BUICK V6

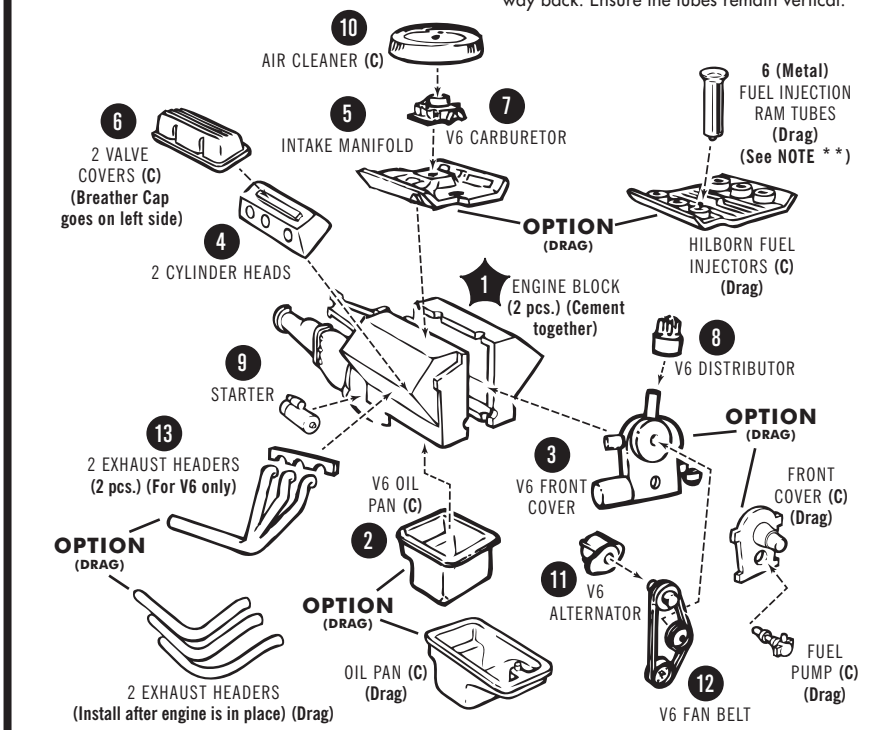

HOT WHEELS™ and associated trademarks and trade dress are owned by, and used under license from, Mattel. ©2022 Mattel. Opel GT, emblems, and vehicle model body designs are Adam Opel AG trademarks used under license to Round 2, LLC. Goodyear (and Winged Foot Design) and Blimp Design are trademarks of The Goodyear Tire & Rubber Company used under license by Round 2, LLC, South Bend, IN 46628. Copyright 2022 The Goodyear Tire & Rubber Company. AMT and design is a registered trademark of Round 2, LLC. ©2022 Round 2, LLC, South Bend, IN 46628 USA. Product and packaging designed in the USA. Made in China. All rights reserved. HOT WHEELS™ et les marques afférentes ainsi que leur représentation sont des marques de Mattel, utilisées avec leur autorisation. ©2022 Mattel. Opel GT, les emblèmes et les conceptions de carrosserie de modèle de véhicule sont des marques commerciales d'Adam Opel AG utilisées sous licence par Round 2, LLC. Goodyear (et Winged Foot Design) et Blimp Design sont des marques déposées de The Goodyear Tire & Rubber Company utilisées sous licence par Round 2, LLC, South Bend, IN 46628. Copyright 2022 The Goodyear Tire & Rubber Company. AMT et le design sont des marques déposées de Round 2, LLC. ©2022 Round 2, LLC, South Bend, IN 46628 USA. Produit et emballage conçus aux USA. Fabriqué en Chine. Tous les droits sont réservés.

INTERIOR

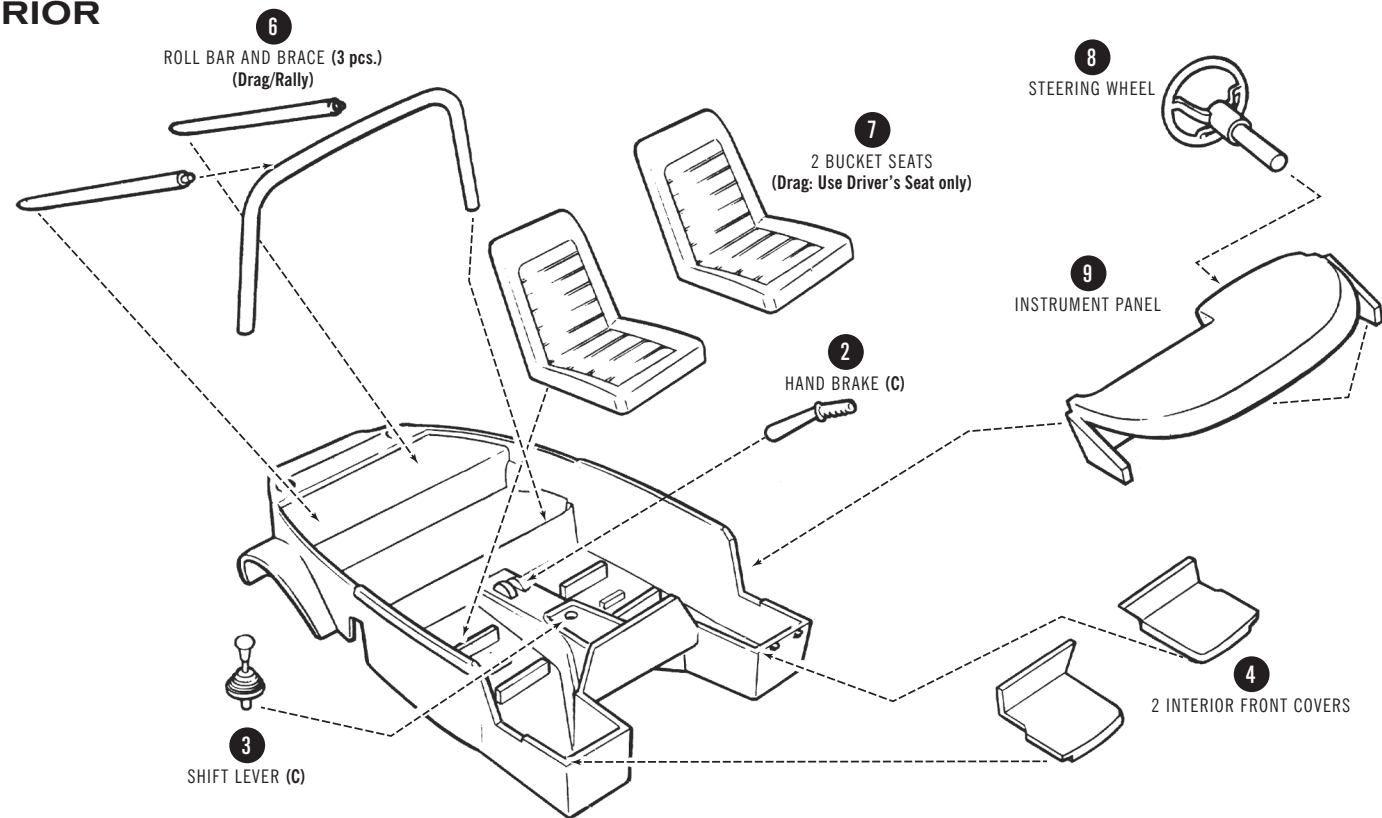

CHASSIS STOCK

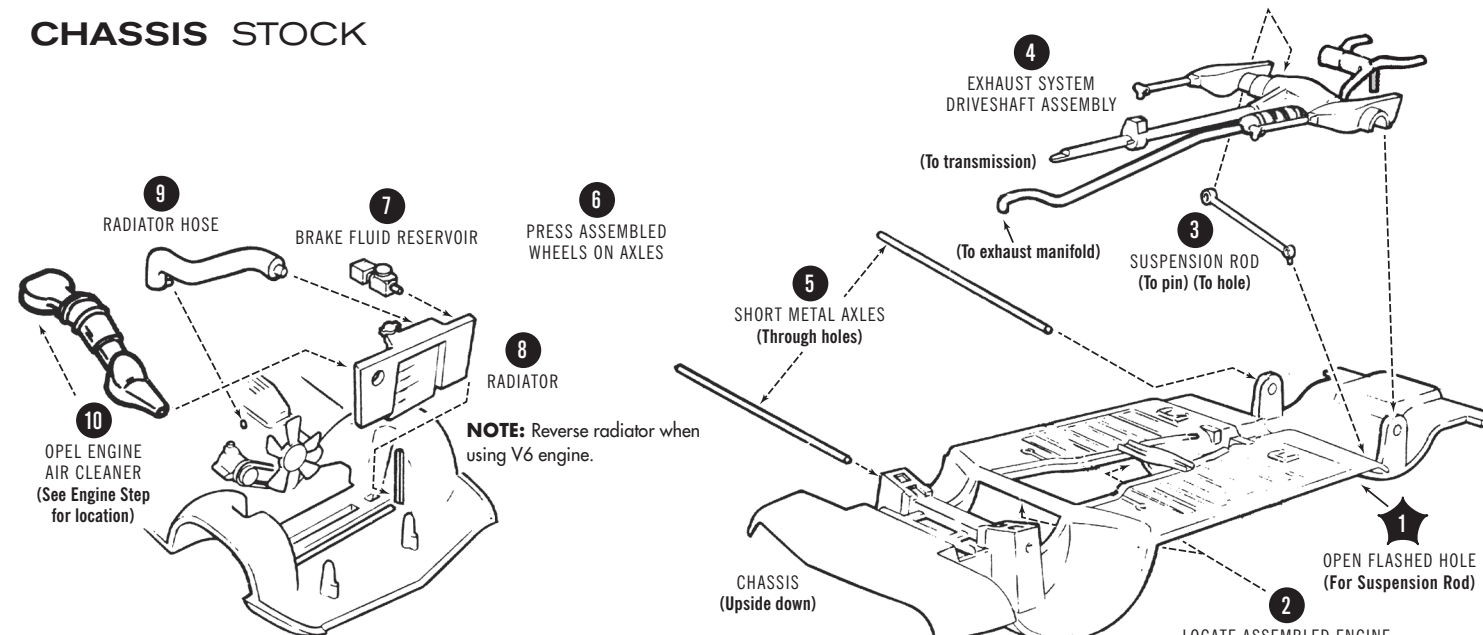

WHEELS STOCK/RALLY

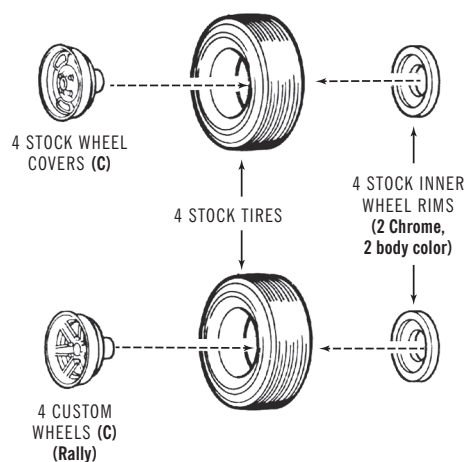

DRAG

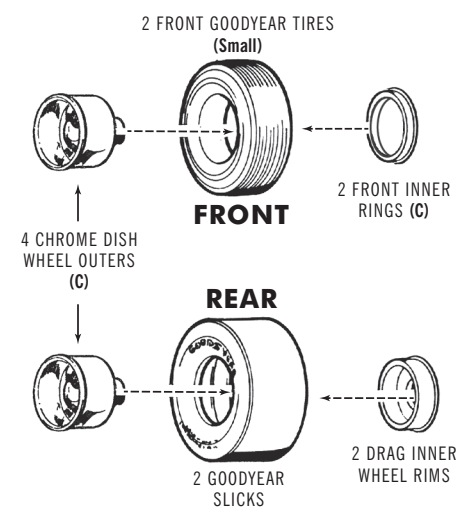

CUSTOM

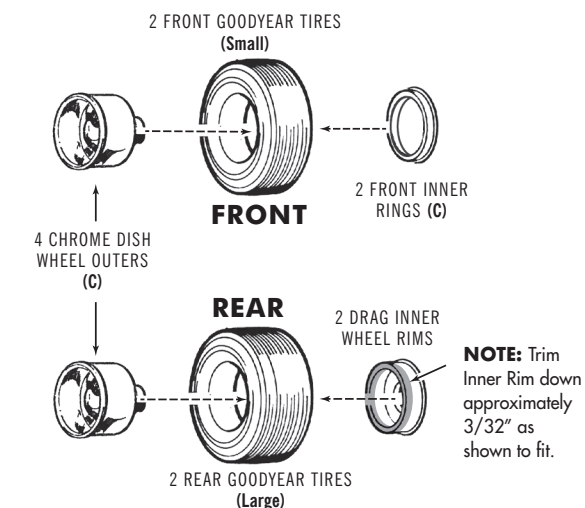

CHASSIS DRAG

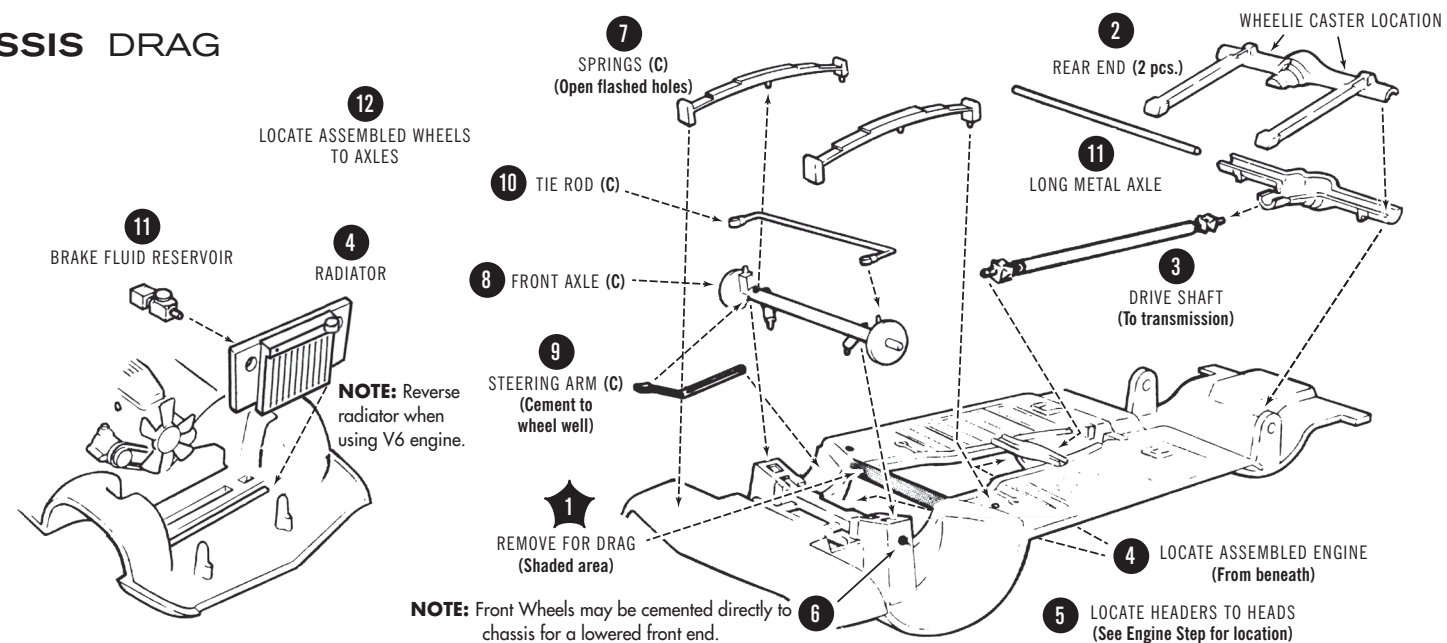

BODY

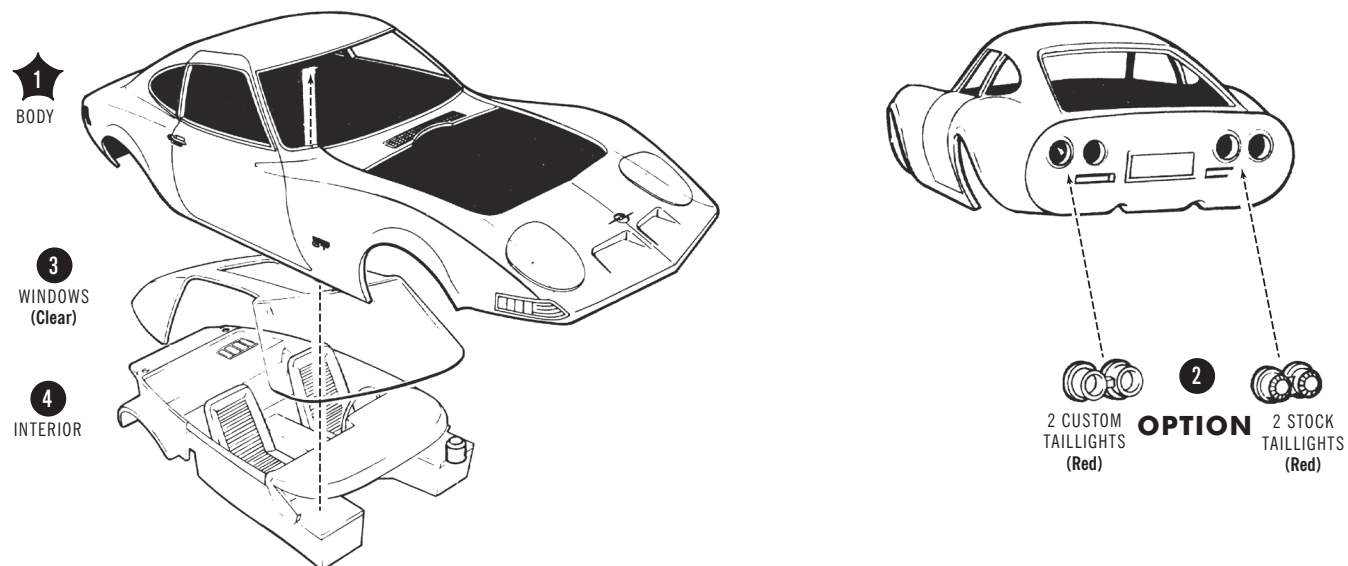

CHASSIS RALLY/CUSTOM/STREET ROD

