

PART NUMBERS

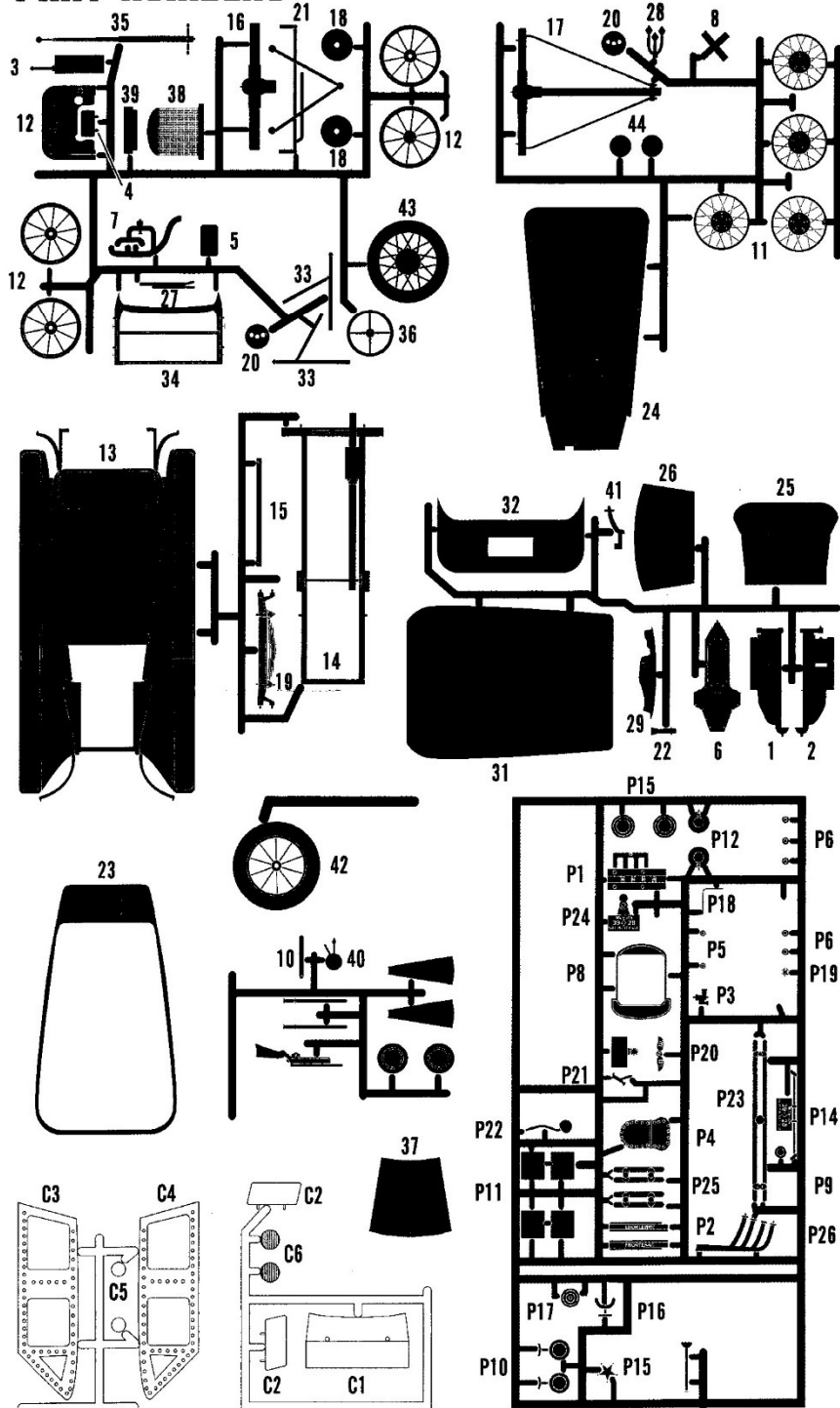

27" T" Vintage Police Car

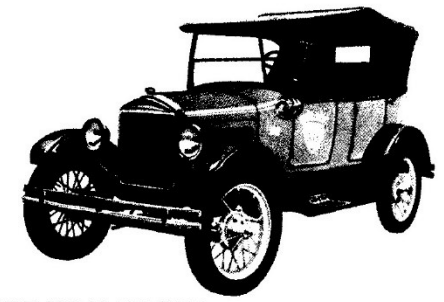

READ THIS BEFORE YOU BEGIN
Cement all parts unless otherwise indicated.

Look over this instruction sheet carefully before you begin building. Follow the assembly instructions and "test-fit" the part without cementing. This will familiarize you with the location of parts.
 For the best results, the various sub-assemblies and components should be painted before any chrome parts are attached. For example: When attaching non-chrome body accessories, it is best to cement them in place and paint the body as a unit.
 AMT kits are molded from the finest high-impact styrene plastic. Use

only paint and cement made for styrene. Trim excess plastic from parts before joining. When attaching CHROME parts, scrape plating away where parts are to be joined. Use just enough cement to join parts, and be careful not to smear cement on exposed surfaces.
 Built according to the instructions on this sheet, you should have no trouble assembling your kit. Just FOLLOW THE NUMBERS, as parts are numbered in order of assembly. (C) INDICATES CHROME PARTS.

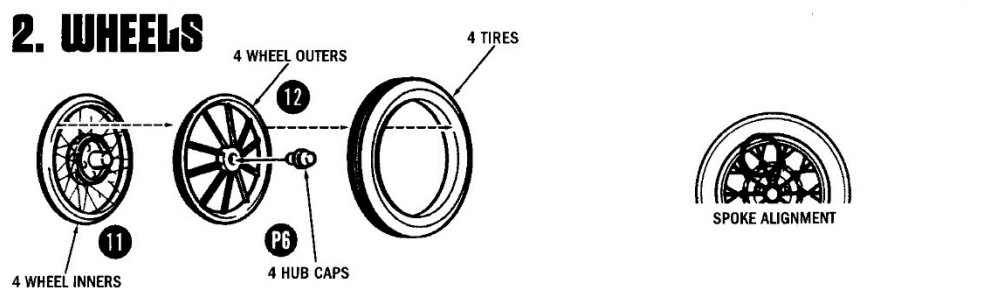
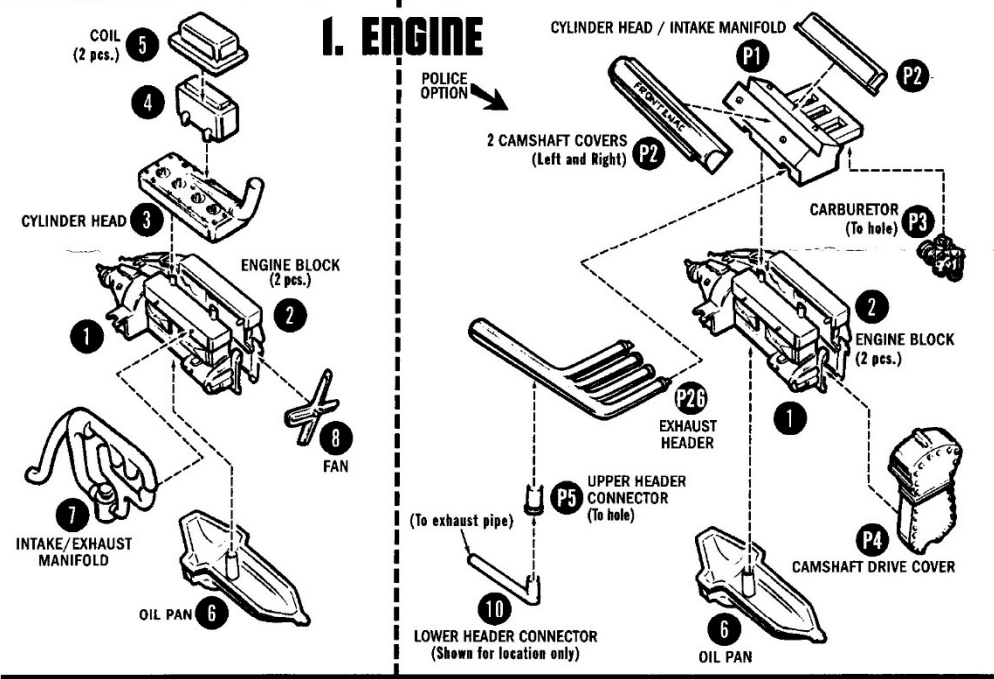

3. CHASSIS

NOTE: If using pursuit car optional engine, install engine first then hook up lower header connector to exhaust pipe.

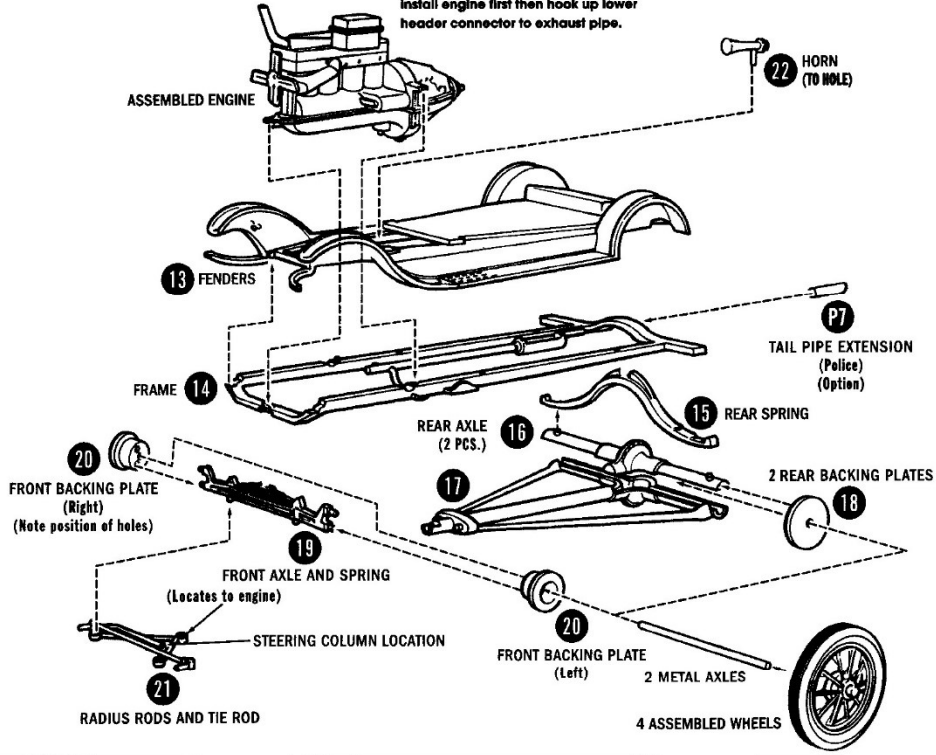

4. INTERIOR

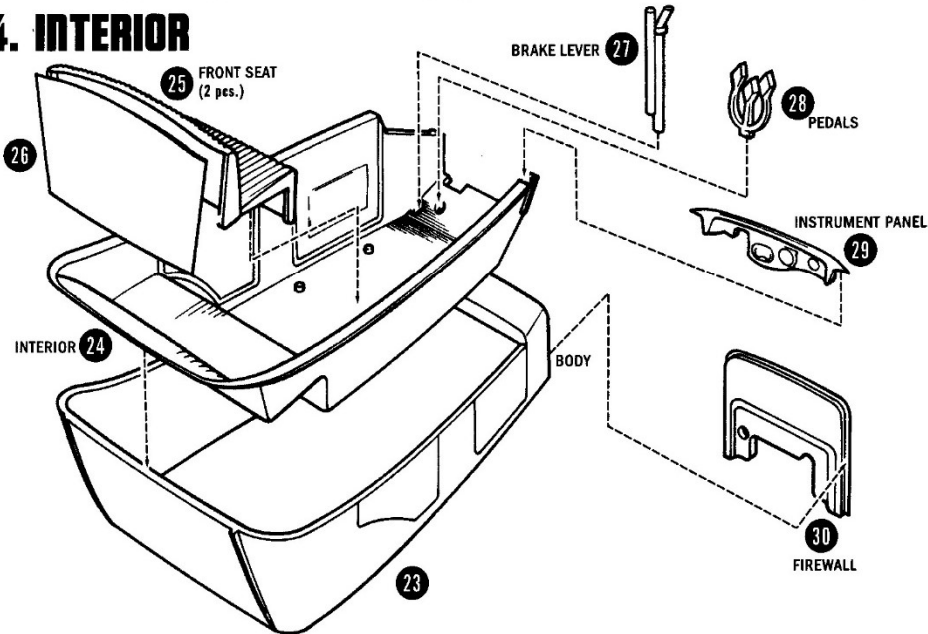

5. BODY

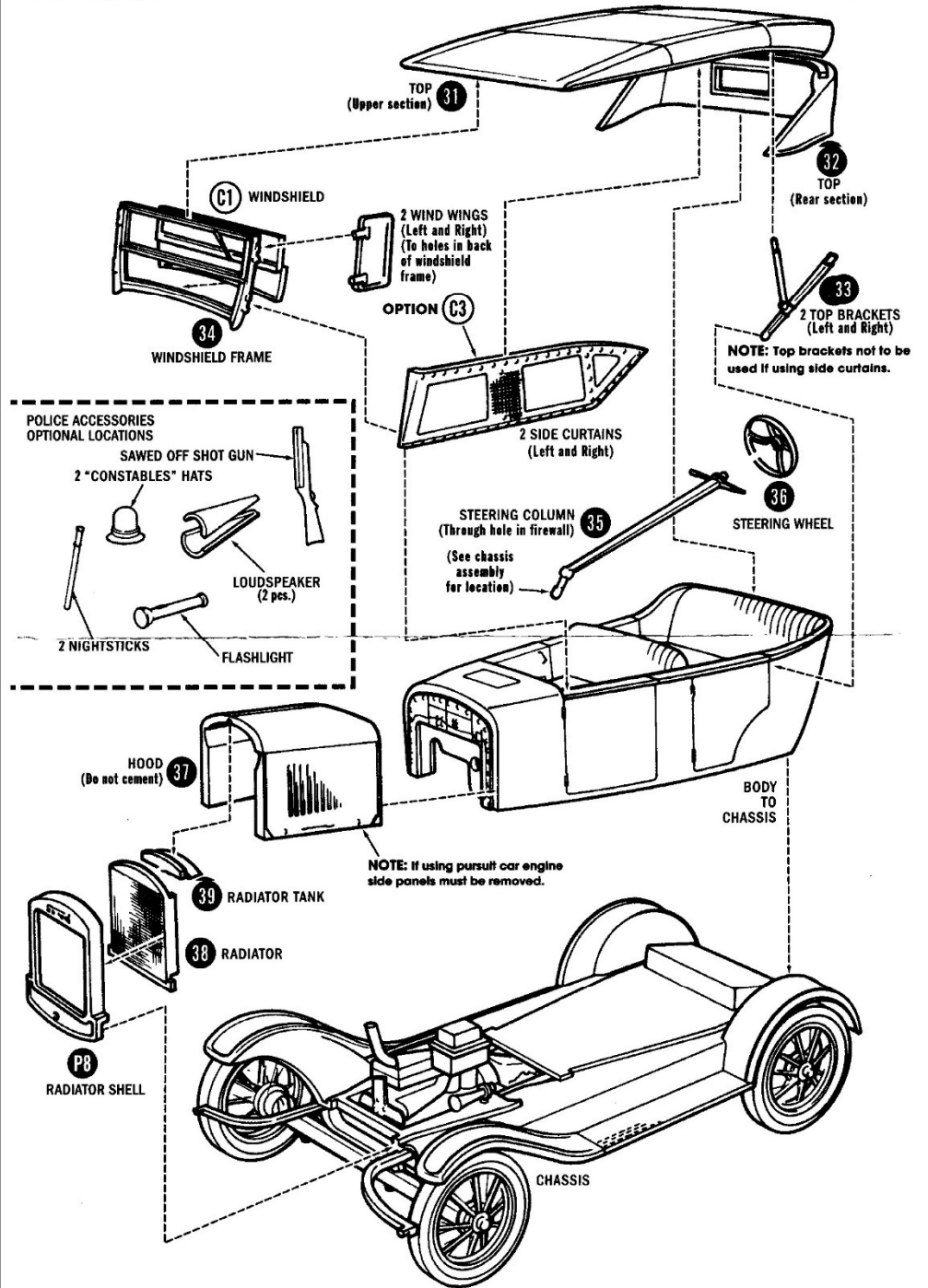

6. FINAL ASSEMBLIES

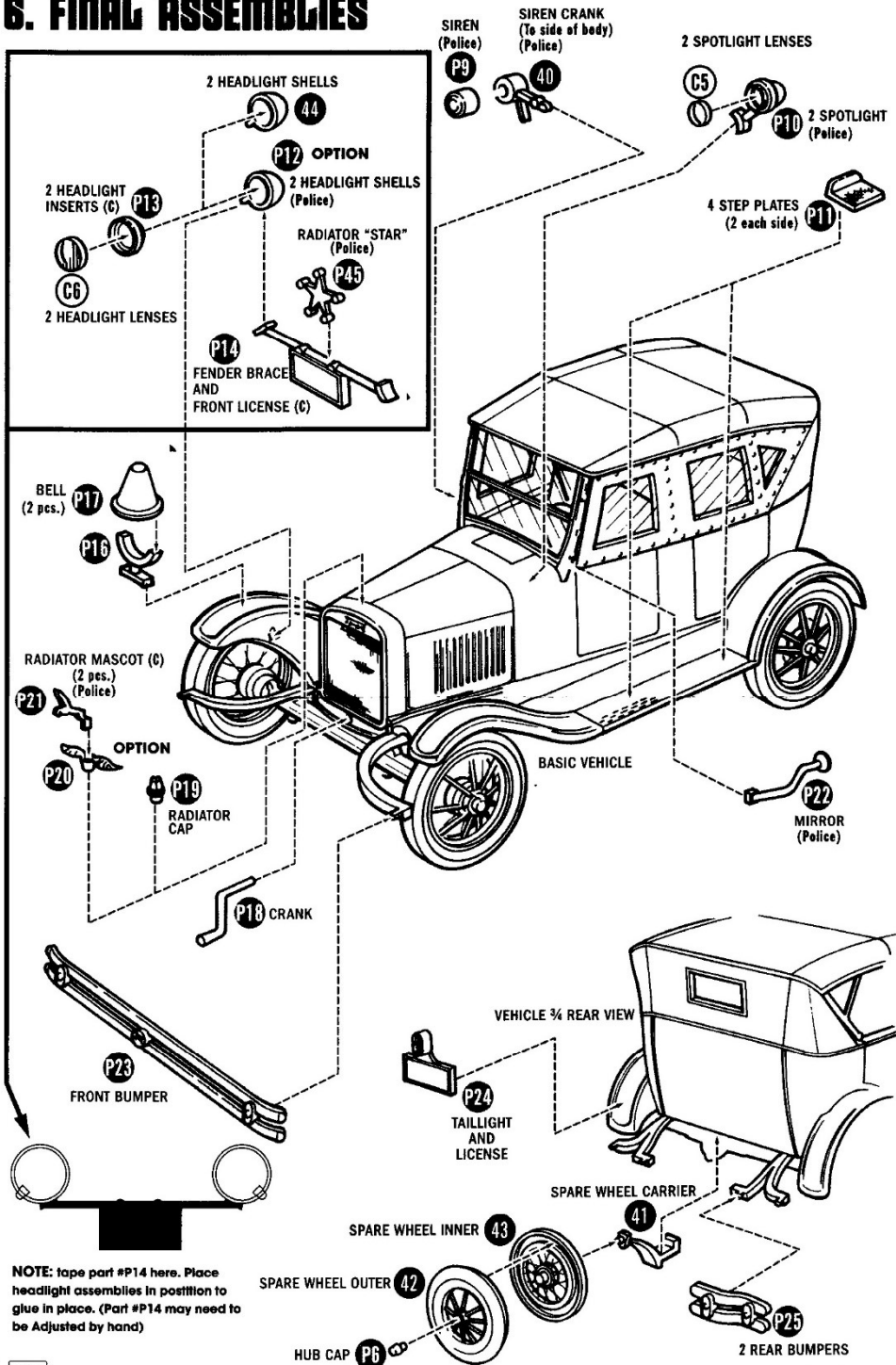

NOTE: tape part #P14 here. Place headlight assemblies in position to glue in place. (Part #P14 may need to be Adjusted by hand)



Collect these Fab Ford Kits and More!

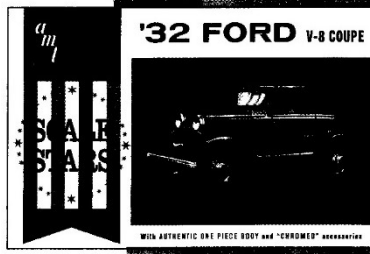
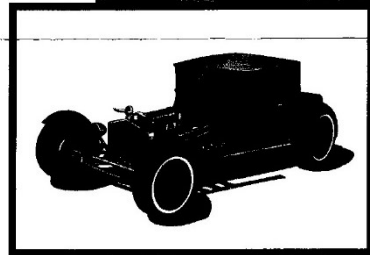
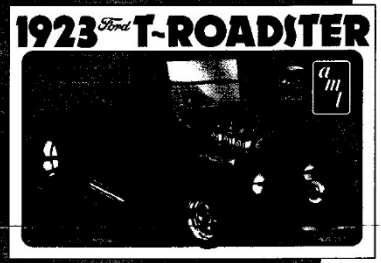
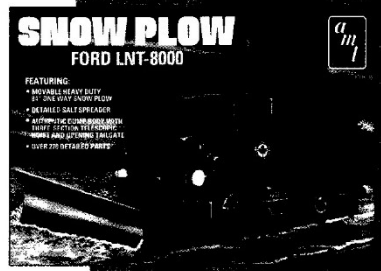
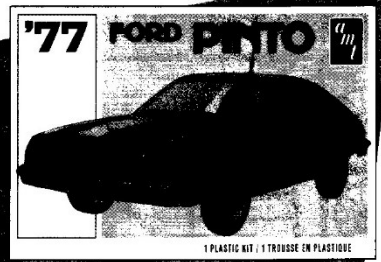

...only from the KATS at AMT!

