

TRX4[®]

Front Assembly

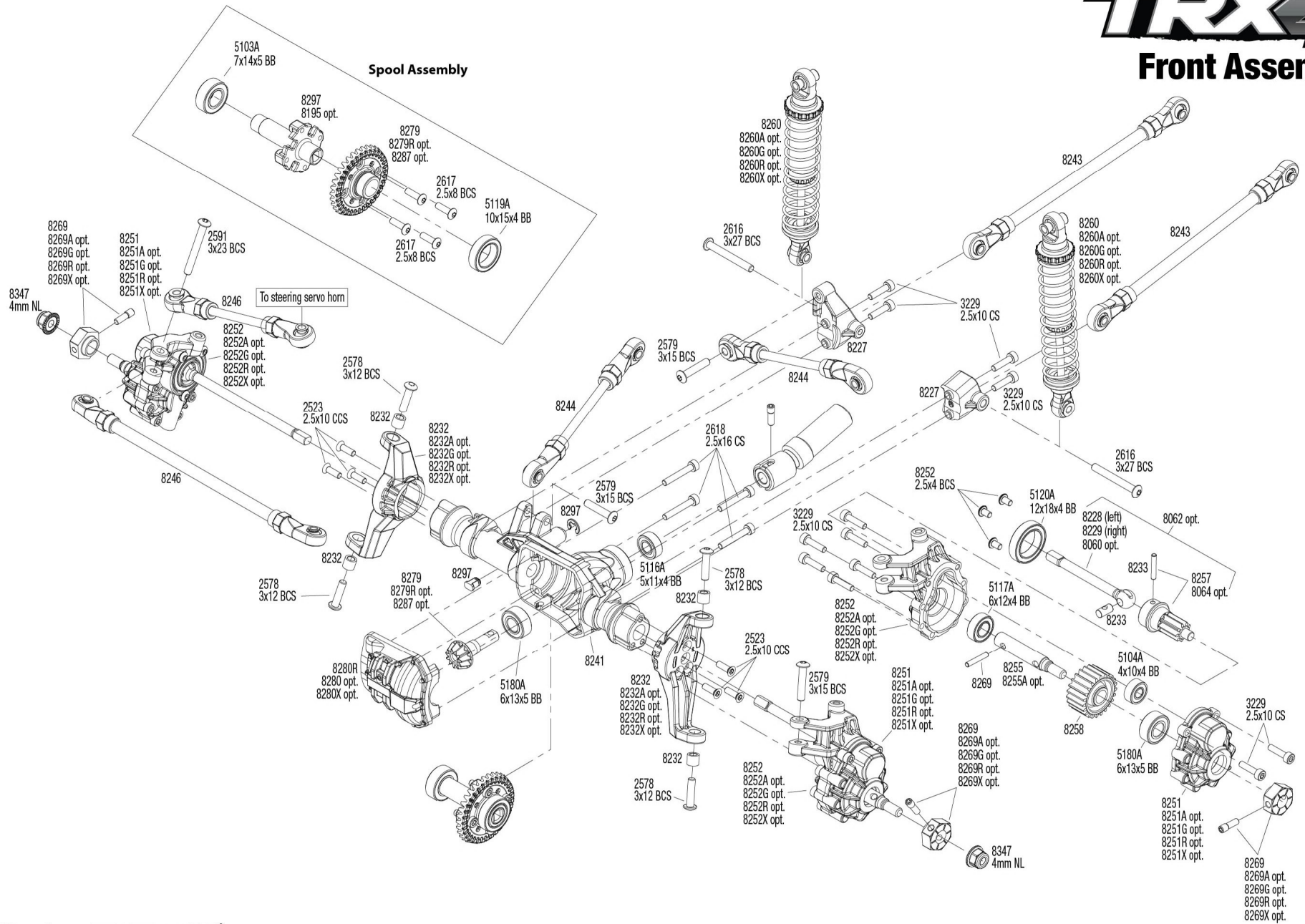

See Parts List for a complete listing of optional accessories.

Specifications on this page are subject to change without notice. Every attempt has been made to ensure the accuracy of this drawing; however, Traxxas cannot be held responsible for typographical or other errors.

REV 211215-R07



Link Dimensions

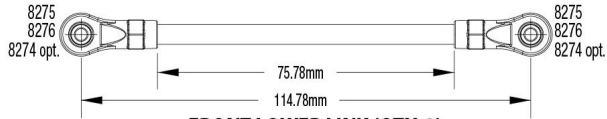

FRONT LOWER LINK (QTY. 2)

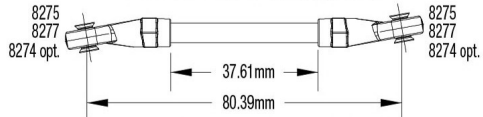

FRONT UPPER LINK (QTY. 1)

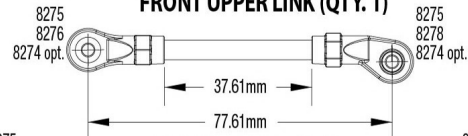

PANHARD BAR (QTY. 1)



REAR LOWER LINK (QTY. 2)

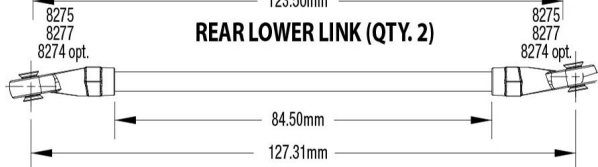

REAR UPPER LINK (QTY. 2)

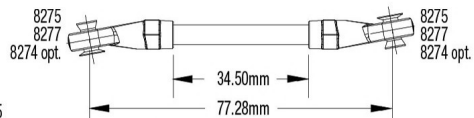

STEERING LINK (QTY. 1)

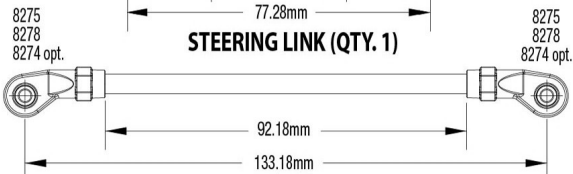

DRAG LINK (QTY. 1)

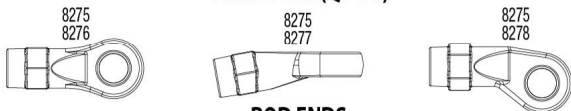

ROD ENDS

For standard hollow ball replacement, use part #5349.



Modular Assembly

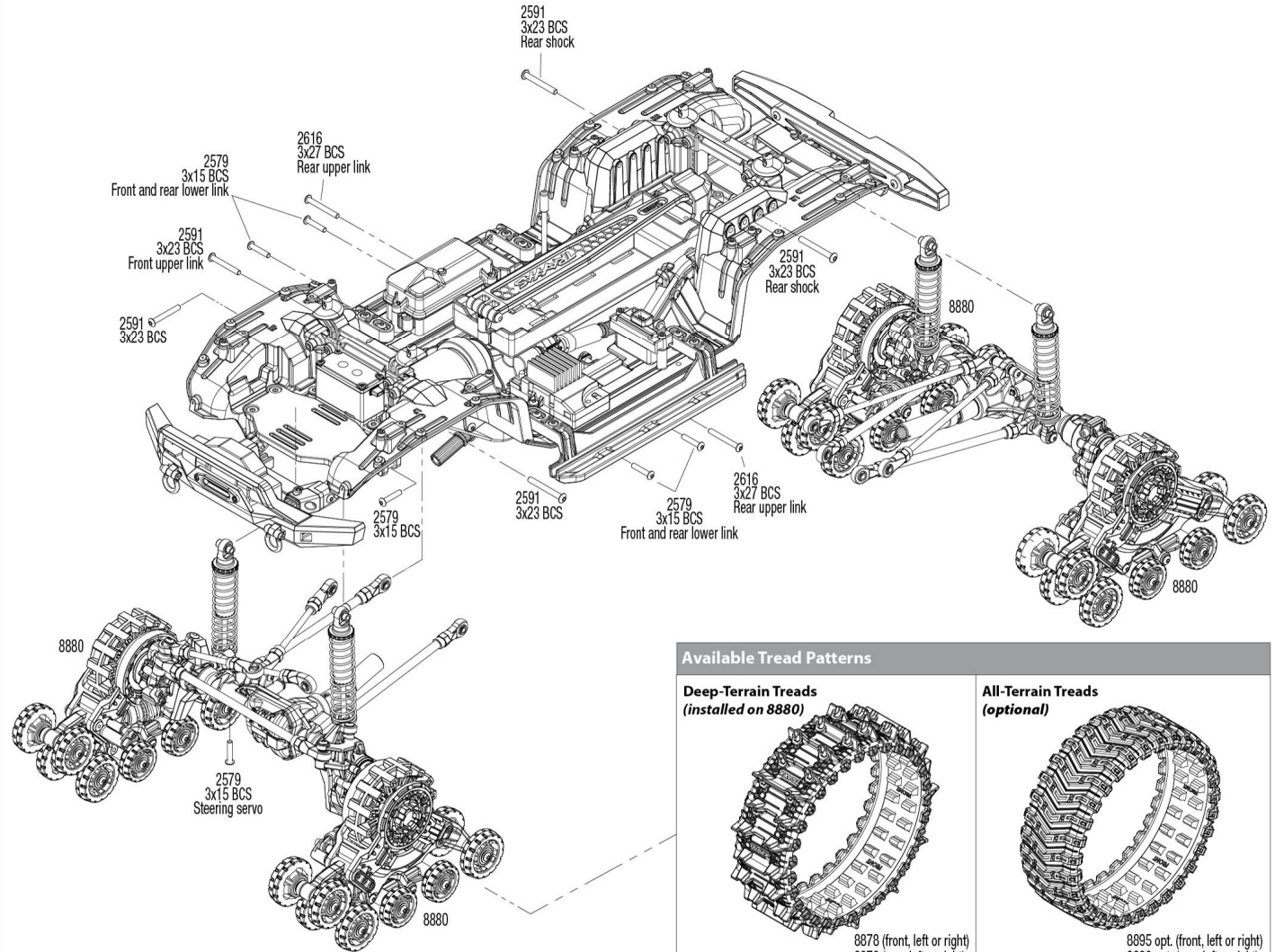

Available Tread Patterns	
<p>Deep-Terrain Treads (installed on 8880)</p> <p>8878 (front, left or right) 8879 (rear, left or right)</p>	<p>All-Terrain Treads (optional)</p> <p>8895 opt. (front, left or right) 8896 opt. (rear, left or right)</p>

See Parts List for a complete listing of optional accessories.

Specifications on this page are subject to change without notice. Every attempt has been made to ensure the accuracy of this drawing; however, Traxxas cannot be held responsible for typographical or other errors.

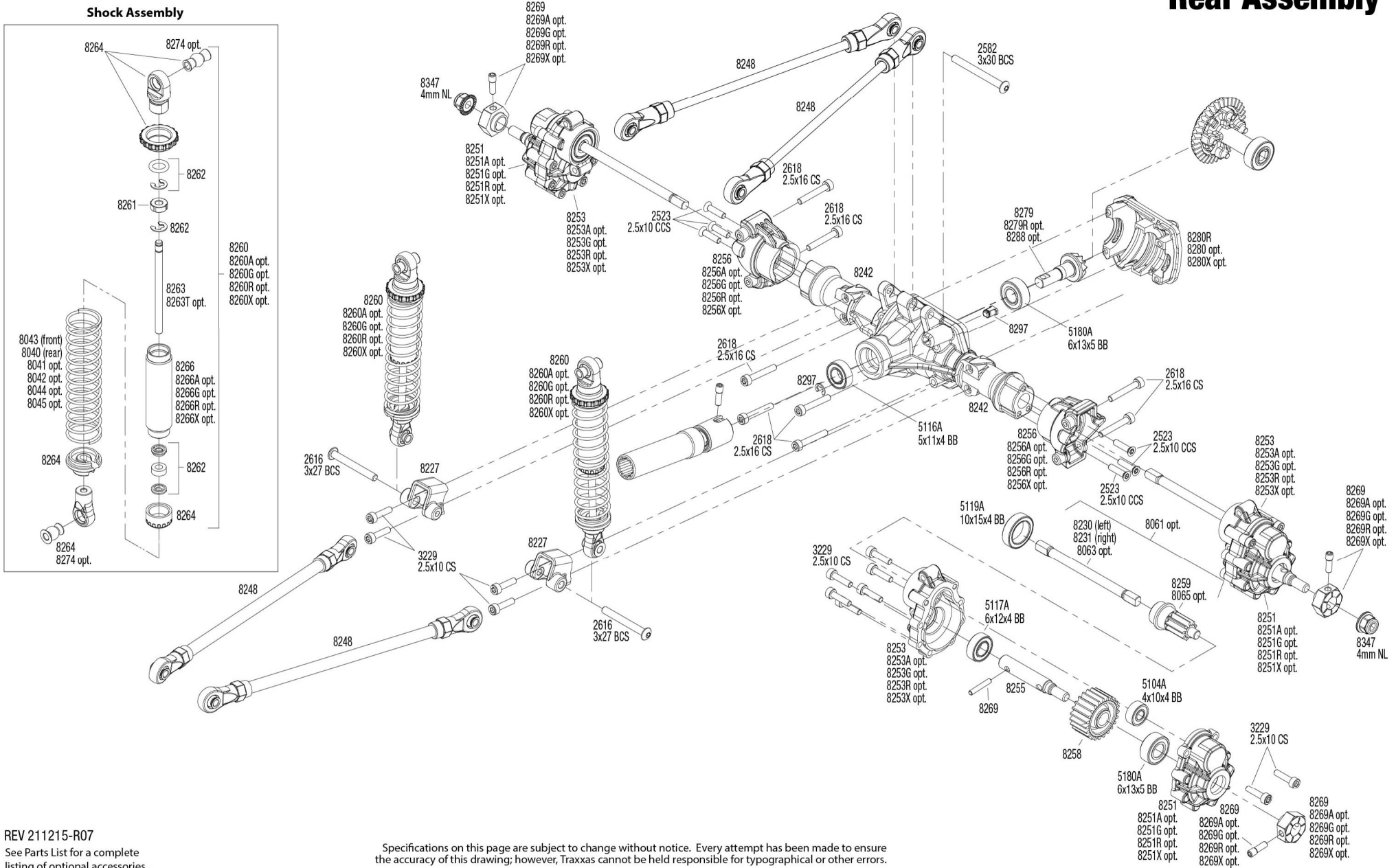

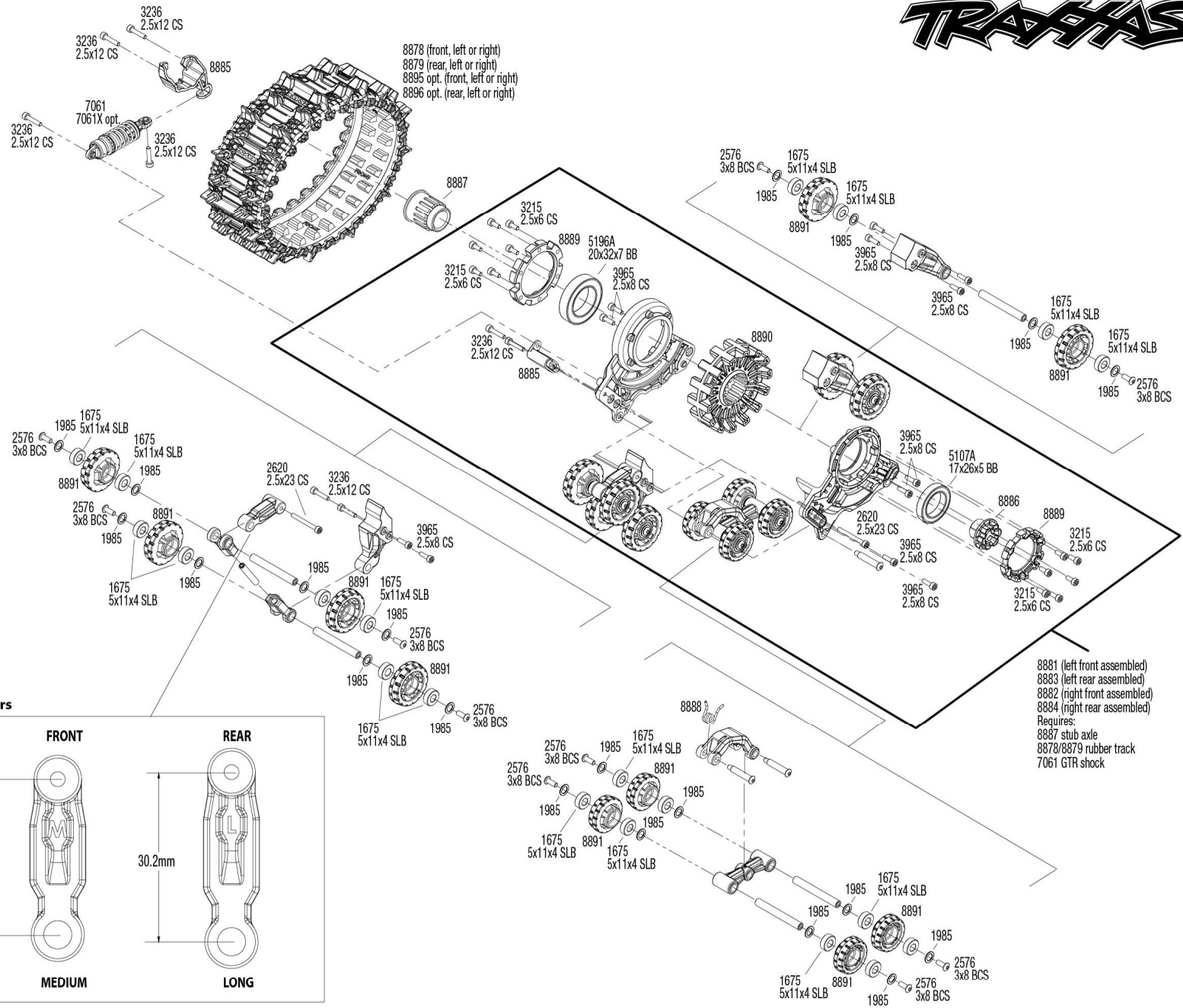

Shock Assembly

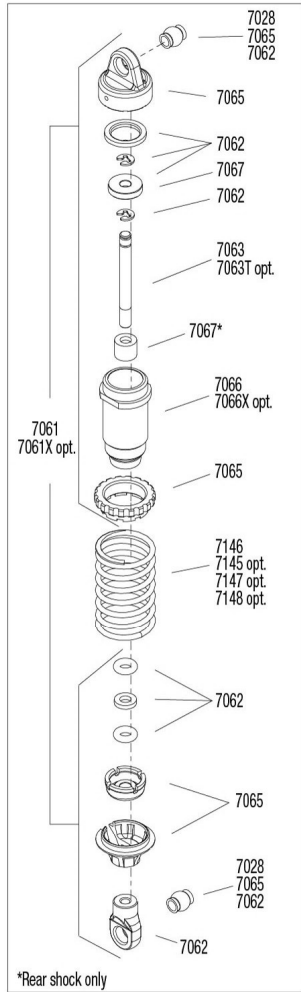

Tension Bars

