



# BLACK JACK 26

SUPER SPORT BRUSHLESS

## Blackjack 26 SS Brushless EP Catamaran Boat

### Owners Manual



### Specifications

---

|                      |  |
|----------------------|--|
| Hull Length.....     | 26.75 in (679mm)   |
| Beam.....            | 8.375 in (213mm)   |
| Motor.....           | Water-cooled High-performance A3630-1500 Brushless Motor |
| Radio System.....    | Pro Boat 2.4GHz Spektrum Marine DSM Pistol-Grip          |
| Drive System.....    | Flexshaft with adjustable strut                          |
| Steering System..... | Anodized Aluminum offset Rudder                          |
| Speed Control.....   | Water-cooled 45-Amp Brushless ESC                        |

## NOTICE

All instructions, warranties and other collateral documents are subject to change at the sole discretion of Horizon Hobby, Inc. For up-to-date product literature, visit [www.horizonhobby.com](http://www.horizonhobby.com) and click on the support tab for this product.

## Meaning of Special Language:

The following terms are used throughout the product literature to indicate various levels of potential harm when operating this product:

**NOTICE:** Procedures, which if not properly followed, create a possibility of physical property damage AND little or no possibility of injury.

**CAUTION:** Procedures, which if not properly followed, create the probability of physical property damage AND a possibility of serious injury.

**WARNING:** Procedures, which if not properly followed, create the probability of property damage, collateral damage, and serious injury OR create a high probability of superficial injury.



**WARNING:** Read the ENTIRE instruction manual to become familiar with the features of the product before operating. Failure to operate the product correctly can result in damage to the product, personal property and cause serious injury.

This is a sophisticated hobby product and NOT a toy. It must be operated with caution and common sense and requires some basic mechanical ability. Failure to operate this Product in a safe and responsible manner could result in injury or damage to the product or other property. This product is not intended for use by children without direct adult supervision. Do not attempt disassembly, use with incompatible components or augment product in any way without the approval of Horizon Hobby, Inc. This manual contains instructions for safety, operation and maintenance. It is essential to read and follow all the instructions and warnings in the manual, prior to assembly, setup or use, in order to operate correctly and avoid damage or serious injury.

## Additional Safety Precautions and Warnings

As the user of this product, you are solely responsible for operating in a manner that does not endanger yourself and others or result in damage to the product or the property of others.

This model is controlled by a radio signal subject to interference from many sources outside your control. This interference can cause momentary loss of control so it is advisable to always keep a safe distance in all directions around your model, as this margin will help avoid collisions or injury.

**Age Recommendation: Not for children under 14 years.** This is not a toy.

- Always keep a safe distance in all directions around your model to avoid collisions or injury. This model is controlled by a radio signal subject to interference from many sources outside your control. Interference can cause momentary loss of control.
- Always operate your model in open spaces away from full-size vehicles, traffic and people.
- Always carefully follow the directions and warnings for this and any optional support equipment (chargers, rechargeable battery packs, etc.).
- Always keep all chemicals, small parts and anything electrical out of the reach of children.
- Always avoid water exposure to all equipment not specifically designed and protected for this purpose. Moisture causes damage to electronics.
- Never place any portion of the model in your mouth as it could cause serious injury or even death.
- Never operate your model with low transmitter batteries.

## Introduction

Thank you for purchasing the Pro Boat® Blackjack™ 26 SS Brushless EP Ready-To-Run boat. Please read these instructions carefully before attempting to operate your boat.

The Blackjack 26 SS Brushless EP comes Ready-To-Run with the Pro Boat 2.4GHz Spektrum™ Marine DSM radio system and electronic speed controller already installed. All assembly and building is done at the factory, allowing you to quickly get your boat running.

## Table of Contents

|  |    |
|--|----|
| Introduction.....  | 3  |
| Table of Contents .....  | 3  |
| General Guidelines .....                                       | 4  |
| Additional Required Items .....                                | 4  |
| Inspection .....   | 5  |
| Contents .....   | 5  |
| Section 1: Assembling the Boat Stand .....                     | 5  |
| Section 2: Installing the Transmitter Batteries.....           | 6  |
| Section 3: Installing the 7.2V Ni-MH Battery Packs .....       | 6  |
| Section 4: Checking the Radio System .....                     | 7  |
| Section 5: Adjusting the Transmitter.....                      | 8  |
| Section 6: Handling Adjustment .....                           | 8  |
| Section 7: Testing Your Boat in the Water.....                 | 9  |
| Section 8: Speed Control Programming.....                      | 9  |
| Section 9: Maintenance.....                                    | 9  |
| Section 10: Lubricating the Drive Shaft.....                   | 10 |
| Section 11: Identification of Components .....                 | 11 |
| Section 13: Replacement Parts.....                             | 12 |
| Section 14: Warranty Information.....                          | 12 |
| Section 15: Warranty and Service Contact Information .....     | 14 |
| Section 16: FCC Information.....                               | 14 |
| Section 17: Compliance Information for the European Union..... | 15 |

## General Guidelines

It is important that you read and follow this instruction manual, along with the radio system manual before you run this exciting boat. Failure to read and understand the manual could result in personal injury, property damage or permanent damage to your boat. It is also important to run your boat responsibly. With proper care and maintenance, you will be able to proudly enjoy your Blackjack 26 SS Brushless Catamaran for many years to come.

When operating the boat, stay clear of people, full-scale boats, stationary objects and wildlife. It is preferable to operate the Blackjack 26 SS Brushless Catamaran in low wake, low wind conditions and in areas free of people, wildlife and objects.

Before you operate your model, make sure that your frequency is clear. If someone is operating on the same frequency, both models could go out of control, possibly causing damage to the models or to others. Check all of the hardware, and the propeller for damage and loose screws before and after each run.

If at any time while operating your model you sense any abnormal function, end your operation immediately. Do not operate your boat again until you are certain the problem has been corrected.

## Additional Required Items

You will need to purchase the following to get your boat on the water:

- 4 AA alkaline batteries for the radio transmitter
- 7.2V Ni-MH Battery Pack with Deans Connector (PRB3316) (2)
- Twin Peak™ Dual Battery Charger (DYN4033)
- Tamiya/Deans adapter (PRB3312)

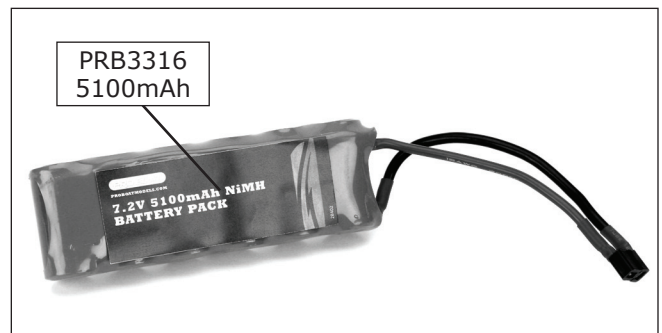

## Inspection

### ***Always stay clear of the propeller.***

Carefully remove the boat and radio transmitter from the box. Inspect the boat to make sure no damage is present.

If you notice damage is present, please contact the hobby shop where you purchased it.

## Contents

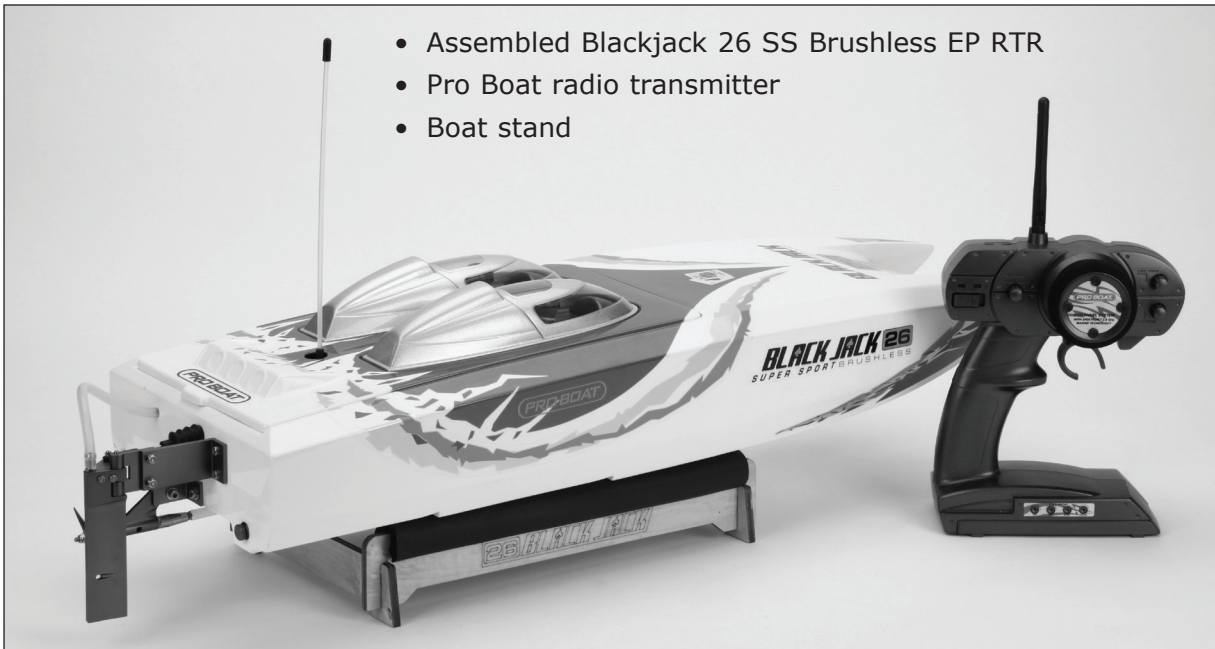

## Section 1: Assembling the Boat Stand

Attach the side stand pieces by interlocking them into the end pieces as shown. Secure the interlocking pieces with medium CA or epoxy. Make certain you allow the adhesive to fully cure before placing your boat on the stand.





## Section 2: Installing the Transmitter Batteries

Install 4 AA alkaline batteries into the transmitter, following the instructions provided for your radio system.

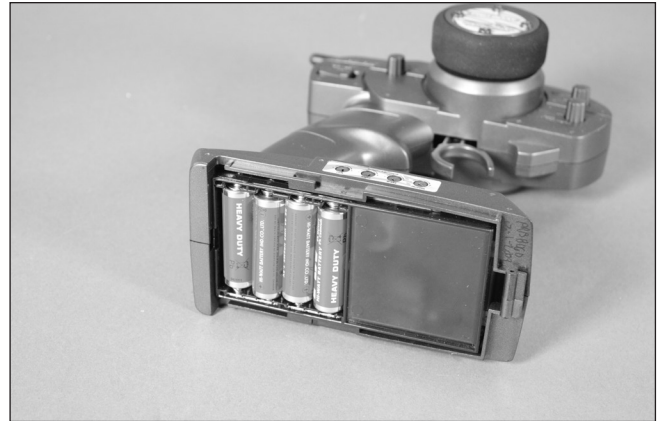

## Section 3: Installing the 7.2V Ni-MH Battery Packs

Carefully remove the hatch from the hull.



The Pro Boat water-cooled ESC comes pre-wired with a Deans-style connector. Use 2 6-cell battery packs listed below for optimum performance.

- PRB3316 7.2V 5100mAh  
w/Deans Connector

You may also use 2 7.4V LiPo battery packs (DYN5360D) to operate the boat but you must program the esc to change the cut-off voltage to the appropriate level or damage to the batteries will occur from over discharging. See Section 8 for details.

**Note:** Low quality or unmatch battery packs will not deliver the amount of power necessary to operate this model.

If the batteries are fully charged and the esc stops operation early, the most likely cause is batteries with high internal resistance. Use only high performance batteries.

Pro Boat offers a charge adapter (PRB3312) to allow you to charge the PRB3316 batteries with Deans connectors with conventional chargers that use Tamiya-style connectors.

Follow the instructions included with your fast charger to ensure a safe charge.



Attach the hook and loop material to the batteries and the battery boxes. Install two fully charged 7.2V Ni-MH battery packs into the hull.

## Section 4: Checking the Radio System

Ensure the antenna tube is properly placed through the hull. It may be necessary to slightly pull the antenna tube out to make certain the radio range is sufficient.

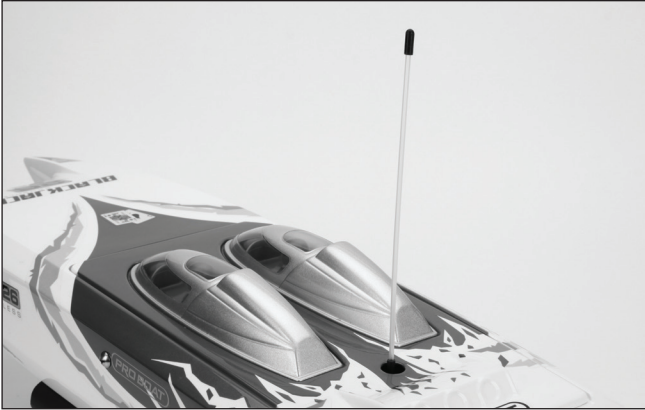

Turn the transmitter on, then turn on the receiver/ESC switch, checking for correct operation. The rear of the rudder should move right when right input is given. Conversely, when left input is given, the back part of the rudder should move toward the back of the boat.

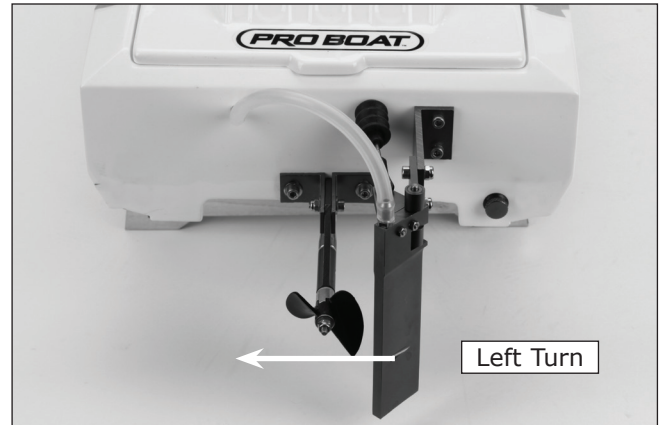
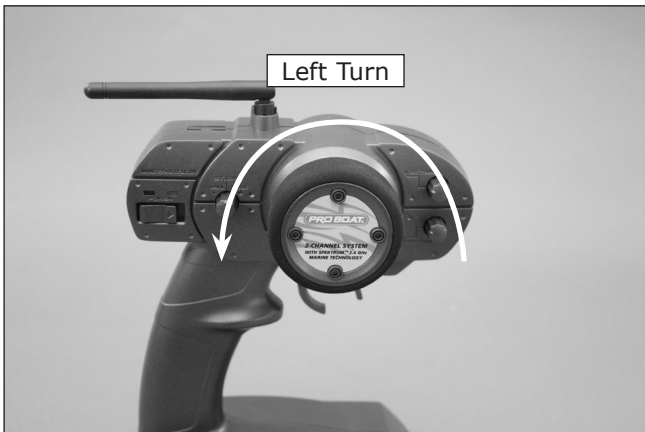

The ESC will beep until you give full throttle input. The auto sensing circuitry will select full throttle position when you hold full throttle during initial setup. Release the throttle trigger. With the propeller free from any objects, give some throttle input to ensure that the motor is working. If everything appears to be functioning correctly, you are ready to run your boat!

**Note:** The ESC has an over-rev limiter that will not allow you to hold full throttle when the propeller is not loaded (in the water). To reset, return the throttle trigger to neutral. The auto sensing voltage cutoff will also cut off power to the motor when the ESC senses that the batteries are nearing full discharge.

**Note:** If you are transporting your boat, make sure you disconnect the battery from the speed controller and then turn your radio off until you are ready to run the boat. Once ready, simply turn the radio on and plug the battery into the speed controller, again making sure that the boat is in neutral.

## Section 5: Adjusting the Transmitter

It may be necessary to adjust the throttle trim knob to stop the propeller from turning while the throttle trigger is in the neutral position.

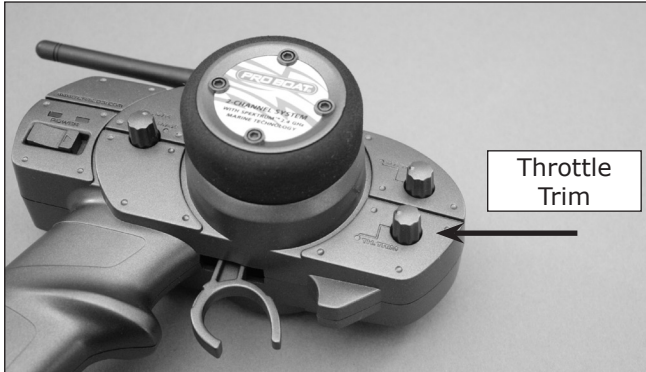

Adjust the rudder trim knob so that the rudder is centered prior to operation. You may adjust this control to make the boat run straight during operation.



## Section 6: Handling Adjustment

Operate your Blackjack 26 SS Brushless EP in low to medium wake conditions to avoid having problems with the boat overturning. If the conditions are questionable, adjust the prop strut down a bit to reduce the likelihood of having the boat overturn. The motor mount is slotted to allow you to move the motor slightly when adjusting the propeller strut. Loosen the motor mounting screws when adjusting the propeller strut angle trim and retighten after adjustment is complete.

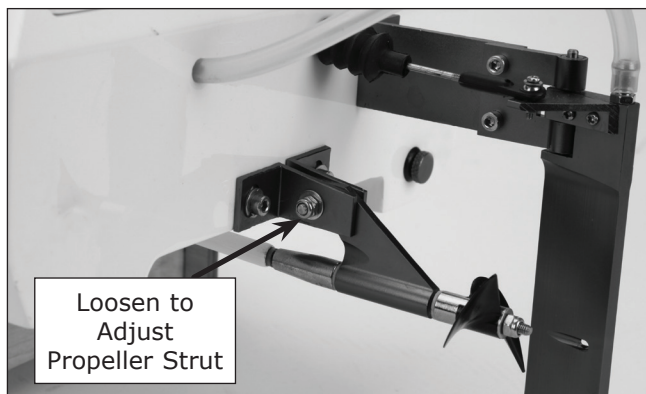

You may also turn the dual rate dial down to reduce rudder travel in rough water conditions.

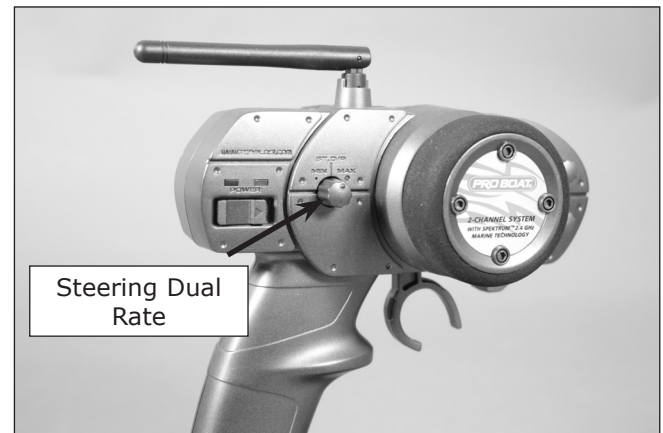



## Section 7: Testing Your Boat in the Water

Test the radio system for proper operation and then carefully place the boat in the water. Pilot the boat at slow speeds, staying close to the shoreline to ensure you have good control and that the boat is functioning correctly. Be certain to avoid all objects in the water at all times.

Once you feel comfortable with the control of your boat, it is safe to go further away from the shoreline and at faster speeds. When you notice the boat beginning to lose speed, bring the boat back to shore. It will be necessary to allow the electronic components to cool down and to replace or recharge the battery before heading out again.

## Section 8: Speed Control Programming

The ESC in your Blackjack 26 SS Brushless EP is pre-programmed from the factory. The programming is set for Ni-MH batteries as shipped with your Blackjack 26 SS.

A programming module (PRB3311) is available to change the programming of your speed control. Settings include Ni-MH or Li-Po batteries, cutoff voltage settings, cutoff type, brake on or off, motor timing and throttle curve.

**CAUTION:** It is imperative that you do not attempt to use Li-Po batteries in the Blackjack 26 SS Brushless unless it has been properly programmed or serious damage to the batteries and electronics may occur.

**NOTICE:** Do not turn off the transmitter first or the receiver may pick up stray signals and run out of control.

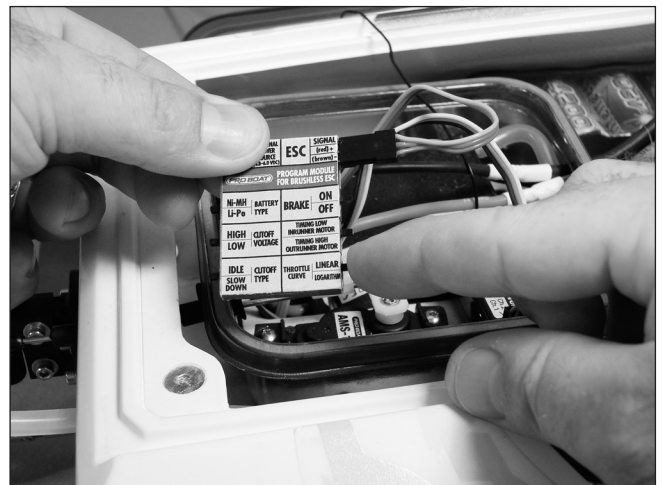

## Section 9: Maintenance

Before and at the end of each run, make sure all screws are tight and the propeller is free from any entanglement.

## Section 10: Lubricating the Drive Shaft

Lubricating the flexshaft is vital to the life of the drivetrain. The lubricant also acts as a water seal, keeping water from entering the hull through the stuffing box.

Lubricate the flexshaft, propeller shaft and all moving parts after every 2–3 hours of operation.

- 1. Use two 10mm wrenches to loosen the collet nut.



- 2. Remove the hex screws holding the prop strut in position. Remove the entire assembly with the flexshaft.

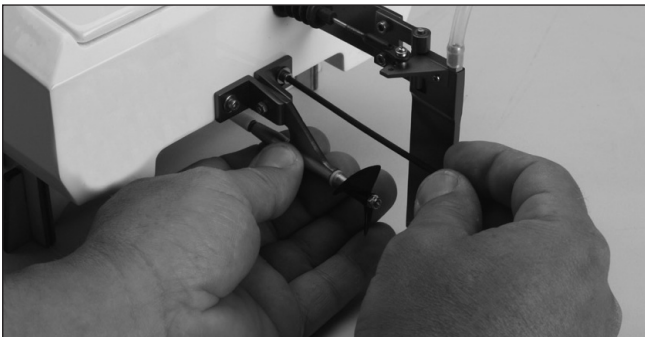

Carefully note how the drive shaft and prop are factory installed. This is important so that when you have finished lubricating the drive shaft, you can correctly reinstall the drive shaft.

- 3. Remove the drive shaft by sliding it out of the stuffing box.

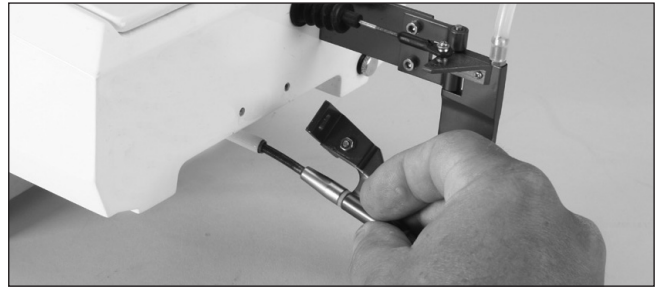

Wipe off all dirt or debris from the flexshaft and liberally lubricate the entire length of the drive shaft with silicone cable grease.



Carefully reinstall the drive shaft, making certain that there is a 1–2mm gap between the prop strut and the drive dog to allow for flexshaft shrinkage under load.

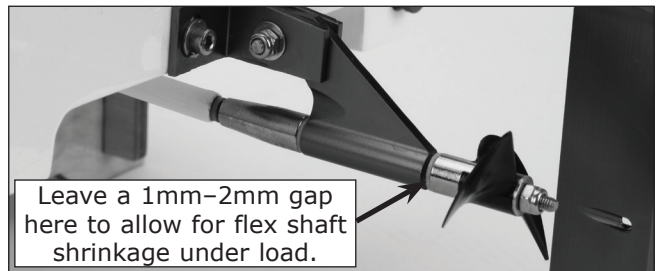

**Note:** Running the Blackjack 26 SS Brushless EP RTR in salt water could cause some parts to corrode. If you run the boat in salt water, rinse it thoroughly in fresh water after each use and lubricate the drive system.

Because of its corrosive effects, running RC boats in saltwater is at the discretion of the modeler.

# Section 11: Identification of Components

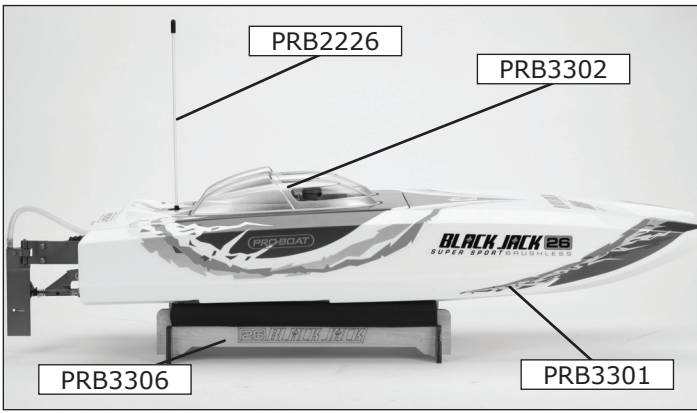
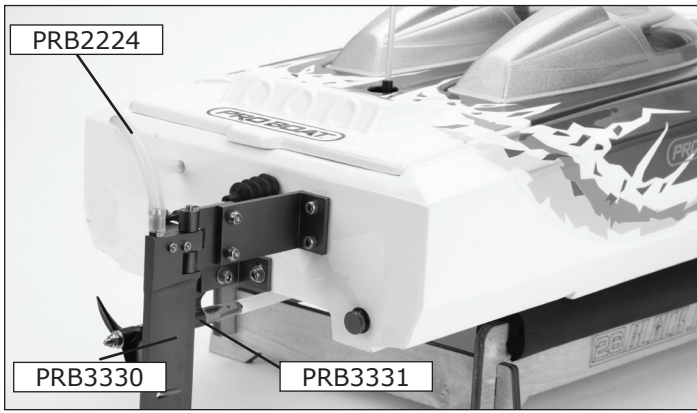
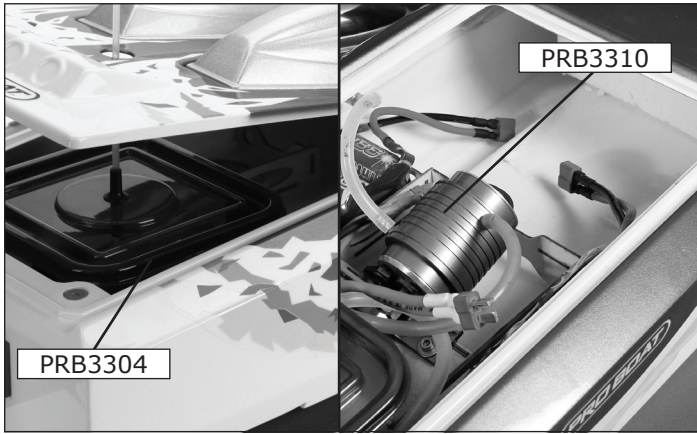
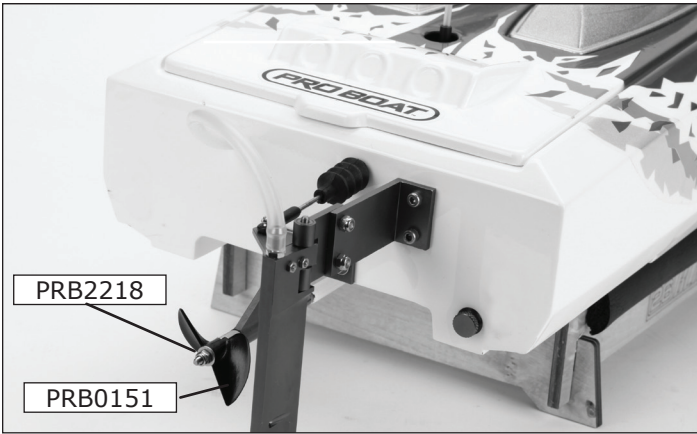

## Section 13: Replacement Parts

|         |                                 |         |                                  |
|---------|---------------------------------|---------|----------------------------------|
| PRB0151 | 1.6" x 2.5" Composite Propeller | PRB3332 | Flexshaft                        |
| PRB4019 | 1.6" x 2.5" Stainless Propeller | PRB3303 | Radio Box                        |
| PRB2218 | Prop Nut                        | PRB3304 | Radio Box Cover                  |
| PRB2219 | Nylon Washer                    | PRB3302 | Hatch                            |
| PRB2223 | Push Rod Connector              | PRB3305 | Decals                           |
| PRB2224 | Silicone Tubing                 | PRB3306 | Boat Stand                       |
| PRB2226 | Antenna Tube                    | PRB3307 | Motor Mount                      |
| PRB2228 | Rubber Boot                     | PRB3308 | Cable Collet                     |
| PRB2808 | Rudder Pushrod                  | PRB3309 | 45-AMP Brushless ESC             |
| PRB2810 | Stuffing Box                    | PRB3310 | A3630-1500 Brushless Motor       |
| PRB2811 | Stuffing Box Liner              | PRB3311 | Brushless ESC Programming Module |
| PRB2813 | Propeller Shaft                 | PRB3312 | Tamiya/Deans Charge Adapter      |
| PRB3331 | Propeller Strut                 | PRB3316 | 7.2V 5100mAh Battery w/Deans     |
| PRB3330 | Rudder and Strut                | PRB0100 | Marine Grease                    |
| PRB3301 | Hull Only                       | PRB0101 | Marine Grease Refill 5 oz        |

| Country of Purchase      | Horizon Hobby         | Address  | Phone Number/Email Address                           |
|--------------------------|-----------------------|--|--|
| United States of America | Sales                 | 4105 Fieldstone Rd<br>Champaign, Illinois<br>61822 USA                             | 800-338-4539<br>sales@horizonhobby.com               |
| United Kingdom           | Horizon Hobby Limited | Units 1-4 Ployters Rd<br>Staple Tye<br>Harlow, Essex<br>CM18 7NS<br>United Kingdom | +44 (0) 1279 641 097<br>sales@horizonhobby.co.uk     |
| Germany                  | Horizon Hobby GmbH    | Hamburger Str. 10<br>25335 Elmshorn<br>Germany                                     | +49 4121 46199 60<br>service@horizonhobby.de         |
| France                   | Horizon Hobby SAS     | 14 Rue Gustave Eiffel<br>Zone d'Activité du Réveil Matin<br>91230 Montgeron        | +33 (0) 1 60 47 44 70<br>infofrance@horizonhobby.com |

## Section 14: Warranty and Repair Policy

### Warranty Period

Horizon Hobby, Inc., (Horizon) warrants that the Products purchased (the "Product") will be free from defects in materials and workmanship at the date of purchase by the Purchaser.

### Limited Warranty

**Horizon reserves the right to change or modify this warranty without notice and disclaims all other warranties, express or implied.**

(a) This warranty is limited to the original Purchaser ("Purchaser") and is not transferable. REPAIR OR REPLACEMENT AS PROVIDED UNDER THIS WARRANTY IS THE EXCLUSIVE REMEDY OF THE PURCHASER. This warranty covers only those Products purchased from an authorized Horizon dealer. Third party transactions are not covered by this warranty. Proof of purchase is required for warranty claims. Further, Horizon reserves the right to change or modify this warranty without notice and disclaims all other warranties, express or implied.

(b) Limitations- HORIZON MAKES NO WARRANTY OR REPRESENTATION, EXPRESS OR IMPLIED, ABOUT NON-INFRINGEMENT, MERCHANTABILITY OR FITNESS FOR A PARTICULAR PURPOSE OF THE PRODUCT. THE PURCHASER ACKNOWLEDGES THAT THEY ALONE HAVE DETERMINED THAT THE PRODUCT WILL SUITABLY MEET THE REQUIREMENTS OF THE PURCHASER'S INTENDED USE.



(c) Purchaser Remedy- Horizon's sole obligation hereunder shall be that Horizon will, at its option, (i) repair or (ii) replace, any Product determined by Horizon to be defective. In the event of a defect, these are the Purchaser's exclusive remedies. Horizon reserves the right to inspect any and all equipment involved in a warranty claim. Repair or replacement decisions are at the sole discretion of Horizon. This warranty does not cover cosmetic damage or damage due to acts of God, accident, misuse, abuse, negligence, commercial use, or modification of or to any part of the Product. This warranty does not cover damage due to improper installation, operation, maintenance, or attempted repair by anyone other than Horizon. Return of any goods by Purchaser must be approved in writing by Horizon before shipment.

### **Damage Limits**

HORIZON SHALL NOT BE LIABLE FOR SPECIAL, INDIRECT OR CONSEQUENTIAL DAMAGES, LOSS OF PROFITS OR PRODUCTION OR COMMERCIAL LOSS IN ANY WAY CONNECTED WITH THE PRODUCT, WHETHER SUCH CLAIM IS BASED IN CONTRACT, WARRANTY, NEGLIGENCE, OR STRICT LIABILITY. Further, in no event shall the liability of Horizon exceed the individual price of the Product on which liability is asserted. As Horizon has no control over use, setup, final assembly, modification or misuse, no liability shall be assumed nor accepted for any resulting damage or injury. By the act of use, setup or assembly, the user accepts all resulting liability.

If you as the Purchaser or user are not prepared to accept the liability associated with the use of this Product, you are advised to return this Product immediately in new and unused condition to the place of purchase.

Law: These Terms are governed by Illinois law (without regard to conflict of law principals).

### **WARRANTY SERVICES**

#### **Questions, Assistance, and Repairs**

Your local hobby store and/or place of purchase cannot provide warranty support or repair. Once assembly, setup or use of the Product has been started, you must contact Horizon directly. This will enable Horizon to better answer your questions and service you in the event that you may need any assistance. For questions or assistance, please direct your email to [productsupport@horizonhobby.com](mailto:productsupport@horizonhobby.com), or call 877.504.0233 toll free to speak to a Product Support representative. You may also find information on our website at [www.horizonhobby.com](http://www.horizonhobby.com).

#### **Inspection or Repairs**

If this Product needs to be inspected or repaired, please use the Horizon Online Repair Request submission process found on our website or call Horizon to obtain a Return Merchandise Authorization (RMA) number. Pack the Product securely using a shipping carton. Please note that original boxes may be included, but are not designed to withstand the rigors of shipping without additional protection. Ship via a carrier that provides tracking and insurance for lost or damaged parcels, as Horizon is not responsible for merchandise until it arrives and is accepted at our facility. An Online Repair Request is available at [www.horizonhobby.com](http://www.horizonhobby.com) under the Repairs tab. If you do not have internet access, please contact Horizon Product Support to obtain a RMA number along with instructions for submitting your product for repair. When calling Horizon, you will be asked to provide your complete name, street address, email address and phone number where you can be reached during business hours. When sending product into Horizon, please include your RMA number, a list of the included items, and a brief summary of the problem. A copy of your original sales receipt must be included for warranty consideration. Be sure your name, address, and RMA number are clearly written on the outside of the shipping carton.

**Notice: Do not ship batteries to Horizon. If you have any issue with a battery, please contact the appropriate Horizon Product Support office.**

#### **Warranty Inspection and Repairs**

**To receive warranty service, you must include your original sales receipt verifying the proof-of-purchase date.** Provided warranty conditions have been met, your Product will be repaired or replaced free of charge. Repair or replacement decisions are at the sole discretion of Horizon.

#### **Non-Warranty Repairs**

**Should your repair not be covered by warranty the repair will be completed and payment will be required without notification or estimate of the expense unless the expense exceeds 50% of the retail purchase cost.** By submitting the item for repair you are agreeing to payment of the repair without notification. Repair estimates are available upon request. You must include this request with your repair. Non-warranty repair estimates will be billed a minimum of ½ hour of labor. In addition you will be billed for return freight. Horizon accepts money orders and cashiers checks, as well as Visa, MasterCard, American Express, and Discover cards. By submitting any item to Horizon for inspection or repair, you are agreeing to Horizon's Terms and Conditions found on our website under the Repairs tab.

## Section 15: Warranty and Service Contact Information

| Country of Purchase      | Horizon Hobby                                       | Address  | Phone Number/Email Address   |
|--------------------------|---|--|--|
| United States of America | Horizon Service Center<br>(Electronics and engines) | 4105 Fieldstone Rd<br>Champaign, Illinois<br>61822 USA                             | 877-504-0233<br>Online Repair Request visit:<br><a href="http://www.horizonhobby.com/repairs">www.horizonhobby.com/repairs</a> |
|                          | Horizon Product Support (All other products)        | 4105 Fieldstone Rd<br>Champaign, Illinois<br>61822 USA                             | 877-504-0233<br><a href="mailto:productsupport@horizonhobby.com">productsupport@horizonhobby.com</a>                           |
| United Kingdom           | Horizon Hobby Limited                               | Units 1-4 Ployters Rd<br>Staple Tye<br>Harlow, Essex<br>CM18 7NS<br>United Kingdom | +44 (0) 1279 641 097<br><a href="mailto:sales@horizonhobby.co.uk">sales@horizonhobby.co.uk</a>                                 |
| Germany                  | Horizon Technischer Service                         | Hamburger Str. 10<br>25335 Elmshorn<br>Germany                                     | +49 4121 46199 66<br><a href="mailto:service@horizonhobby.de">service@horizonhobby.de</a>                                      |
| France                   | Horizon Hobby SAS                                   | 14 Rue Gustave Eiffel<br>Zone d'Activité du Réveil Matin<br>91230 Montgeron        | +33 (0) 1 60 47 44 70<br><a href="mailto:infofrance@horizonhobby.com">infofrance@horizonhobby.com</a>                          |

## Section 16: FCC Information

### FCC Information

This device complies with part 15 of the FCC rules. Operation is subject to the following two conditions:

(1) This device may not cause harmful interference, and (2) This device must accept any interference received, including interference that may cause undesired operation.

**CAUTION:** Changes or modifications not expressly approved by the party responsible for compliance could void the user's authority to operate the equipment.

This product contains a radio transmitter with wireless technology which has been tested and found to be compliant with the applicable regulations governing a radio transmitter in the 2.400GHz to 2.4835GHz frequency range.

### Antenna Separation Distance

When operating your transmitter, please be sure to maintain a separation distance of at least 5 cm between your body (excluding fingers, hands, wrists, ankles and feet) and the antenna to meet RF exposure safety requirements as determined by FCC regulations.

The illustrations below show the approximate 5 cm RF exposure area and typical hand placement when operating your Spektrum transmitter.

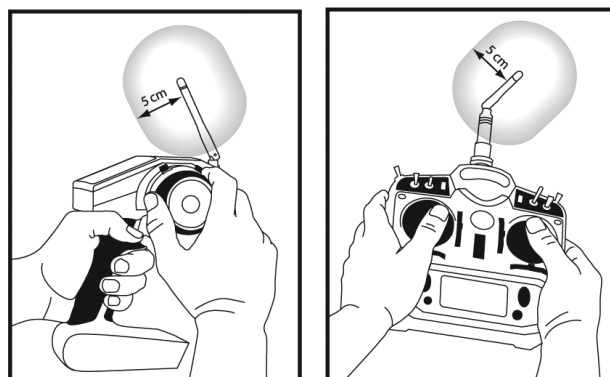

## Section 17: Compliance Information for the European Union

|    |    |    |    |    |
|----|----|----|----|----|
| AT | BG | CZ | CY | DE |
| DK | ES | FI | FR | GR |
| HU | IE | IT | LT | LU |
| LV | MT | NL | PL | PT |
| RO | SE | SI | SK | UK |

### Declaration of Conformity

(in accordance with ISO/IEC 17050-1)

No. HH2011021501

Product(s): PRB Blackjack 26 BL SS RT

Item Number(s): PRB3300S

Equipment class: 2

The object of declaration described above is in conformity with the requirements of the specifications listed below, following the provisions of the European R&TTE directive 1999/5/EC:

EN 300-228 Technical requirements for Radio equipment.

EN 301 489 General EMC requirements for Radio equipment

EN 60950 Safety



Signed for and on behalf of:  
Horizon Hobby, Inc.  
Champaign, IL USA  
Feb 15, 2011

Steven A. Hall  
Vice President  
International Operations and  
Risk Management  
Horizon Hobby, Inc.

### Instructions for Disposal of WEEE by Users in the European Union



This product must not be disposed of with other waste. Instead, it is the user's responsibility to dispose of their waste equipment by handing it over to a designated collection point for the recycling of waste electrical and electronic equipment. The separate collection and recycling of your waste equipment at the time of disposal will help to conserve natural resources and ensure that it is recycled in a manner that protects human health and the environment. For more information about where you can drop off your waste equipment for recycling, please contact your local city office, your household waste disposal service or where you purchased the product.

**Konformitätserklärung gemäß Gesetz über Funkanlagen und  
Telekommunikationseinrichtungen (FTEG) und der  
Richtlinie 1999/5/EG (R&TTE)**

Declaration of conformity in accordance with the Radio and Telecommunications  
Terminal Equipment Act (FTEG) and directive 1999/5/EG (R&TTE)

Horizon Hobby GmbH  
Hamburger Straße 10  
D-25337 Elmshorn

erklärt das Produkt: Pro Boat Blackjack 26 BL SS RT (PRB3300S)  
declares the product:

Gerätekategorie: 2  
equipment class

den grundlegenden Anforderungen des §3 und den übrigen einschlägigen  
Bestimmungen des FTEG (Artikel 3 der R&TTE) entspricht.  
complies with the essential requirements of §3 and other relevant provisions of the FTEG  
(Article 3 of the R&TTE directive).

Angewendete harmonisierte Normen:  
Harmonised standards applied:

- |            |   |
|------------|---|
| EN 60950   | Gesundheit und Sicherheit gemäß §3 (1) 1. (Artikel 3(1)a))<br>Health and safety requirements pursuant to §3 (1) 1.(article 3(1)a))  |
| EN 301 489 | Schutzanforderungen in Bezug auf elektromagnetische Verträglichkeit<br>§3 (1) 2, (Artikel 3 (1) b))<br>Protection requirement concerning electromagnetic compatibility<br>§3 (1) 2, (article 3 (1)b)) |
| EN 300 328 | Maßnahmen zur effizienten Nutzung des Frequenzspektrums<br>§ 3 (2)(Artikel 3 (2))<br>Measures for the efficient use of the radio frequency spectrum<br>§ 3 (2) (Article 3 (2))                        |



Elmshorn, 15.02.2011

Steven A. Hall  
Geschäftsführer  
Managing Director

Birgit Schamuhn  
Geschäftsführerin  
Managing Director

Horizon Hobby GmbH; Hamburger Str. 10; D-25337 Elmshorn  
HR Pi: HRB 1909; UStIDNr.:DE812678792; Str.Nr.: 1829812324  
Geschäftsführer: Birgit Schamuhn, Steven A. Hall

Tel.: +49 4121 4619960 • Fax: +49 4121 4619970 eMail: info@horizonhobby.de;  
Internet: www.horizonhobby.de

Es gelten unsere allgemeinen Geschäftsbedingungen, die in unseren Geschäftsräumen  
eingesehen werden können. Ware bleibt bis zur vollständigen Bezahlung  
Eigentum der Horizon Hobby GmbH











© 2011, Horizon Hobby, Inc.  
[www.horizonhobby.com](http://www.horizonhobby.com)

The Spektrum trademark is used with permission of Bachmann Industries, Inc.  
All other marks are trademarks or registered trademarks of Horizon Hobby, Inc.