

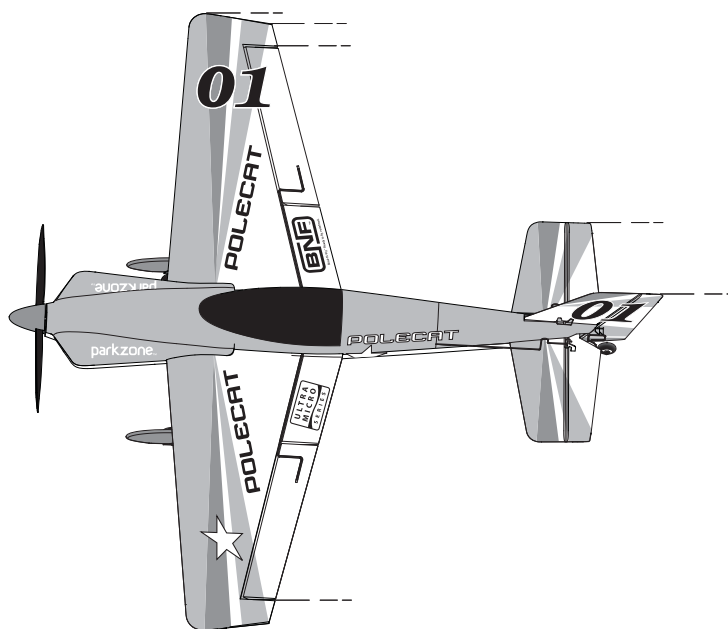

Ultra Micro Pole Cat



Instruction Manual
Bedienungsanleitung
Manuel d'utilisation
Manuale di Istruzioni



BIND-N-FLY SPEKTRUM DSM TECHNOLOGY



NOTICE

All instructions, warranties and other collateral documents are subject to change at the sole discretion of Horizon Hobby, Inc. For up-to-date product literature, visit www.horizonhobby.com and click on the support tab for this product.

Meaning of Special Language:

The following terms are used throughout the product literature to indicate various levels of potential harm when operating this product:

NOTICE: Procedures, which if not properly followed, create a possibility of physical property damage AND little or no possibility of injury.

CAUTION: Procedures, which if not properly followed, create the probability of physical property damage AND a possibility of serious injury.

WARNING: Procedures, which if not properly followed, create the probability of property damage, collateral damage and serious injury OR create a high probability of superficial injury.

 **WARNING:** Read the ENTIRE instruction manual to become familiar with the features of the product before operating. Failure to operate the product correctly can result in damage to the product, personal property and cause serious injury.

This is a sophisticated hobby product. It must be operated with caution and common sense and requires some basic mechanical ability. Failure to operate this Product in a safe and responsible manner could result in injury or damage to the product or other property. This product is not intended for use by children without direct adult supervision. Do not attempt disassembly, use with incompatible components or augment product in any way without the approval of Horizon Hobby, Inc. This manual contains instructions for safety, operation and maintenance. It is essential to read and follow all the instructions and warnings in the manual prior to assembly, setup or use in order to operate correctly and avoid damage or serious injury.

Age Recommendation: Not for children under 14 years. This is not a toy.

Thank you for purchasing the ParkZone® Ultra Micro Series Pole Cat. You're just a battery charge away from one of the most exciting Ultra Micro flying experiences available. This Pole Cat has been specially designed to look like a full-scale Formula-1 air racer yet remain as forgiving as any sport plane. Whether you're banking and yanking at high speed around the pylons, or simply shooting touch and go landings, the Pole Cat is a joy to fly at any speed.

Before you take that first flight though, please take some time to read through this manual. In addition to instructions for binding it to your DSM2™ or DSMX™ transmitter, you'll find control setup and charging tips, as well as a handy troubleshooting guide. It's all here so you can get the most from your Pole Cat— first flight and every flight.

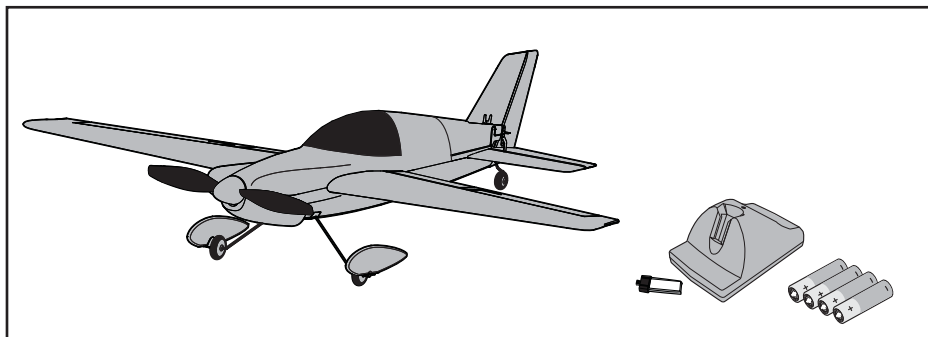

Table of Contents

Table of Contents	3	Flying Tips and Repairs	11
Charging the Battery	4	Additional Safety Precautions	
Battery Warnings	5	and Warnings	12
Low Voltage Cutoff (LVC)	5	Maintenance After Flying	12
Transmitter and Receiver Binding	6	Removing and Installing Landing Gear	12
Installing Flight Battery	6	Troubleshooting Guide	13
Before Flight	6	Warranty and Repair Policy	14
First Flight Preparation	7	Warranty and Service Information	15
Control Centering	7	Compliance Information for	
Settings for Control Horns	7	the European Union	15
Control Rates	8	Instructions for disposal of WEEE	
Model Decals	8	by users in the European Union	15
Adjusting Center of Gravity (CG)	8	Parts Contact	58
Control Direction Test	9	Replacement parts	58-59
Propeller and Propeller Shaft Maintenance ..	10	Optional Parts and Accessories	59

Pole Cat Specifications	
Wingspan	16.1 in (409mm)
Length	15.4 in (391mm)
Weight	1.25 oz (35.3 g)

Pole Cat Features	Bind-N-Fly® Aircraft
Onboard Electronics Spektrum™ AR6400 Receiver/Servos/ESC	Installed
Battery 150mAh 3.7V 12C Li-Po	Included
Charger 1S 3.7V Li-Po Battery Charger	Included
Transmitter DSM2™/DSMX™ 4-Channel Transmitter, 2.4GHz	Sold Separately

To register your product online, go to www.parkzone.com

Charging the Battery

Your Pole Cat comes with a 1S 3.7V Li-Po Battery Charger and a 1S Li-Po battery. You should only charge your 1S Li-Po battery with the included charger, or the E-flite® Celestra™ 4-port Charger (EFLC1004). The flight battery will be required to confirm proper aircraft operation in future steps.

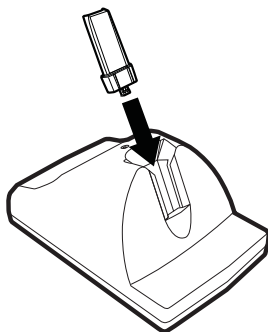

The Battery Charging Process

1. Charge only batteries that are cool to the touch and are not damaged. Look at the battery to make sure it is not damaged e.g., swollen, bent, broken or punctured.
 2. Remove the cover on the bottom of the charger and install four of the included AA batteries, noting proper polarity. Replace the cover after the AA batteries are installed.
 3. Slide the battery into the slot on the charger. The end cap of the battery is specifically designed to allow the battery to fit into the slot one way (usually with the label on the battery facing outward) to prevent reverse polarity connection. However, check for proper alignment and polarity before proceeding to the next step.
 4. Gently press the battery and its connector into the charge jack/connector located at the bottom of the slot in the charger.
 5. When you make the connection successfully, the LED on the charger turns solid red, indicating charging has begun.
 6. Charging a fully discharged (not over-discharged) 150mAh battery takes approximately 30–40 minutes. As the battery nears full charge, the LED begins to blink.
 7. When the battery is fully charged, the LED blinks approximately every 20 seconds or goes out entirely. **Note:** If the LED stays on when the battery is removed, the AA batteries in the charger are low.
 8. Always unplug the battery from the charger immediately upon completion of charging.
- ⚠ CAUTION:** Overcharging a battery can cause a fire.

⚠ CAUTION: Only use a charger specifically designed to charge a Li-Po battery. Failure to do so could result in a fire, causing injury or property damage.

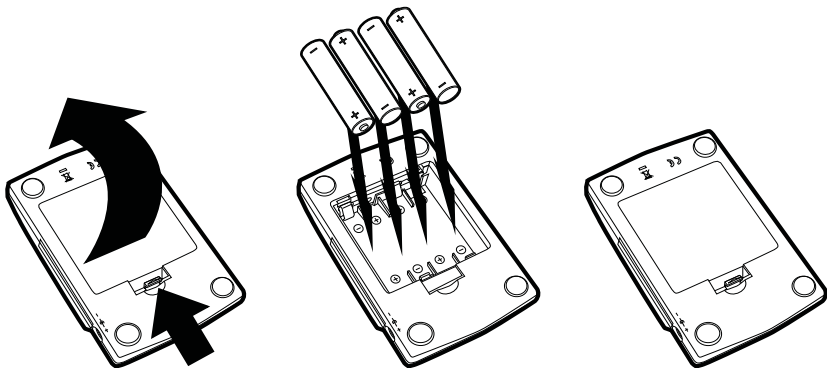

⚠ CAUTION: Only use an E-flite 6V power supply (EFLC1005) with this charger. DO NOT use a 12V power supply or property damage and injury could occur.

Battery Warnings

The Battery Charger (EFLC1000) included with the Pole Cat has been designed to safely charge the Li-Po battery.

 **CAUTION:** All instructions and warnings must be followed exactly. Mishandling of Li-Po batteries can result in a fire, personal injury and/or property damage.

- By handling, charging or using the included Li-Po battery you assume all risks associated with lithium batteries.
- If at any time the battery begins to balloon or swell, discontinue use immediately. If charging or discharging, discontinue and disconnect. Continuing to use, charge or discharge a battery that is ballooning or swelling can result in fire.
- Always store the battery at room temperature in a dry area for best results.
- Always transport or temporarily store the battery in a temperature range of 40–120° F. Do not store battery or model in a car or direct sunlight. If stored in a hot car, the battery can be damaged or even catch fire.
- Always charge batteries away from flammable materials.
- NEVER USE AN Ni-Cd OR Ni-MH CHARGER.
Failure to charge the battery with a compatible charger may cause fire resulting in personal injury and/or property damage
- Never discharge Li-Po cells to below 3V under load.
- Never cover warning labels with hook and loop strips.
- Never leave charging batteries unattended.
- Never charge batteries outside safe temperature ranges.
- Never charge damaged batteries.

Low Voltage Cutoff (LVC)

When a Li-Po battery is discharged below 3V, it will not hold a charge. The Pole Cat ESC protects the flight battery from over-discharge using Low Voltage Cutoff (LVC). Before the battery charge decreases too much, LVC removes power supply from the motor. Power to the motor quickly decreases and increases, showing some battery power is reserved for flight control and safe landing.

When the motor power decreases then increases, please land the aircraft immediately and recharge the flight battery.

Disconnect and remove the Li-Po battery from the aircraft after use to prevent trickle discharge. Before storage, charge the Li-Po battery to full capacity. During storage, make sure battery charge does not go below 3V.

NOTICE: Repeated flying to LVC will damage the battery.

Transmitter and Receiver Binding

Binding is the process of programming the receiver of the control unit to recognize the GUID (Globally Unique Identifier) code of a single specific transmitter. You need to “bind” your chosen Spektrum™ DSM® technology equipped aircraft transmitter to the receiver for proper operation.

Note: For a list of compatible DSM2/DSMX transmitters, please visit www.bindnfly.com.
Note: When using a Futaba transmitter with a Spektrum DSM2 module, you will need to reverse the throttle channel.

✓ Binding Procedure Reference Table

1. Refer to your transmitter's unique instructions for binding to a receiver.
2. Make sure the flight battery is disconnected from the airplane.
3. Power off the transmitter.
4. Connect the flight battery to the aircraft. The receiver LED will begin to flash (typically after 5 seconds).
5. Make sure transmitter controls are neutral and that throttle and throttle trim are in low position.
6. Put your transmitter into bind mode. Refer to your transmitter's manual for binding button or switch instructions.
7. After 5 to 10 seconds, the receiver status LED will become solid, indicating that the receiver is bound to the transmitter. Note: If the LED does not go to a solid light, refer to Troubleshooting Guide at back of manual.

Installing Flight Battery

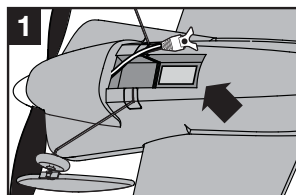

1 Locate battery compartment on bottom side of aircraft.

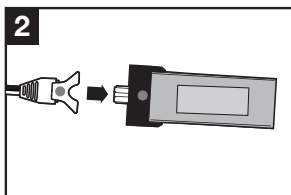

2 Connect fully charged flight battery to receiver.

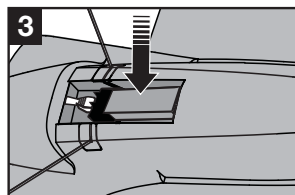

3 Attach battery to hook and loop strip in battery compartment.

Before Flight

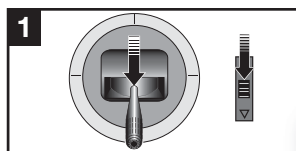

1 Lower throttle and throttle trim to lowest settings.

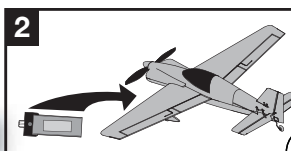

2 Connect flight battery to aircraft.

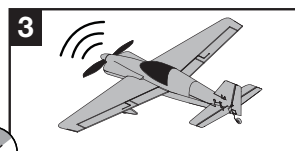

Wait 5 Seconds

3 Series of tones
Continuous LED

⚠ CAUTION: Always keep hands away from propeller. When armed, the motor will turn the propeller in response to any throttle movement.

First Flight Preparation

1. Remove and inspect box contents.
2. Read this instruction manual thoroughly.
3. Install fully charged flight battery in the airplane.
4. Make sure aircraft is bound to your transmitter.
5. Make sure control rods move freely.
6. Make sure flight control surfaces are centered.
7. Perform the Control Direction Test with the transmitter.
8. Adjust flight controls and transmitter.
9. Adjust battery for center of gravity (CG).
10. Perform a radio system Range Check.
11. Find a safe and open area.
12. Plan flight for flying field conditions.

Control Centering

Before first flights, or in the event of an accident, make sure the flight control surfaces are centered. Adjust linkages mechanically if control surfaces are not centered.

Use of the transmitter trims may not correctly center the aircraft control surfaces due to the mechanical limits of linear servos.

1. Make sure control surfaces are neutral when the transmitter controls and trims are centered. Where possible, transmitter sub-trim must be set to zero.
2. When needed, use a pair of pliers to carefully bend the metal of the linkage (see illustration).
3. Make the U-shape narrower to make the connector shorter. Make the U-shape wider to make the linkage longer.

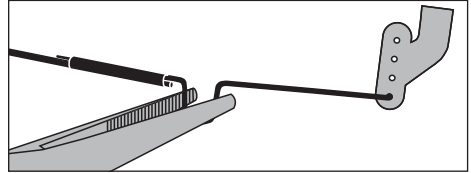

NOTICE: When using a programmable transmitter, do not use Sub-Trim to adjust the center position of the servo.

NOTICE: Never set Travel Adjust above 100%. Ultra Micro servos are unique in that they are calibrated to reach maximum travel at 100% travel adjust. Increasing the value above 100% will NOT result in more travel, but can cause the servo to lock and will result in a crash.

Settings for Control Horns

The illustration shows factory settings for linkages on control horns. After flying, if you want more control throw, carefully adjust linkage positions for desired control response.

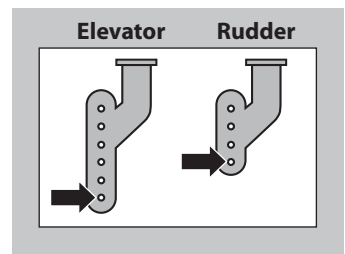

Control Rates

We recommend using a DSM2/DSMX aircraft transmitter. Adjust according to individual preferences after initial flight.

It is normal for linear servos to make noise. The noise is not an indication of a faulty servo.

To achieve the proper Low Rate settings when using a programmable DSM2/DSMX aircraft transmitter, set the Low Rate value to 70% for aileron, elevator and rudder.

	High Rate	Low Rate
Aileron	6mm up/down	4mm up/down
Elevator	5mm up/down	4mm up/down
Rudder	9mm left/right	6mm left/right

Note: All control surfaces are measured at the widest point.

Model Decals

An additional decal sheet has been included in the box to personalize your model with your favorite racing number.

Apply these decals in any location you may choose.

Note: Be sure to balance your model and find the correct center of gravity after applying the decals. Decal application can affect center of gravity.

Adjusting Center of Gravity (CG)

The CG location is **22–25mm** back from the leading edge of the wing at the fuselage. This CG location has been determined with the included 1S 150mAh 3.7V Li-Po battery installed in the front of the battery cavity.

Note: The battery cavity is oversized to allow for Center of Gravity adjustment. Start by placing the battery in the front of the cavity and adjust as needed.

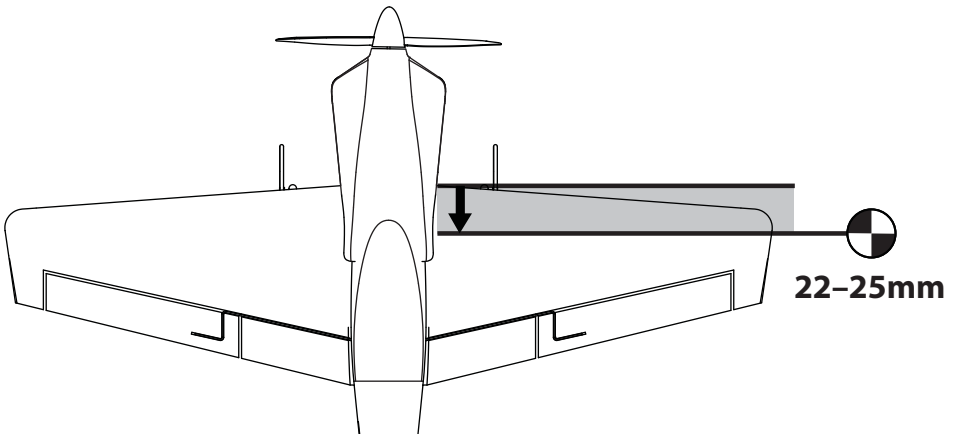

Control Direction Test

Bind your aircraft and transmitter before doing these tests (see Binding). Move the controls on the transmitter to make sure aircraft control surfaces move correctly (Mode 2 shown).

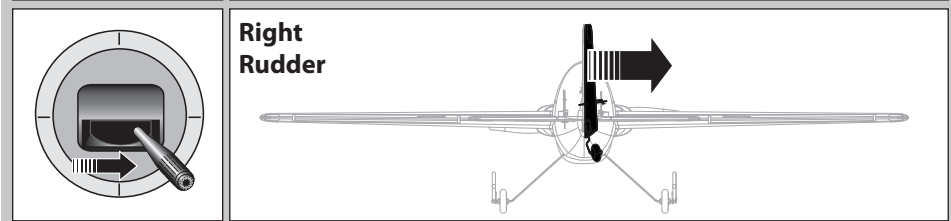
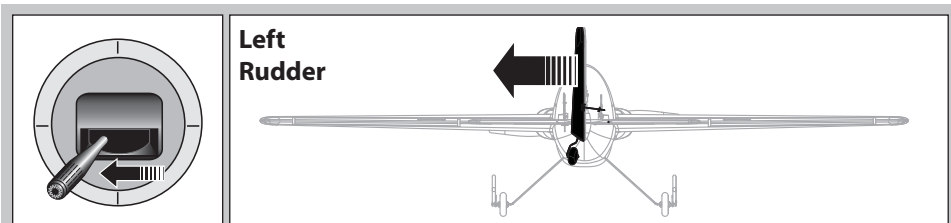
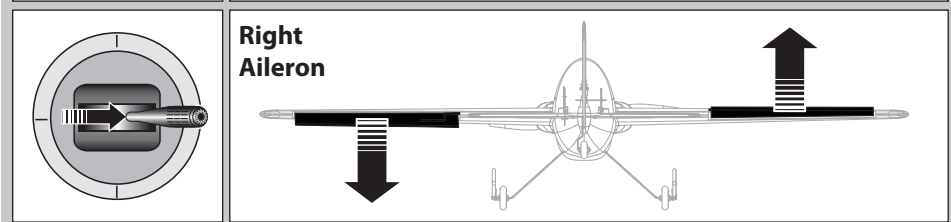
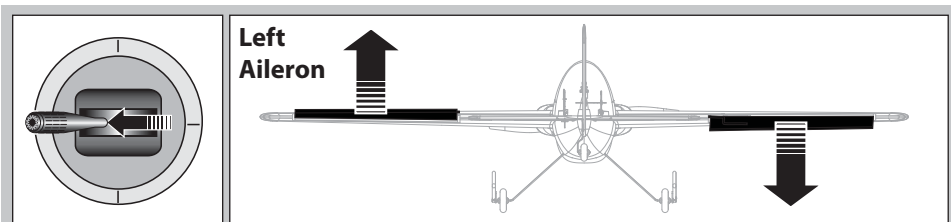
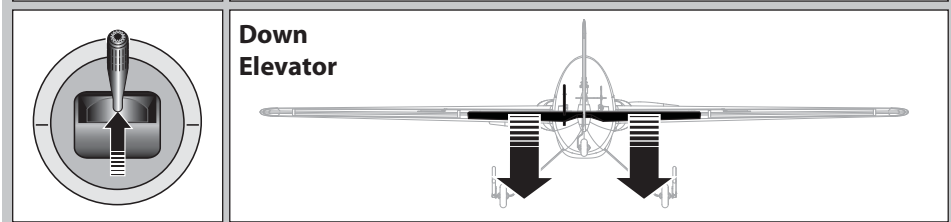
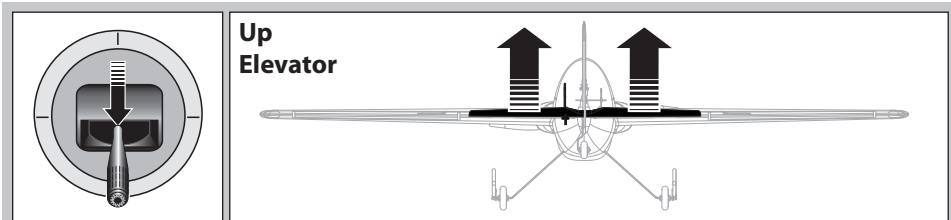

Propeller and Propeller Shaft Maintenance

⚠ CAUTION: Keep hands away from propeller while the flight battery is connected. Personal injury could result.

Disassembly

1. Carefully cut tape and decals on fuselage and turtle deck (top of fuselage behind canopy) and remove top of fuselage.

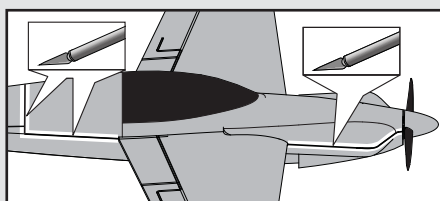

Note: Removing tape or decals will remove paint from the fuselage.

2. Hold the prop shaft using needle-nose pliers or hemostats.
3. Turn propeller counterclockwise (looking from front of model) to remove. Turn propeller clockwise to install.
4. Carefully remove a damaged spinner and glue from propeller.
5. Hold nut on end of prop shaft using needle-nose pliers or hemostats.
6. Turn gear on shaft clockwise (looking from front of model) to remove nut.

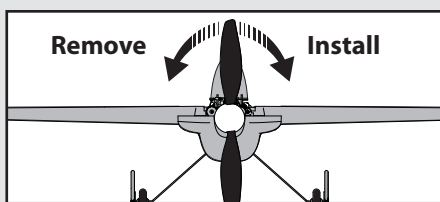

7. Cut a small amount of foam from fuselage before removing prop shaft.
8. Gently pull shaft (A) from gearbox (B) and make sure washer (C) and two bushings (D) are not lost.

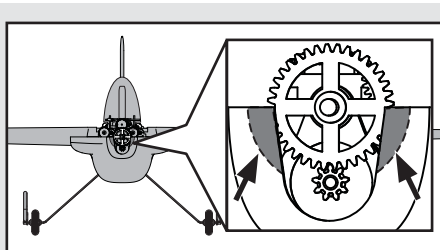

9. Disconnect motor from ESC/receiver.
10. Gently push motor out of gearbox and remove motor through top of fuselage behind the ESC/receiver.

NOTICE: DO NOT remove gearbox from model. Damage to model will result.

Assembly

Assemble model using instructions above, in reverse order.

Note:

- Correctly align prop shaft gear with pinion gear on motor.
- Correctly connect motor to ESC/receiver so that powered motor turns propeller clockwise (looking from front of model).
- Attach spinner to propeller using CA or foam-compatible CA.
- Assemble fuselage using clear tape.

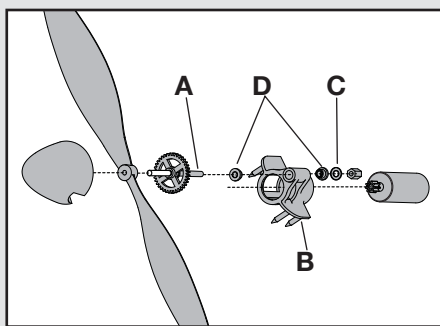

Flying Tips and Repairs

Flying

We recommend only flying your Pole Cat in light winds. Always avoid flying near houses, trees, wires and buildings. You should also be careful to avoid flying in areas where there are many people, such as busy parks, schoolyards or soccer fields. Consult local laws and ordinances before choosing a location to fly your aircraft.

Place the Pole Cat in position for takeoff (facing into the wind if flying outdoors). Gradually increase the throttle to $\frac{3}{4}$ to full, and steer with the rudder. Pull back gently with the elevator and climb to check trim. Once the trim is adjusted, begin exploring the flight envelope of the Pole Cat.

Note: Due to the large propeller on the Pole Cat, it is possible to hit the prop on the ground while landing. Make sure to flare when landing and try to land as smoothly as possible to minimize hitting the prop. While this does not damage the airplane, it is possible to wear down the tips of the propeller if flying from an abrasive surface such as concrete or asphalt.



Failure to lower the throttle stick and trim to the lowest possible position during a crash could result in damage to the ESC in the receiver unit, which may require replacement.

Note: Crash damage is not covered under warranty.

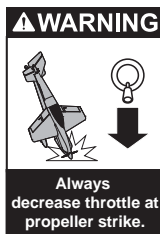

Repairs

Repair the Pole Cat using foam-compatible CA glue or clear tape. Only use foam-compatible CA glue, as other types of glue can damage the foam. When parts are not repairable, see the Replacement Parts List for ordering by item number.

Note: For a listing of all replacement and optional parts, refer to the list at the back of this manual.

NOTICE: Use of foam-compatible CA accelerant on your model can damage paint. DO NOT handle model until accelerant fully dries.

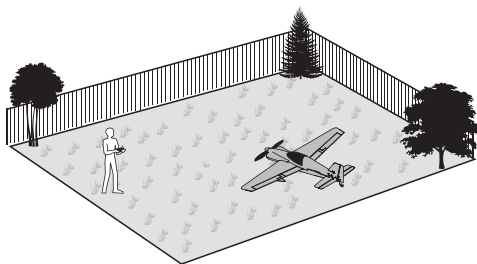

Additional Safety Precautions and Warnings

As the user of this product, you are solely responsible for operating in a manner that does not endanger yourself and others, or result in damage to the product or the property of others.

This model is controlled by a radio signal subject to interference from many sources outside your control. This interference can cause momentary loss of control, so it is advisable to always keep a safe distance in all directions around your model. This margin will help avoid collisions or injury.

- Always keep a safe distance in all directions around your model to avoid collisions or injury.
- Always operate your model in open spaces away from full-size vehicles, traffic and people.

- Always carefully follow the directions and warnings for this and any optional support equipment (chargers, rechargeable battery packs, etc.).
- Always keep all chemicals, small parts and anything electrical out of the reach of children.
- Always avoid water exposure to all equipment not specifically designed and protected for this purpose. Moisture causes damage to electronics.
- Never place any portion of the model in your mouth as it could cause serious injury or even death.
- Never operate your model with low transmitter batteries.

Maintenance After Flying

1. Disconnect flight battery from Receiver/ESC (Required for Safety) Power off transmitter.
2. Remove flight battery from aircraft.
3. Recharge flight battery.
4. Repair or replace all damaged parts.
5. Store flight battery apart from aircraft and monitor the battery charge.
6. Make note of flight conditions and flight plan results, planning for future flights.

Removing and Installing Landing Gear

To Remove:

1. Press together the sides of the landing gear to make the center loop thinner.
2. Pull the landing gear from the fuselage of the model.

To Install:

1. Press together the sides of the landing gear to make the center loop thinner.
2. Push the center loop in the slot in the bottom of the fuselage.
3. Release the landing gear, then pull gently on the landing gear to make sure it is fully installed.

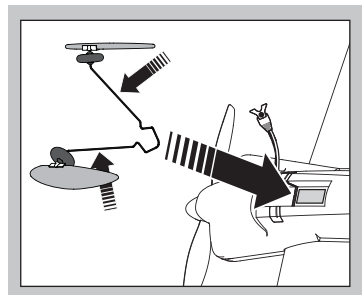
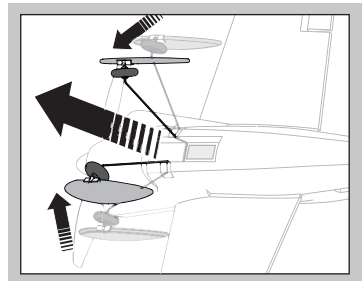

Troubleshooting Guide

Problem	Possible Cause	Solution
Aircraft will not respond to throttle but responds to other controls	Throttle stick and/or throttle trim too high	Reset controls with throttle stick and throttle trim at lowest setting
	Throttle channel is reversed	Reverse throttle channel on transmitter
	Motor unplugged from receiver	Open fuselage and ensure the plug for the motor is properly installed
Extra propeller noise or extra vibration	Damaged propeller, spinner, prop shaft or motor	Replace damaged parts
	Nut on prop shaft is too loose	Tighten the prop shaft nut 1/2 turn
Reduced flight time or aircraft underpowered	Flight battery charge is low	Completely recharge flight battery
	Propeller installed backwards	Install propeller with numbers facing forward
	Flight battery damaged	Replace flight battery and follow flight battery instructions
	Flight conditions may be too cold	Make sure battery is warm before use
	Battery capacity too low for flight conditions	Replace battery or use a larger capacity battery
LED on receiver flashes and aircraft will not bind to transmitter (during binding)	Transmitter too near aircraft during binding process	Power off transmitter, move transmitter a larger distance from aircraft, disconnect and reconnect flight battery to aircraft and follow binding instructions
	Bind switch or button not held while transmitter was powered on	Power off transmitter and repeat bind process
LED on receiver flashes rapidly and aircraft will not respond to transmitter (after binding)	Less than a 5-second wait between first powering on transmitter and connecting flight battery to aircraft	Leaving transmitter on, disconnect and reconnect flight battery to aircraft
	Aircraft bound to different model memory (ModelMatch™ radios only)	Select correct model memory on transmitter and disconnect and reconnect flight battery to aircraft
	Flight battery/transmitter battery charge is too low	Replace/recharge batteries
Control surface does not move	Control surface, control horn, linkage or servo damage	Replace or repair damaged parts and adjust controls
	Wire damaged or connections loose	Do a check of wires and connections; connect or replace as needed
	Flight battery charge is low	Fully recharge flight battery
	Control linkage does not move freely	Make sure control linkage moves freely
Controls reversed	Transmitter settings reversed	Do the Control Direction Test and adjust controls on transmitter appropriately
Motor loses power	Damage to motor, propeller shaft or power components	Do a check of motor, prop shaft and power components for damage (replace as needed)
	Nut on prop shaft is too tight	Loosen prop shaft nut until propeller shaft turns freely
Motor power quickly decreases and increases then motor loses power	Battery power is down to the point of receiver/ESC Low Voltage Cutoff (LVC)	Recharge flight battery or replace battery that is no longer performing
Servo locks or freezes at full travel	Travel adjust value is set above 100% overdriving the servo	Set Travel adjust to 100% or less

Warranty and Repair Policy

Warranty Period

Exclusive Warranty- Horizon Hobby, Inc., (Horizon) warranties that the Products purchased (the "Product") will be free from defects in materials and workmanship at the date of purchase by the Purchaser.

Limited Warranty

Horizon reserves the right to change or modify this warranty without notice and disclaims all other warranties, express or implied.

- (a) This warranty is limited to the original Purchaser ("Purchaser") and is not transferable. REPAIR OR REPLACEMENT AS PROVIDED UNDER THIS WARRANTY IS THE EXCLUSIVE REMEDY OF THE PURCHASER. This warranty covers only those Products purchased from an authorized Horizon dealer. Third party transactions are not covered by this warranty. Proof of purchase is required for all warranty claims.
- (b) Limitations- HORIZON MAKES NO WARRANTY OR REPRESENTATION, EXPRESS OR IMPLIED, ABOUT NON-INFRINGEMENT, MERCHANTABILITY OR FITNESS FOR A PARTICULAR PURPOSE OF THE PRODUCT. THE PURCHASER ACKNOWLEDGES THAT THEY ALONE HAVE DETERMINED THAT THE PRODUCT WILL SUITABLY MEET THE REQUIREMENTS OF THE PURCHASER'S INTENDED USE.
- (c) Purchaser Remedy- Horizon's sole obligation hereunder shall be that Horizon will, at its option, (i) repair or (ii) replace, any Product determined by Horizon to be defective. In the event of a defect, these are the Purchaser's exclusive remedies. Horizon reserves the right to inspect any and all equipment involved in a warranty claim. Repair or replacement decisions are at the sole discretion of Horizon. This warranty does not cover cosmetic damage or damage due to acts of God, accident, misuse, abuse, negligence, commercial use, or modification of or to any part of the Product.

This warranty does not cover damage due to improper installation, operation, maintenance, or attempted repair by anyone other than Horizon. Return of any Product by Purchaser must be approved in writing by Horizon before shipment.

Damage Limits

HORIZON SHALL NOT BE LIABLE FOR SPECIAL, INDIRECT OR CONSEQUENTIAL DAMAGES, LOSS OF PROFITS OR PRODUCTION OR COMMERCIAL LOSS IN ANY WAY CONNECTED WITH THE PRODUCT, WHETHER SUCH CLAIM IS BASED IN CONTRACT, WARRANTY, NEGLIGENCE, OR STRICT LIABILITY. Further, in no event shall the liability of Horizon exceed the individual price of the Product on which liability is asserted. As Horizon has no control over use, setup, final assembly, modification or misuse, no liability shall be assumed nor accepted for any resulting damage or injury. By the act of use, setup or assembly, the user accepts all resulting liability.

If you as the Purchaser or user are not prepared to accept the liability associated with the use of this Product, you are advised to return this Product immediately in new and unused condition to the place of purchase.

Law: These Terms are governed by Illinois law (without regard to conflict of law principals).

Warranty Services

Questions, Assistance, and Repairs

Your local hobby store and/or place of purchase cannot provide warranty support or repair. Once assembly, setup or use of the Product has been started, you must contact Horizon directly. This will enable Horizon to better answer your questions and service you in the event that you may need any assistance. For questions or assistance, please direct your email to product-support@horizonhobby.com, or call 877.504.0233 toll free to speak to a Product Support representative. You may also find information on our website at www.horizonhobby.com.

Inspection or Repairs

If this Product needs to be inspected or repaired, please use the Horizon Online Repair Request submission process found on our website or call Horizon to obtain a Return Merchandise Authorization (RMA) number. Pack the Product securely using a shipping carton. Please note that original boxes may be included, but are not designed to withstand the rigors of shipping without additional protection. Ship via a carrier that provides tracking and insurance for lost or damaged parcels, as Horizon is not responsible for merchandise until it arrives and is accepted at our facility. An Online Repair Request is available at www.horizonhobby.com under the Repairs tab. If you do not have internet access, please contact Horizon Product Support to obtain a RMA number along with instructions for submitting your product for repair. When calling Horizon, you will be asked to provide your complete name, street address, email address and phone number where you can be reached during business hours. When sending product into Horizon, please include your RMA number, a list of the included items, and a brief summary of the problem. A copy of your original sales receipt must be included for warranty consideration. Be sure your name, address, and RMA number are clearly written on the outside of the shipping carton.

Notice: Do not ship batteries to Horizon. If you have any issue with a battery, please contact the appropriate Horizon Product Support office.

Warranty Inspection and Repairs

To receive warranty service, you must include your original sales receipt verifying the proof-of-purchase date. Provided warranty conditions have been met, your Product will be repaired or replaced free of charge. Repair or replacement decisions are at the sole discretion of Horizon Hobby.

Non-Warranty Repairs

Should your repair not be covered by warranty the repair will be completed and payment will be required without notification or estimate of the expense unless the expense exceeds 50% of the retail purchase cost. By submitting the item for repair you are agreeing to payment of the repair without notification. Repair estimates are available upon request. You must include this request with your repair. Non-warranty repair estimates will be billed a minimum of 1/2 hour of labor. In addition you will be billed for return freight. Horizon accepts money orders and cashiers checks, as well as Visa, MasterCard, American Express, and Discover cards. By submitting any item to Horizon for inspection or repair, you are agreeing to Horizon's Terms and Conditions found on our website under the Repairs tab.

Warranty and Service Information

Country of Purchase	Horizon Hobby	Address	Phone Number/Email Address
United States of America	Horizon Service Center (Electronics and engines)	4105 Fieldstone Rd Champaign, Illinois 61822 USA	877-504-0233 For an Online Repair Request visit: www.horizonhobby.com/repairs
	Horizon Product Support (All other products)	4105 Fieldstone Rd Champaign, Illinois 61822 USA	877-504-0233 productsupport@horizonhobby.com
United Kingdom	Horizon Hobby Limited	Units 1-4 Ployters Rd Staple Tye Harlow, Essex CM18 7NS United Kingdom	+44 (0) 1279 641 097 sales@horizonhobby.co.uk
Germany	Horizon Technischer Service	Hamburger Str. 10 25335 Elmshorn, Germany	+49 4121 46199 66 service@horizonhobby.de
France	Horizon Hobby SAS	14 Rue Gustave Eiffel Zone d'Activité du Réveil Matin 91230 Montgeron	+33 (0) 1 60 47 44 70 infofrance@horizonhobby.com

Compliance Information for the European Union

Declaration of Conformity

(in accordance with ISO/IEC 17050-1)
No. HH2011052704

Product(s): PKZ Ultra Micro Pole Cat BNF
Item Number(s): PKZU1480
Equipment class: 1

The object of declaration described above is in conformity with the requirements of the specifications listed below, following the provisions of the European R&TTE directive 1999/5/EC and EMC Directive 2004/108/EC

EN 301 489-1 V1.7.1: 2006
EN 301 489-17 V1.3.2: 2008

EN55022: 2006,
EN55024: 1998+A1: 2001+A2: 2003
(EN61000-4-2: 2001, EN61000-4-3: 2006, EN61000-4-8: 2001)



Signed for and on behalf of:
Horizon Hobby, Inc.
Champaign, IL USA
May 27, 2011

Steven A. Hall
Vice President
International Operations and Risk Management
Horizon Hobby, Inc.

Instructions for disposal of WEEE by users in the European Union



This product must not be disposed of with other waste. Instead, it is the user's responsibility to dispose of their waste equipment by handing it over to a designated collections point for the recycling of waste electrical and electronic equipment. The separate collection and recycling of your waste equipment at the time of disposal will help to conserve natural resources and ensure that it is recycled in a manner that protects human health and the environment. For more information about where you can drop off your waste equipment for recycling, please contact your local city office, your household waste disposal service or where you purchased the product.

Parts Contact Information • Kontaktinformationen für Ersatzteil • Coordonnées (pièces) • Recapiti dei distributori

Country of Purchase	Horizon Hobby	Address	Phone Number/Email Address
United States	Sales	4105 Fieldstone Rd Champaign, Illinois, 61822 USA	800-338-4639 sales@horizonhobby.com
United Kingdom	Horizon Hobby Limited	Units 1-4 Ployters Rd Staple Tye Harlow, Essex CM18 7NS, United Kingdom	+44 (0) 1279 641 097 sales@horizonhobby.co.uk
Germany	Horizon Hobby GmbH	Hamburger Str. 10 25335 Elmshorn, Germany	+49 4121 46199 60 service@horizonhobby.de
France	Horizon Hobby SAS	14 Rue Gustave Eiffel Zone d'Activité du Réveil Matin 91230 Montgeron	+33 (0) 1 60 47 44 70 infofrance@horizonhobby.com

Replacement Parts • Ersatzteile • Pièces de rechange • Pezzi di ricambio

Part # • Nummer Numéro • Codice	Description	Beschreibung	Description	Descrizione
PKZU1402	Decal Sheet: Ultra Micro Pole Cat	Dekorbogen: Ultra Micro Pole Cat	Planche de décalcomanies : Ultra Micro Pole Cat	Foglio con decalcomanie: Ultra Micro Pole Cat
PKZU1403	Landing Gear: Ultra Micro Pole Cat	Fahrgestell: Ultra Micro Pole Cat	Train d'atterrissage : Ultra Micro Pole Cat	Carrello di atterraggio: Ultra Micro Pole Cat
PKZU1407	Tail Wheel: Ultra Micro Pole Cat	Heckrad: Ultra Micro Pole Cat	Roulette de queue : Ultra Micro Pole Cat	Ruotino di coda: Ultra Micro Pole Cat
PKZU1408	Spinner (3): Ultra Micro Pole Cat	Spinner (3): Ultra Micro Pole Cat	Cône d'hélice (3) : Ultra Micro Pole Cat	Spinner (3): Ultra Micro Pole Cat
PKZU1420	Main Wing: Ultra Micro Pole Cat	Hauptflügel: Ultra Micro Pole Cat	Aile principale : Ultra Micro Pole Cat	Ala Principale: Ultra Micro Pole Cat
PKZU1422	Aileron Pushrod Linkage: UM Pole Cat	Querrudergestänge: UM Pole Cat	Liaison de biellette d'aileron : UM Pole Cat	Asta di spinta e leveraggi dell'alettone: UM Pole Cat
PKZU1425	Complete Tail w/ Accessories: UM Pole Cat	Vollständiges Leitwerk mit Zubehörteilen: UM Pole Cat	Queue complète avec accessoires : UM Pole Cat	Coda completa di accessori: UM Pole Cat
PKZU1426	Pushrod Set: Ultra Micro Pole Cat	Schubstangensatz: Ultra Micro Pole Cat	Jeu de biellettes mécaniques : Ultra Micro Pole Cat	Set asta di spinta: Ultra Micro Pole Cat
PKZU1467	Fuselage: Ultra Micro Pole Cat	Flugzeugrumpf: Ultra Micro Pole Cat	Fuselage : Ultra Micro Pole Cat	Fusoliera: Ultra Micro Pole Cat
HBZ4929	Gearbox (No Motor): Champ, UM T28, Corsair	Getriebe (ohne Mo- tor): Champ, UM T28, Corsair	Réducteur (sans moteur) : Champ, UM T28, Corsair	Riduttore (senza motore): Champ, UM T28, Corsair
PKZ3528	Propeller Shaft: Sukhoi Su-26m, Micro P-51	Propellerwelle: Sukhoi Su-26m, Micro P-51	Arbre d'hélice : Sukhoi Su-26m, Micro P-51	Albero dell'elica: Sukhoi Su-26m, Micro P-51
EFL9052	Motor: UMX 4site/ Extra 300 3D	Motor: UMX 4site/ Extra 300 3D	Moteur: UMX 4site/ Extra 300 3D	Motore UMX 4site/ Extra 300 3D
EFLC1000	AC/DC 3.7V Li-Po Charger	AC/DC-3,7V-Li-Po- Ladegerät	Chargeur Li-Po CA/DC 3,7V	Caricabatterie Li-Po CA/CC da 3,7V
EFLB1501S	1S 3.7V 150mAh Li-Po Battery	1S-3,7V-150mAh-Li- Po-Akku	Batterie Li-Po 150 mAh 3,7V 1S	Batteria Li-Po 1S da 3,7V, 150 mAh
EFLH1067	Replacement Servo Retaining Collars	Ersatzsicherung für Servo	Bagues de maintien de servo de rechange	Collarini di fissaggio del servo di ricambio
EFLH1066	Replacement Servo Mechanics: Short Throw	Ersatzeinheit Servo- mechanik: kleiner Ausschlag	Pièces de rechange mécaniques servo : course courte	Servo di ricambio Meccanica: corta Escursione

Part # • Nummer Numéro • Codice	Description	Beschreibung	Description	Descrizione
EFL9051	Prop and Spinner 130 x 70 (2): UM 4-Site/Champ	Propeller und Spinner 130 x 70 (2): UM 4-Site/Champ	Hélice et cône d'hélice 130 x 70 (2) : UM 4-Site/Champ	Elica e ogiva 130 x 70 (2): UM 4-Site/Champ
EFL9054	Prop Shaft with Gear (2): UMX 4Site	Propellerwelle mit Zahnrad (2): UMX 4Site	Arbre d'hélice avec réducteur (2):UMX 4Site	Albero dell'elica con riduttore (2): UMX 4Site
SPMAR6400	AR6400 DSM2 6-Channel Ultra Micro Receiver/ESC	AR6400-DSM2-6- Kanal Ultra-Mikro- Empfänger/ESC	Récepteur/ESC DSM2 AR6400 6 voies Ultra Micro	Ricevitore/ESC AR6400 a 6 canali Ultra Micro DSM2
SPMAS2000L	1.7 gLinear Long Throw Servo	1,7 g-Linearservo mit großem Ausschlag	Servo linéaire course longue 1,7 g	Servo lineare a corsa lunga da 1,7 g
SPM6832	Replacement Servo Mechanics: Ultra Micro Long Throw	Ersatz-Servomechanik: Ultra Micro mit großem Ausschlag	Pièces de rechange mécaniques servo : Ultra Micro course longue	Componenti meccanici di rimpambio del servo: corsa lunga Ultra Micro

Optional Parts and Accessories • Optionale Bauteile und Zubehör • Pièces et accessoires optionnels • Componenti e accessori opzionali

Part # Nummer Numéro Codice	Description	Beschreibung	Description	Descrizione
EFLC1004	Celectra 4-Port 1S 3.7V 0.3 A DC Li-Po Charger	Celectra-1S-3,7V-0,3A- DC-Li-Po-Ladegerät mit 4 Anschlüssen	Chargeur Li-Po CC 0,3 A 3, 7V 1S 4 ports Celectra	Caricabatterie Li-Po 1S da 3,7V 0,3 A CC, a 4 porte, Celectra
EFLC1005	AC to 6V DC 1.5 amp Power Supply	Netzteil 6V 1,5 A	Alimentation CA vers 6V CC, 1,5 A	Alimentatore CA - 6V CC da 1,5 A
EFLC1005AU	AC to 6V DC 1.5 amp Power Supply, AU	Netzteil 6V 1,5 A Australien	Alimentation CA vers 6V CC, 1,5 A AU	CA - 6V CC, 1,5 A Alimentatore, AU
EFLC1005EU	AC to 6V DC 1.5-amp Power Supply, Int'l	Netzteil 6V 1,5 A EU	Alimentation CA vers 6V CC, 1,5 A International	CA - 6V CC, 1,5 A Alimentatore, Int'l
EFLC1005UK	AC to 6V DC 1.5-amp Power Supply, United Kingdom	Netzteil 6V 1,5 A Großbritannien	Alimentation CA vers 6V CC, 1,5 A Royaume-Uni	CA - 6V CC, 1,5 A Alimentatore, Regno Unito
SPMR6610	DX6i Transmitter Only Mode 2	DX6i-Sender (nur Sender) Mode 2	Émetteur DX6i uniquement Mode 2	Solo trasmettitore DX6i Modalità 2
SPMR66101	DX6i Transmitter Only Mode 1	DX6i-Sender (nur Sender) Mode 1	Émetteur DX6i uniquement Mode 1	Solo trasmettitore DX6i Modalità 1
SPMR6610E	DX6i Transmitter Only Mode 2 Int'l	DX6i-Sender (nur Sender) Mode 2 international	Émetteur DX6i uniquement Mode 2 International	Solo trasmettitore DX6i Modalità 2 Int'l
SPMR66101E	DX6i Transmitter Only Mode 1 Int'l	DX6i-Sender (nur Sender) Mode 1 international	Émetteur DX6i uniquement Mode 1 International	Solo trasmettitore DX6i Modalità 1 Int'l
*SPMR8800	DX8 Transmitter Only Mode 2	DX8-Sender (nur Sender) Mode 2	Émetteur DX8 uniquement Mode 2	Solo trasmettitore DX8 Modalità 2
*SPMR8800EU	DX8 Transmitter Only Mode 2 Int'l	DX8-Sender (nur Sender) Mode 2 international	Émetteur DX8 uniquement Mode 2 International	Solo trasmettitore DX8 Modalità 2 Int'l
*SPMR88001AU	DX8 Transmitter Only Mode 1 AU	DX8-Sender (nur Sender) Mode 1 Australien	Émetteur DX8 uniquement Mode 1 AU	Solo trasmettitore DX8 Modalità 1 AU
*SPMR88001EU	DX8 Transmitter Only Mode 1 Int'l	DX8-Sender (nur Sender) Mode 1 international	Émetteur DX8 uniquement Mode 1 International	Solo trasmettitore DX8 Modalità 1 Int'l

***Note:** All Spektrum DX8 transmitters can be set-up for modes 1–4.

***Hinweis:** Alle Spektrum-DX8-Sender können für Mode 1 bis 4 eingerichtet werden.

***Remarque :** tous les émetteurs DX8 Spektrum peuvent être réglés pour les modes 1 à 4

***Nota:** tutti i trasmettitori Spektrum DX8 possono essere impostati nelle modalità 1-4.

© 2011 Horizon Hobby, Inc.

The Spektrum trademark is used with permission of Bachmann Industries, Inc.
ParkZone, E-flite, JR, Celectra, DSM, ModelMatch
are trademarks or registered trademarks of Horizon Hobby, Inc.
Futaba is a registered trademark of Futaba Denshi Kogyo Kabushiki Kaisha Corporation of Japan.

US D578,146. PRC ZL 200720069025.2. US 7,898,130 Other patents pending.

www.parkzone.com

Created 05/11 29101



parkzone