

**THIS MODEL IS NOT A TOY!**

# INSTRUCTION MANUAL

THESE INSTRUCTIONS SHOULD BE READ BY A SUPERVISING ADULT

## 2.4GHz RTR CARIBBEAN V2 SAILING YACHT

Model No:8802

### IMPORTANT :

1. This is not a toy. Assembly and operating of this boat requires adult supervision.
2. Please take time to read the instructions carefully and completely before attempting to operate your model. This manual contains the instructions you need to safely build, operate and maintain your R/C sailboat.

### CONTENTS OF SET



2.4GHz 2CH Digital Proportional Transmitter



Caribbean Sailing Yacht  
With Display Stand



CROSS-HEAD SCREWDRIVER - 1PC  
(NOT INCLUDED)

### IMPORTANT TIPS

Jib boom and main boom are installed with silicone O rings. Adjust rings position on booms so as to adjust jib sail and main sail closing and opening angle easily.

### ITEMS REQUIRED FOR COMPLETION

- 4 x "AA" alkaline batteries for transmitter
- 3 x "AAA" alkaline batteries for receiver

### SPARE PART LIST

To order Caribbean spare parts, use the part numbers in the spare parts list that follows.

PART NO.	DESCRIPTION
88001A	main sail and jib sail(red color)
88003	stainless Steel rigging and hook
88004	rudder set
88010	2.4GHz Receiver
88011	2.4GHz 2CH Transmitter
88012	9g servo
88015	Booms and mast set
880201	Keel
880202	Deck-2014 version

## BASIC BOAT TERMINOLOGY

**BOW:** The front of the boat.

**STERN:** The back of the boat.

**PORT:** This is the left side of the boat when view the boat from the stern. An easy way to remember this is that port and left both contain four letters.

**STARBOARD:** This is the right side of the boat when view the boat from the stern.

**HULL:** The body of the boat.

**DECK:** The top of the boat.

**KEEL:** A weighted blade that protrudes from the bottom of the hull as a means of providing lateral stability.

**RUDDER:** The hinged vertical plate mounted at the stern that controls steering.

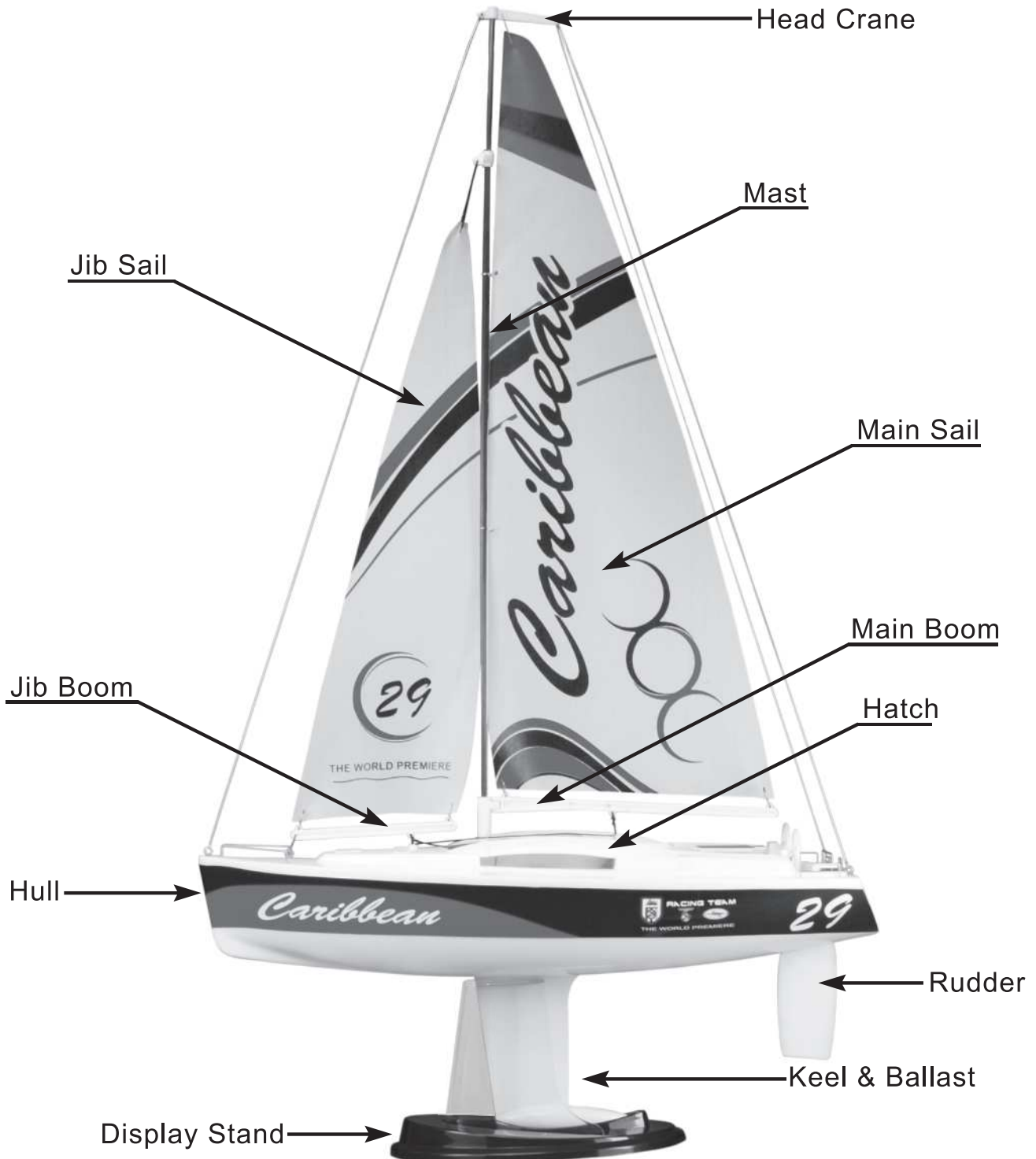

## GETTING CARIBBEAN OUT FROM BOX

### IMPORTANT NOTICE:

Caribbean is secured with screws on the display stand, as well as the display stand is secured with screws on the boat box. Please follow the instructions and carefully loose these screws, so that you could get Caribbean out from box.

1. Use cross-head screwdriver to remove three pcs of screws underneath the boat box as shown. Now you could take out Caribbean and display stand from boat box.
2. Use screwdriver to remove two pcs of screws underneath the display stand, In this process, it is suggested that hold the hull with one hand, otherwise, Caribbean might fall off during removing the screws without care. Remove the ballast plastic cover, now you can take Caribbean out from the display stand.

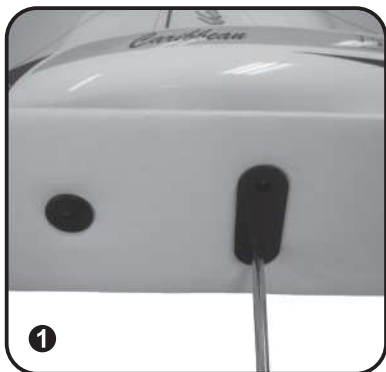

## INSTALL 4 PCS "AA" ALKALINE BATTERIES IN YOUR TRANSMITTER

Install two control sticks before installing 4 pcs "AA" batteries.

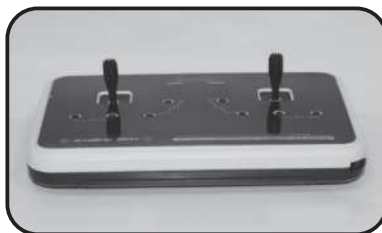
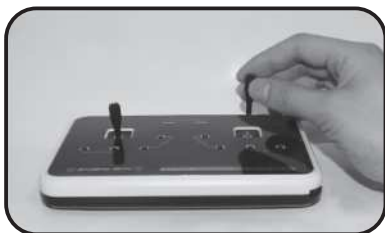

Always use fresh AA alkaline battery in the transmitter.

1. Ensure transmitter "POWER" switch is in the off position.
2. Slide off the battery door on the back of the transmitter.
3. Install 4 fresh "AA" alkaline batteries into the transmitter in the configuration molded into the battery compartment.  
Noting correct location (polarity + or -)
4. Re-install the battery door onto the back of the transmitter.
5. Before switch on transmitter, Push down the throttle stick (Left Stick) till the end as shown.

**IMPORTANT NOTE:** It is very important that keep the throttle stick at its lowest position before switch on transmitter. So that when you install batteries for receiver, the radio and boat will be activated only throttle stick at its lowest position.

6. Switch "POWER" on, green indicator light is on. Otherwise, check the above processes again to reinstall batteries.

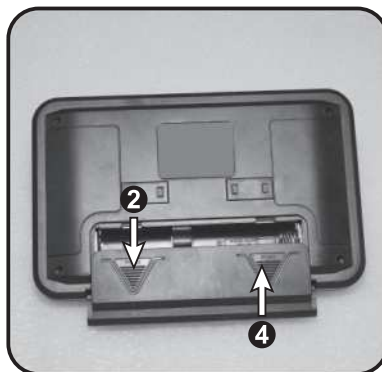
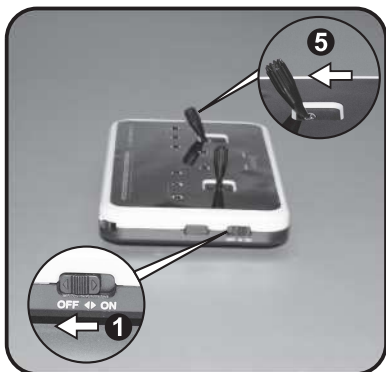

## INSTALL 3 PCS "AAA" ALKALINE BATTERIES IN CARIBBEAN

**IMPORTANT NOTE:** Always switch on the transmitter before switch on the receiver and always switch off the receiver before switch off the transmitter.

1. Rotate the decorative table on hatch either left or right to unlock the hatch with hull.
2. Lift up the rear part of hatch by holding the table on the hatch. Do not hold the two decorative steering wheel, Or they may be damaged.
3. Holding the front part of the hatch with two hand on both side, carefully pull up a little bit, then you could easily remove the hatch by pulling.
4. Install 3 pcs of "AAA" alkaline batteries on the receiver battery box, notice the correct polarity.
5. Push down the throttle stick (Left Stick) till the end on transmitter, then switch on transmitter power.
6. Switch on receiver battery box. Observe the receiver green light is solid green, if it was solid red, you need to bind the transmitter with receiver, detail information is given in next step.
7. After make sure receiver green light is solid on, boat's steering servo and sailing servo are operated correspondingly to radio control, replace the hatch, take care to firstly re-position the front part of hatch, then press down the rear part of hatch, rotate the decorative table as photo shown to lock hatch with hull.

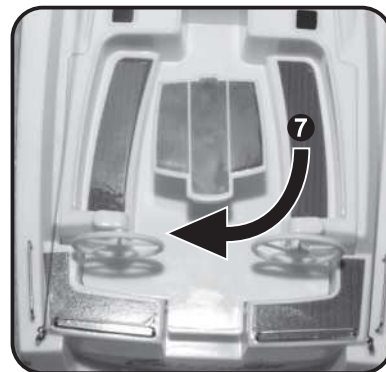
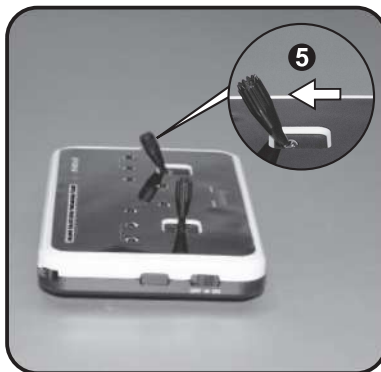
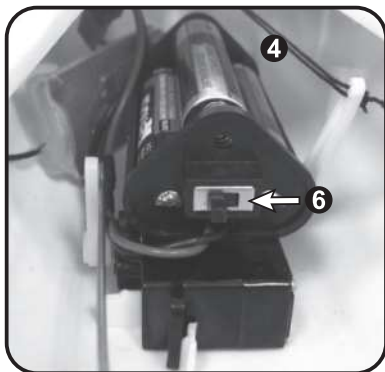
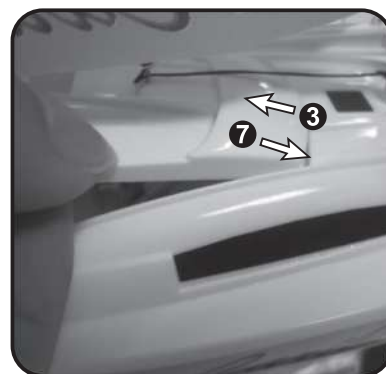
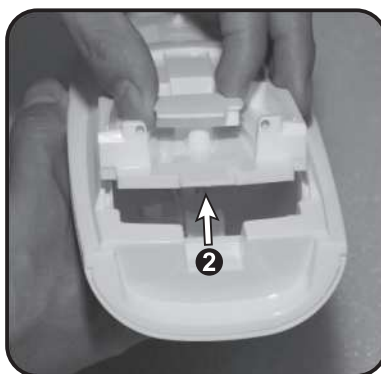
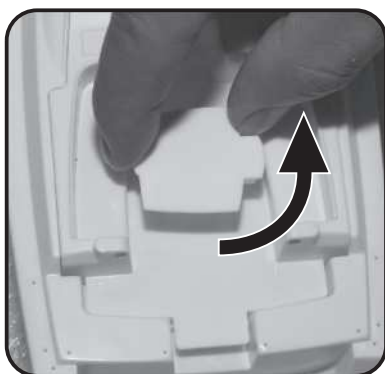

## TRANSMITTER & RECEIVER BINDING

The binding process effectively ties the transmitter and receiver together. Under normal circumstances, both items are supplied like this from the factory. If, however, you find that your transmitter and receiver are not bound (receiver's red LED will turn on), you should do the following:

1. Make sure throttle stick (Left Stick) is pushed down till the end, switch on transmitter.
2. Switch on receiver after receiver battery box is installed with 3 pcs of AAA alkaline batteries in correct polarity.
3. Carefully pull out the receiver unit which is hidden inside the front part of hull.
4. Press down the "BIND" button on the receiver, the receiver's GREEN light will turn on to indicate that binding has been successful and the receiver will now accept commands from the transmitter.
5. After binding completed, carefully push the receiver unit forward and place it in good position inside the front part of hull as shown. Make sure receiver antenna head is hidden inside the front of hull, don't let antenna head get close to batteries.

**Note:** During binding process, transmitter and receiver should be no more than one meter apart and no other similar devices should be within 10 meters.

If the receiver's GREEN light is flashing, indicating a binding failure, Please repeat the binding process above

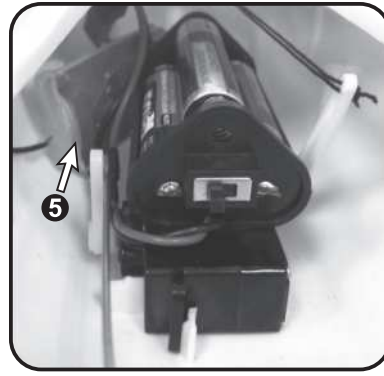
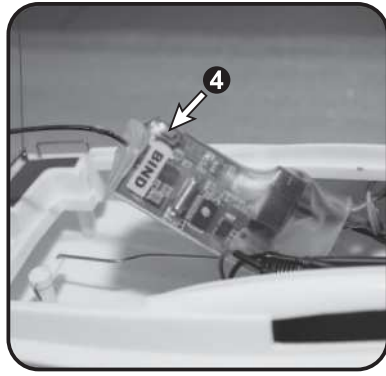

## PREPARATIONS FOR SAILING

Before sailing your Caribbean for the first time, Always switch on the transmitter before switch on the receiver and always switch off the receiver before switch off the transmitter.

Following the procedures to check the radio and sailboat's function:

1. Caribbean is supplied with 2.4GHz 2CH radio system. Please see following function of the transmitter.
2. For sail control stick, when stick is in the position of A, correspondingly, the main boom and jib boom are in the position of A as shown. When stick is in the position of B, correspondingly, the main boom and jib boom are in the position of B as shown.
3. You may also adjust the sail servo neutral by pressing the sail neutral position trim button up or down.
4. For rudder control stick, rudder turn left when rudder control stick is pushed to the left. Rudder turn right when rudder control stick is pushed to the right.
5. You may also adjust the rudder servo neutral by pressing the rudder neutral position trim button left or right.

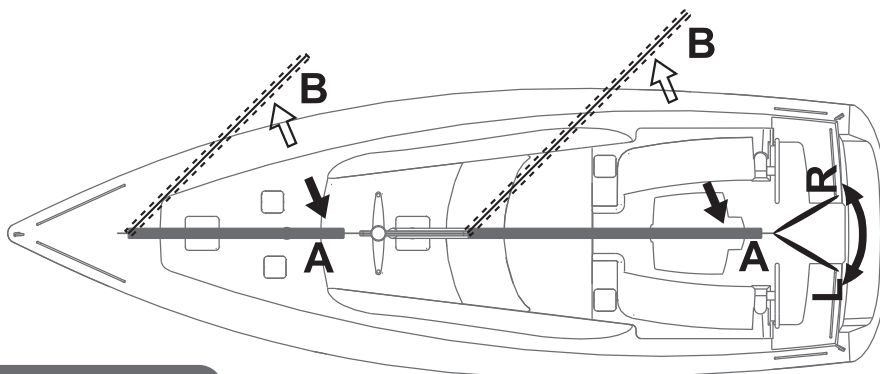
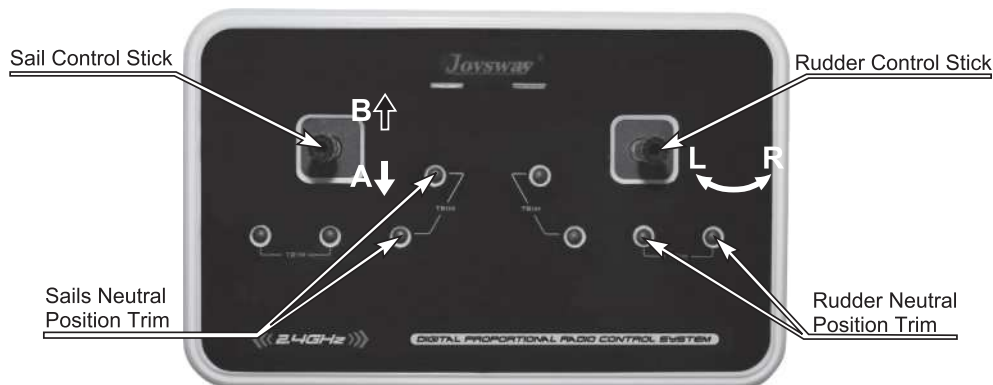

## SAILING THE CARIBBEAN

Unlike propeller driven boats that you basically point and accelerate, sailboats present an interesting challenge. Sailing requires constant reaction to water movements, any wind gusts, and any wind direction changes. These reactions then require adjustment of the rudder and sails in order to find the best possible course. There is no substitute for actual "on-the-water" experience and after your first couple of outings you may want to read through this manual again in order to help you to gain a better understanding of the "art" of sailing. While learning to sail, it is a good idea to pick up on as much sailing terminology as possible. This will make it easier to grasp some aspects.



# How To Sail Caribbean

Wind



**Wind Abeam**  
Sails: Each at a position of 45°  
Rudder: In center position

**Quarter Lee**  
Sails: Letting both out a little more  
Rudder: to the left

**Bearing Away**  
Sails: Let both out so as not to shiver  
Rudder: To the left

**Starboard Tack-Running**  
Sails: Letting both out to their maximum position  
Rudder: in center position

**Port Tack – Close – Hauled**  
Sails: Keeping pulled in  
Rudder: To be held at the center as long as the sails do not shiver

**Tacking**  
Sails: Keeping pulled in  
Rudder: To the left

**Port Tack-Running**  
Sails: Letting both out to their maximum position  
Rudder: in center position

**Tacking**  
Sails: Keeping pulled in  
Rudder: To the right

**Starboard Tack – Close – Hauled**  
Sails: Keeping pulled in  
Rudder: To be held at the center as long as the sails do not shiver

**Quarter Lee**  
Sails: Pulling both in a little  
Rudder: In center position

**Tacking**  
Sails: Keep pulled in  
Rudder: To the left

**Luffing Up**  
Sails: Pulling in bit by bit  
Rudder: To the left

**START Wind Abeam**  
Sails: Each at a position of 45°  
Rudder: In center position

**Luffing Up**  
Sails: Pulling both in all the way  
Rudder: To the left

**Port Tack – Close – Hauled**  
Sails: Keep pulling in  
Rudder: To be held at the center as long as the sails do not shiver

## IMPORTANT NOTICE:

1. Sail your Caribbean only in still bodies of water. Never sail your boat in running water such as streams or rivers, as it is easy to lose control of your boat.
2. Do not sail Caribbean in heavy winds.
3. Never attempt to swim after a stalled or stuck boat! Wait patiently for the wind currents to return the boat to shore.
4. After running, remove the deck and allow the interior of the boat to dry out completely. If you neglect to do this, it may result in corrosion of the electronic components.



## FCC REQUIREMENT



This device complies with Part 15 of the FCC Rules. Operation is subject to the following two conditions: (1) This device may not cause harmful interference, and (2) This device must accept any interference received, including interference that may cause undesired operation.

**CAUTION:** Changes or modifications to this product not expressly approved by the party responsible for compliance may void the user's authority to operate the equipment.